

1 2 3 4 5 6 7 8

RevNo	Date	Signature	Checked

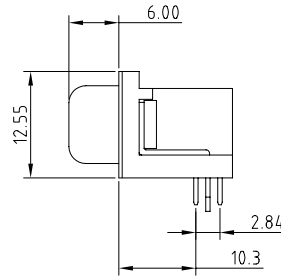
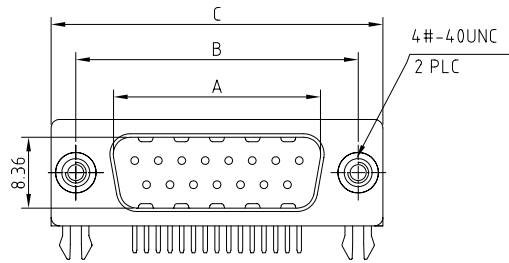

1 0 3 X X M X X X - - - 4 - L F

D-Sub 90D							
Typ							
09							Vacant:No Screw
15	Male						S:4.8
25							L:5.8
37	8.Nickel						Vacant:No Accessories
	9.Tin						V0.Coalescent Nut H=5.8
	11.Gold						V. Lock Screw.
							VI. With Screw.
							VII.Additional Screw.
1.White							Vacant :Default 1u'
3 Black							3. 3u'
4. Yellow							5. 5u'
6 Green							6. 10u'
9 Blue							7. 15u'
10. PC99	1 Full						8. 30u'

Note:

No.	A	B	C
09	16.92	24.99	30.81
15	25.25	33.32	39.14
25	38.96	47.04	53.04
37	55.42	63.50	69.32

ELECTRICAL CHARACTERISTICS

Contact Current Rating:3Amperes.
 Dielectric Withstanding Voltage:AC 500V at sea level.
 Insulation Resistance:1000Megohms Min.
 Contact Resistance:30Milliohms Max.
 Operation Temperature : -55°C to +105°C.

Material

Contact :Copper Alloy.
 Insulator:PBT. (UL94-V0)
 Shell: SPCC.
 Z-Piece: Copper Alloy.
 Screw: Copper Alloy.
 Rivet: Copper Alloy. or Zinc.

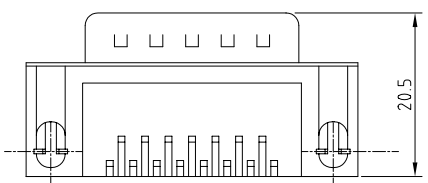

Recommend PCB Layout

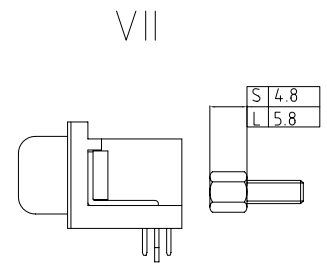
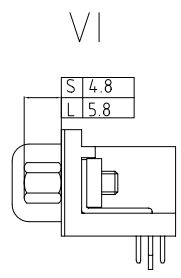
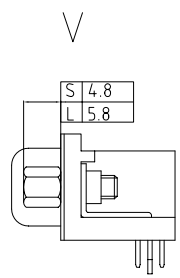
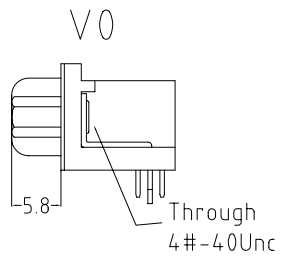
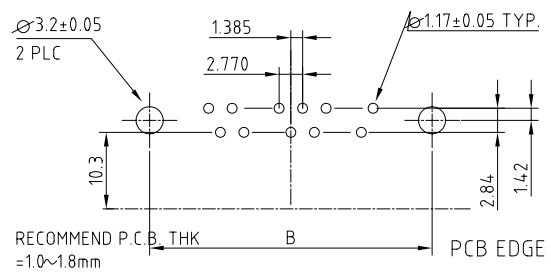

DRAW.BY	LinHaiFong	DATE	2005-10-10	UNIT	MM	TOLERANCE	X ±0.30 XX ±0.25 XXX ±0.150	Ang. ±2°
APPVL.BY		VERSION	A	SCALE		DWG.No.	F:/XX/ / +	

Chin Shong
 Enterprise CO., LTD.

ITEM	D-SUB Male 90D-DIP /9.4
PART No.	
CUSTOMER	

1 2 3 4 5 6 7 8