

Top View of Assembly

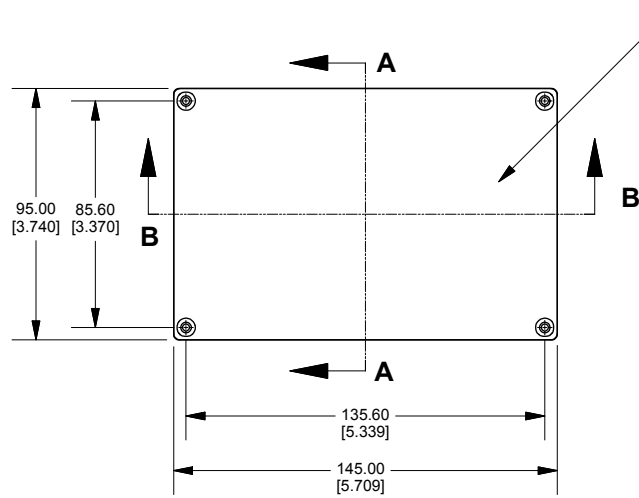

SECTION A-A End View of Assembly

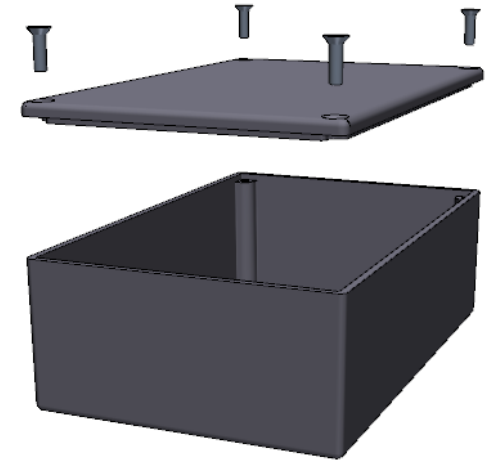
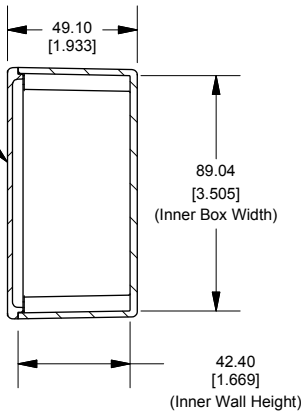

SECTION B-B Side View of Assembly

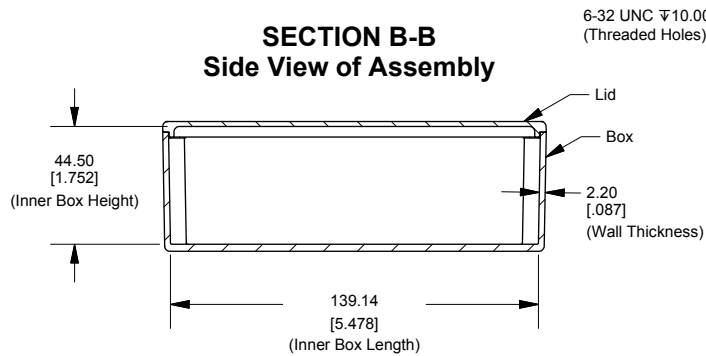

Top View Looking Inside Box

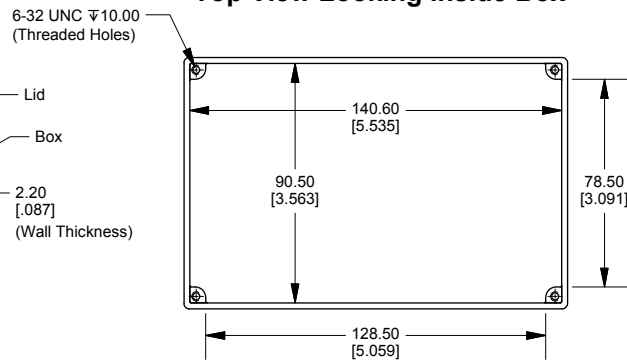

Lid

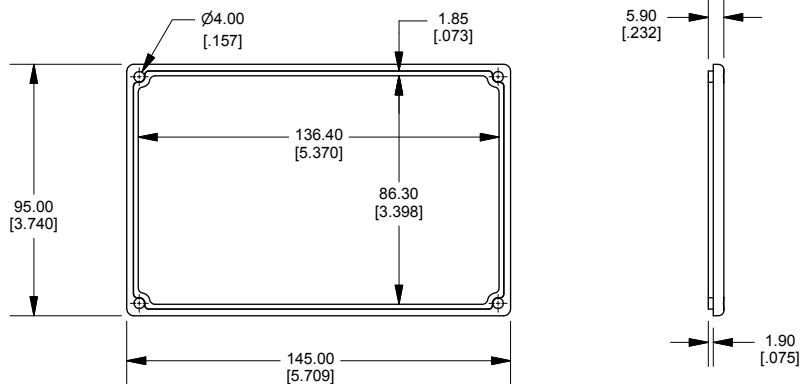

Enclosures can be Factory Modified (Milling, Drilling, Printing etc.)
 Contact Factory mjm@hammondmfg.com for quotes
 Solid models of this enclosure available in STEP or IGES.

NOTE	
Purchased assembly includes box, lid and 4 cover screws. Box and lid are made from Diecast Aluminum Alloy. Silicone Gasket supplied with liquid resistant enclosure.	
PART NUMBERS	
1590J Enclosure	
Natural Finish Enclosure	1590J
Black Textured Enclosure	1590JBK
1590J Liquid Resistant Enclosure (Silicone Gasket)	
Natural Finish Enclosure	1590W J
Black Textured Enclosure	1590WJBK
ACCESSORIES	
Recommended Torque: 75 ozf.in / 55 cN.m	
Liquid Resistant Cover Screws	
Stainless Steel Cover Screws (Pkg 100)	
[6-32 x 1/2" With O-Ring]	1590W MS100
Black Stainless Steel Cover Screws (Pkg 100)	
[6-32 x 1/2" With O-Ring]	1590W MS100BK
Standard Cover Screws	
Plated Cover Screws (Pkg 100)	
[6-32 x 1/2"]	1590MS 100
Black Cover Screws (Pkg 100)	
[6-32 x 1/2"]	1590MS100BK

1590J

www.hammondmfg.com

Dimensions:
mm
[inches]