

© COPYRIGHT 1997 BY SPC TECHNOLOGY. ALL RIGHTS RESERVED. NO PORTION OF THIS PUBLICATION, WHETHER IN WHOLE OR IN PART CAN BE REPRODUCED WITHOUT THE EXPRESS WRITTEN CONSENT OF SPC TECHNOLOGY.

REVISIONS				DOC. NO. SPC-F004, Total Pages: 2 Effective: 7/15/97. DCP No: 229 Supersedes DCP No: 103					
DCP #	REV	DESCRIPTION	DRAWN	DATE	CHECKD	DATE	APPRVD	DATE	
136	A	Released	J.W.M.	12/22/97	J.C.	1/12/98	B.B.	1/12/98	
763	B	Redrawn Bulk Parts added	JWM	5/8/01	JC	5/8/01	JC	5/8/01	

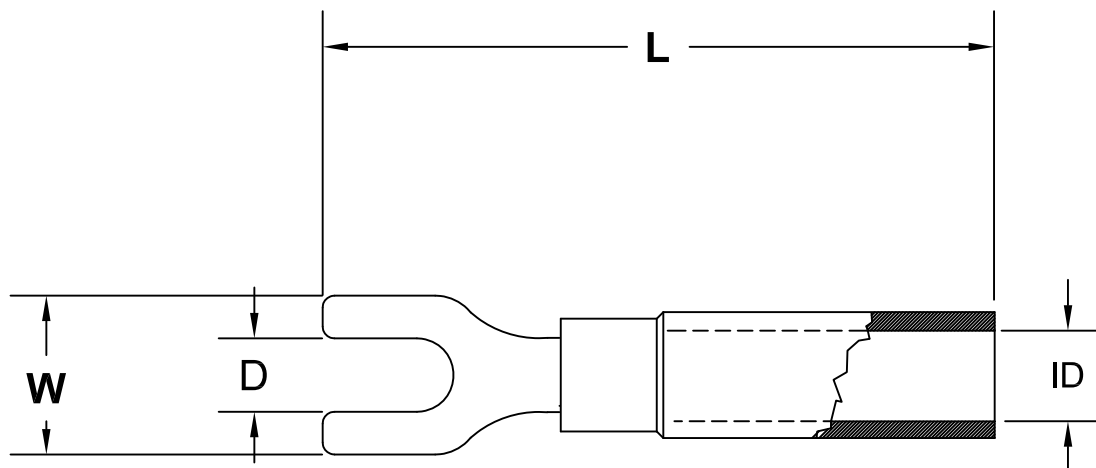

NOTES:

Bare Part:

1. Material: Copper
2. Finish: Electro-Tin Plate
3. Brazed Seam

Tubing:

1. Multiple wall Polyolefin
2. Meltable, integral inner wall
3. 275°F [135°C] shrink temp.
4. -67°F (-55°C) to 230°F (110°C)
Continuous Operating Temp .

5. Tensile Strength: 2200 PSI
6. Ultimate Elongation: 500%
7. Secan Modulus, 2%: 27,000 PSI
8. Specific Gravity: 1.00 Max
9. Longitudinal Change: 5%
10. Dielectric Strength: 1000 V/MIL
11. Volume Resistivity: 10¹⁵ Ohm/CM
12. Non-Corrosive
13. Water Absorption: <0.1%

SPC Type No.	Wire Size (AWG)	Stud Size (D)	Tubing I.D.	L Dimension	W Dimension	Tubing Color	Pkg Qty
3985	10 ~ 12	10	.295	1.242	.351	Yellow	25
3972	10 ~ 12	10	.295	1.242	.351	Yellow	100
1673	14 ~ 16	10	.234	1.222	.347	Blue	25
3948	14 ~ 16	10	.234	1.222	.347	Blue	100
1672	14 ~ 16	8	.234	1.223	.347	Blue	25
3947	14 ~ 16	8	.234	1.223	.347	Blue	100
1671	18 ~ 20	10	.220	1.235	.309	Red	25
3946	18 ~ 20	10	.220	1.235	.309	Red	100
3969	22 ~ 24	4	.150	.854	.209	Clear	100
3983	22 ~ 24	6	.150	.903	.248	Clear	25
3970	22 ~ 24	6	.150	.903	.248	Clear	100

SPC-F004.DWG

DISCLAIMER:
ALL STATEMENTS AND TECHNICAL INFORMATION CONTAINED HEREIN ARE BASED UPON INFORMATION AND/OR TESTS WE BELIEVE TO BE ACCURATE AND RELIABLE. SINCE CONDITIONS OF USE ARE BEYOND OUR CONTROL, THE USER SHALL DETERMINE THE SUITABILITY OF THE PRODUCT FOR THE INTENDED USE AND ASSUME ALL RISK AND LIABILITY WHATSOEVER IN CONNECTION THEREWITH.



SPC TECHNOLOGY

<i>Unless Otherwise Specified: Dimensions are shown for reference only!</i>	DRAWN BY:	DATE:	DRAWING TITLE:				
	Jeff McVicker	12/22/97	Spade Terminal				
	CHECKED BY:	DATE:	SIZE	DWG. NO.	ELECTRONIC FILE	REV	
	JOHN COLE	1/12/98	A	TA-332	TA-332.dwg	B	
APPROVED BY:	DATE:	SCALE: NTS		U.O.M.: INCHES [mm]		SHEET: 1 OF 1	
BRETT BRAATZ	1/12/98						