

**Oxid-Magnete
Oxid magnets
Aimants Oxid**

Kurzprofil

- preiswert
- großer Temperaturbereich
- großer Temperaturindex
- spröde
- empfindlich gegen Schläge (Absplitterung)
- schwer bearbeitbar

Materialbeschaffenheit

Oxidmagnete (auch: Keramikmagnete) sind Hartferritmagnete aus Barium- oder Strontiumferrit.

Lieferformen

Oxidmagnete sind rund, quader- oder ringförmig erhältlich.

Short profile

- low-priced
- wide temperature range
- high temperature index
- friable
- sensitive to impacts (splinter off)
- difficult to be worked

Quality of material

Oxid magnets (also: ceramic magnets) are ferrite magnets of barium- or strontium ferrite.

Available shapes

Oxid magnets are available round, squared or annular.

Résumé

- bon marché
- plage de température large
- l'indice de température grand
- friable
- sensible aux chocs (éclats)
- difficile à façonner

Qualité du matériau

Aimants Oxid (aussi: aimants céramiques) sont des aimants de ferrite dur (ferrite baryum ou strontium).

Formes disponibles

Aimants Oxid sont disponibles en forme ronde, carrée, annulaire.

Technische Daten von Oxid-Magneten Technical specifications of Oxid magnet Caractéristiques techniques des aimants Oxid	
Temperaturkoeffizient/temperature coefficient/coefficient de température	-0,2%/K
Temperaturbereich/temperature range/plage de température	-40°C ... +250°C
Curietemperatur/Curie temperature/température de Curie	ca./approx./env. 450°C
Br	typ. 365 mT
HcB	typ. 175 kA/m
HcJ	typ. 180 kA/m
BH max	typ. 25,5 kJ/m ³
Ausrichtung/orientation/alignement	anisotrop; isotrop/anisotropic; isotropique/ anisotropique
Härte/hardness/dureté	typ. 6-7 Mohs

**Oxid-Magnete ohne Gehäuse
Oxid magnets without housing
Aimant Oxid sans boîtier**

300 006

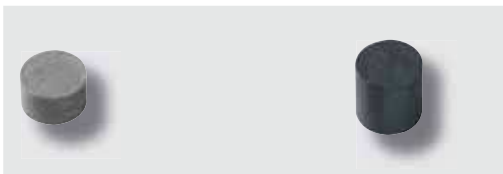
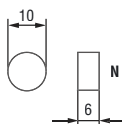

300 010

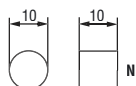

301 650

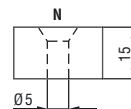

mit Befestigungsbohrung
with mounting slot
avec trou de fixation



**Oxid-Magnete mit Gehäuse
Oxid magnets with housing
Aimants Oxid avec boîtier**

300 770

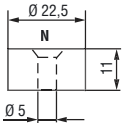

300 780

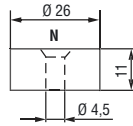

300 790

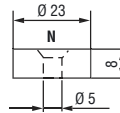

301 510

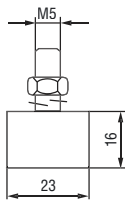
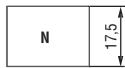

301 520

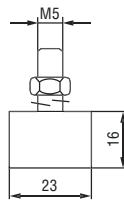
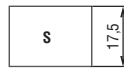

mit Befestigungsschraube
with mounting stud
avec vis de fixation

301 600

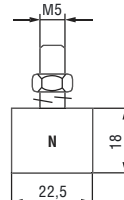

304 650

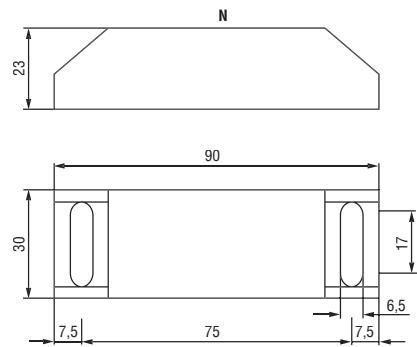

mit Befestigungsbohrungen
with mounting slots
avec trou de fixation

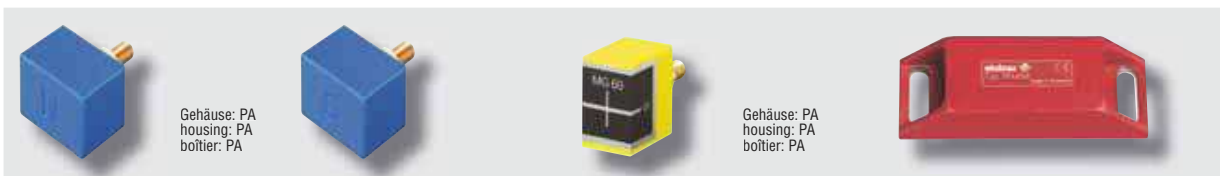

Gehäuse: PA
housing: PA
boîtier: PA

Gehäuse: PA
housing: PA
boîtier: PA