

MATERIAL

Turned and black-oxide steel, class 5.8 (tensile strength 500 N/mm²).

FEATURES AND APPLICATIONS

d2 and l1 dimensions can be used with GN 732 shoulder screws together with eye screws DIN 444 (see page 668), eye nuts type GN 444.2 (see page 669) hubs with eccentric cam type GN 919 (see page 700).

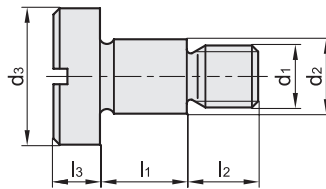
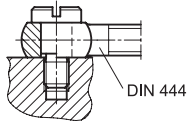

Code	Description	d1	d2	d3	l1 +0.25 +0.13	l2	l3	⚖️
GN.27741	GN 732-M5-6-5	M5	6 -0.03/-0.05	12	5	7	3	4
GN.27742	GN 732-M5-6-6	M5	6 -0.03/-0.05	12	6	7	3	4
GN.27743	GN 732-M5-6-8	M5	6 -0.03/-0.05	12	8	7	3	5
GN.27746	GN 732-M6-8-5	M6	8 -0.05/-0.08	14	5	8	4	8
GN.27747	GN 732-M6-8-8	M6	8 -0.05/-0.08	14	8	8	4	9
GN.27748	GN 732-M6-8-10	M6	8 -0.05/-0.08	14	10	8	4	10
GN.27751	GN 732-M8-10-10	M8	10 -0.05/-0.08	16	10	11	5	17
GN.27752	GN 732-M8-10-12	M8	10 -0.05/-0.08	16	12	11	5	18
GN.27753	GN 732-M8-10-14	M8	10 -0.05/-0.08	16	14	11	5	18
GN.27756	GN 732-M10-12-12	M10	12 -0.05/-0.08	19	12	13	6	29
GN.27757	GN 732-M10-12-14	M10	12 -0.05/-0.08	19	14	13	6	30
GN.27758	GN 732-M10-12-16	M10	12 -0.05/-0.08	19	16	13	6	33
GN.27761	GN 732-M12-14-14	M12	14 -0.05/-0.08	22	14	16	8	49
GN.27762	GN 732-M12-14-16	M12	14 -0.05/-0.08	22	16	16	8	51
GN.27763	GN 732-M12-14-18	M12	14 -0.05/-0.08	22	18	16	8	54



Machine elements