

## Bracket Hinge Mountings with Circlip

### Materials:

Mounting: Steel, zinc-plated.

Bolts: Stainless Steel.

Mating bracket for rear end mounting.

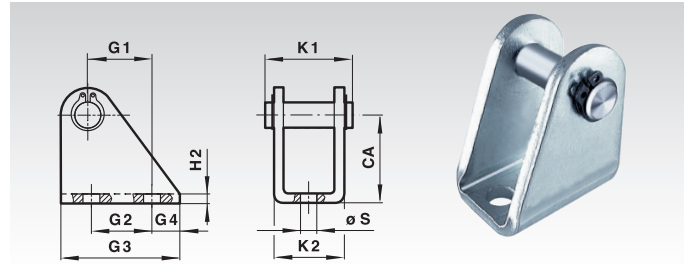

Ordering Details: e.g.: Product No. 810,023 10, Bracket Hinge, Rear with Circlip for Cylinder Ø 10 mm

Product No.	Cyl. Ø mm	Bolt Ø mm	CA mm	G1 mm	G2 mm	G3 mm	G4 mm	H2 mm	K1 mm	K2 mm	Ø S mm	Weight g
810 023 10	10	4	24	11	12,5	20	4	2,5	17,5	13	4,5	18
810 023 12	12/16	6	27	13	15	25	5	3	23	18	5,5	35
810 023 20	20/25	8	30	16	20	32	6	4	29,5	24	6,6	77

## Bracket Hinge Mountings with Split Pin

### Materials:

Mounting: Steel, zinc-plated.

Bolts: Stainless Steel.

Mating bracket for rear end mounting.

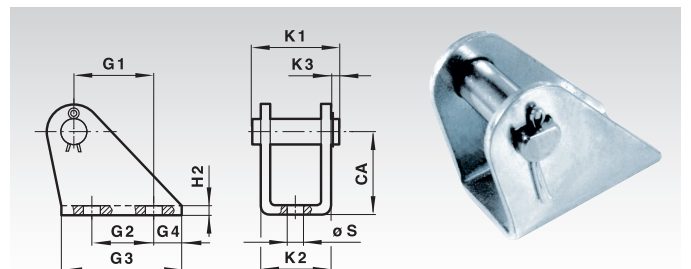

Ordering Details: e.g.: Product No. 810 022 10, Bracket Hinge, Rear with Split Pin for Cylinder Ø 10 mm

product No.	Cyl. Ø mm	Bolt Ø mm	CA mm	G1 mm	G2 mm	G3 mm	G4 mm	H2 mm	K1 mm	K2 mm	K3 mm	Ø S mm	Weight g
810 022 10	10	4	12	6,5	-	15	6	1	13,5	10,5	2	4,8	5
810 022 12	12/16	6	20	18,5	15	30	8	1,5	20	15	3	5,5	20
810 022 20	20/25	8	25	20	15	35	10	2	25	20,5	3	6,6	40