



PRODUKTINFORMATION

Vi reserverar oss mot fel samt förbehåller oss rätten till ändringar utan föregående meddelande

ELFA artikelnr

48-719-92	Glidskena 0201 406mm	48-726-02	Mont.vinklar botten 350mm
48-720-40	Glidskena 0201 610mm	48-726-10	Mont.vinklar botten 400mm
48-721-07	Glidskena 0204 406mm	48-726-28	Mont.vinklar botten 450mm
48-721-49	Glidskena 0204 610mm	48-726-36	Mont.vinklar botten 500mm
48-722-06	Glidskena 0301 406mm	48-726-44	Mont.vinklar botten 550mm
48-722-48	Glidskena 0301 610mm	48-727-01	Universalvinkel 63310
48-723-05	Glidskena 3307 305mm	48-727-19	Vinklar fram 63060
48-723-13	Glidskena 3307 356mm	48-727-27	Vinklar bak 28mm 63070
48-723-21	Glidskena 3307 406mm	48-727-35	Vinklar bak 220mm 63250
48-723-39	Glidskena 3307 457mm	48-727-43	Mutterlist 66010
48-723-47	Glidskena 3307 508mm	48-728-00	Kabelhållare CC5AD
48-723-54	Glidskena 3307 559mm		
48-723-62	Glidskena 3307 610mm		
48-723-70	Glidskena 3307 660mm		
48-723-88	Glidskena 3307 711mm		
48-725-03	Glidskena 3832 250mm (3831)		
48-725-11	Glidskena 3832 300mm (3831)		
48-725-29	Glidskena 3832 400mm (3831)		
48-725-37	Glidskena 3832 450mm (3831)		
48-725-45	Glidskena 3832 500mm (3831)		
48-725-52	Glidskena 3832 550mm (3831)		
48-725-60	Glidskena 3832 600mm (3831)		
48-725-78	Glidskena 3832 650mm (3831)		
48-725-86	Glidskena 3832 700mm (3831)		
48-725-94	Glidskena 3832 350mm (3831)		

Your Guide to Slide Selection

Factors to consider in selecting a slide

- Weight of chassis/drawer
- Side space available between chassis/drawer and rack/cabinet
- Depth of chassis/drawer
- Depth of rack/cabinet
- Height of chassis/drawer
- Travel/extension desired
- Is quick disconnect required?
- Lock function required
- Mounting hole pattern required
- Optional mounting hardware for mounting into rack/enclosure
- Any specialised applicational or environmental requirements

Accuride
reserve the right to
alter specifications
without notice.

Slide Selection

IF YOUR MAJOR CONSIDERATION IS LOAD OR SPACE

Maximum Load Rating Per Pair <i>(Based on Slide Length - refer to product data page)</i>	Side Space Required	Slide Type	Page No.
34 kg	12.7 mm	0262	24
45 kg	12.7 mm	3831	11
49 kg	9.5 mm	0201	9
59 kg	9.5 mm	0204	10
59 kg	19.1 mm <small>(10.00mm if recessed)</small>	0305	12
63 kg	19.1 mm	0307	13
65 kg	19.1 mm	0330	25
68 kg	12.7 mm	3307	14
68 kg	12.7 mm	3308	15
80 kg	19.1 mm	0301	16
113.5 kg	12.7 mm	0601	22
124 kg	19.1 mm	3607	17
180 kg	19.1 mm	0531	18
227 kg	19.1 mm	9301	20
230 kg	26.5 mm	0522	23
272 kg	23.6 mm	0501	19
420 kg	23.6 mm	0530	21

Models highlighted are also available via the
Accuride
QUICKSHIP
PROGRAMME

Slide Selection

See individual product page for specific load rating per length.

Basis of Load Ratings

- The maximum permissible load for a pair of side mounted slides
- The centre of gravity of load is centred between and at the midpoint of the drawer members
- Based on 10,000 cycle dynamic tests
- Includes additional 100% static load safety factor in the extended position
- Flat mounting the slides reduces load carrying capacity to approximately 25% of the side mount capacity.
- All fixing positions should be used to achieve maximum load rating.
- For any specialised application which is exposed to vibration and/or rough usage e.g. mobile vehicles or military equipment or where the frequency of access is high, the load ratings quoted may not be applicable. We therefore recommend that in all such applications you consult with Accuride or your local Accuride representative to determine product suitability.

Standard Slide Specification & Ordering Guidelines

Material Specification

Slide members	- cold rolled steel
Ball retainers	- cold rolled steel zinc plated or stainless steel
Ball bearings	- precision type, carbon chrome steel or stainless steel
Lubricant	- Hi-Lo temperature grease
Stainless Steel - 1.4301 X 5 CrNi 1810	

General Technical Information

- Tolerances unless otherwise stated are ± 0.8 on linear or ± 0.2 on diameter.
- Internal clearances permit screw head dimensions not exceeding 2.5mm high x 9.6mm diameter (on the 9301 outer member and the 0531 - only the M5 countersunk screw may be used).
- Holes other than shown may be in the members at Accuride option.

How to Order

Accuride slides are available in the following standard finishes and packaging:-

Order Prefix	Packaging	Finish
DZ	Quick Ship (ex. stock) <i>(packed in pairs/kits)</i>	Electro zinc plate and clear chromate
CZ	Manufactured to order <i>(bulk-packed)</i>	Electro zinc plate and clear chromate
DB	Quick Ship (ex. stock) <i>(packed in pairs/kits)</i>	Electro zinc plate and black passivate
CB	Manufactured to order <i>(bulk-packed)</i>	Electro zinc plate and black passivate
DS	Quick Ship (ex. stock) <i>(packed in pairs/kits)</i>	Stainless Steel see table below for models available
SS	Manufactured to Order <i>(bulk-packed)</i>	Stainless Steel see table below for models available
CY	Manufactured to Order <i>(bulk-packed)</i>	Electro-zinc plate and yellow chromate
MY	Manufactured to Order <i>(bulk-packed)</i>	Electro-zinc plate and yellow chromate with stainless steel balls and retainers.

N.B. Other packaging and finish options may be available - please contact Accuride for details.

Your Accuride ordering code is made up as follows:-

DZ	0301	-0018	LJ
Denotes whether stock or manufactured and desired finish (see above table)	Slide Model	Slide Length	Accessory (flip-lok and shockblock options).

For Example:

SS0501-0020LJ

Would be slide model 0501 manufactured to order in stainless steel @ 20" (508 mm) long. With a lock open and closed flip-lok (2354 series - see page 30).

DZ0301-0016

Would be slide model 0301 in bright zinc finish supplied from the Quick Ship Programme (ex. Stock) @ 16" (406 mm) long.

- IF FLIP-LOKS AND/OR SHOCKBLOCKS ARE REQUIRED A SUFFIX WILL NEED TO BE ADDED TO THE ORDER CODE. FOR DETAILS SEE PAGES 29 & 30

Slide Specification

STANDARD FEATURES	GENERAL PURPOSE RANGE												
	201 Page 9	204 Page 10	3831 Page 11	305 Page 12	307 Page 13	3307 Page 14	3308 Page 15	301 Page 16	3607 Page 17	531 Page 18	9301 Page 20	501 Page 19	530 Page 21
75% Extension	●	●											
100% Extension									●		●		
100%+ Extension			●	●	●	●	●	●		●		●	●
Two-Way Travel													
Front Disconnect		●	●	●	●	●	●		●				
Hold-in Detent			●							●			
Lock-in									●				
Lock-out		●		●	●	●	●		●				
Shock Blocks as Standard													
Stainless Steel													●
Linear Movement													●

OPTIONAL FEATURES

Optional Bottom/Platform Mount			●										
Optional Rack Mounting Brackets	●	●		●	●	●	●	●	●	●		●	
Also available in Stainless Steel	●	●						●		●*		●	●
Shock Blocks available	●							●				●	●
Flip-loks available								●				●	●

SPECIALIST RANGE				
115 Page 28	601 Page 22	522 Page 23	262 Page 24	330 Page 25
		●	●	●
	●			
			●	●
		●		
				●
●				

Models also available in the
Accuride
QUICKSHIP
PROGRAMME

Optional features also available in the
Accuride
QUICKSHIP
PROGRAMME

Slide Specification

Accuride reserve the right to alter specifications without notice.

Refer to individual product page for more information. See page 8 for explanation of terms.
* Available up to 500mm length only.

Explanation of Terms

Side Space	The amount of room necessary between the drawer side and the cabinet or chassis and the rack. The side space dimension is critical for optimal smooth movement. Special brackets are available to reduce the side space required in an electronics rack with model 305. These brackets allow a portion of the slide to be mounted behind the vertical rail. See page 12 for details.	
Travel	75% extension	Drawer opens partially, approximately 75% of the total slide length.
	100% extension	Drawer opens the same amount again as the slide length.
	100%+ extension	Overtravel is achieved. This allows the drawer to pull completely out of the cabinet providing access to the entire drawer.
Disconnect	Allows the drawer or chassis to be quickly removed from the case or rack. A lever or latch must be actuated before the drawer can be removed from the cabinet.	
Detent	Holds the slide open or closed until extra force is applied to overcome the detent.	

Locks Secures the slide in position. A lever or latch must be actuated to move the slide. A lock-out feature assists servicing components without removing the unit from the enclosure. A lock-in feature prevents drawers from opening until a latch is actuated.

Optional Rack Mounting Brackets Optional brackets are available to make it easier to mount slides in an electronics rack/enclosure. Please refer to rack mounting accessories selection guide on page 31-34.

Shock Blocks Accuride shock blocks are hardened steel pins which provide an interference fit between the slide members to effectively minimise the amplification of vibration and reduce the damaging effects of shock.

Flip-loks 300 and 500 series slides may be supplied with the "Flip-loks". Locked positions can be provided at the open, closed and 1/2 travel locations, separately or in any combination. Manually operated, the lock series provides both local and remote actuation. Design simplicity and rugged construction ensures a high degree of reliability.

Accuride®

Accuride
reserve the right to
alter specifications
without notice.

Accuride®

75% extension slide

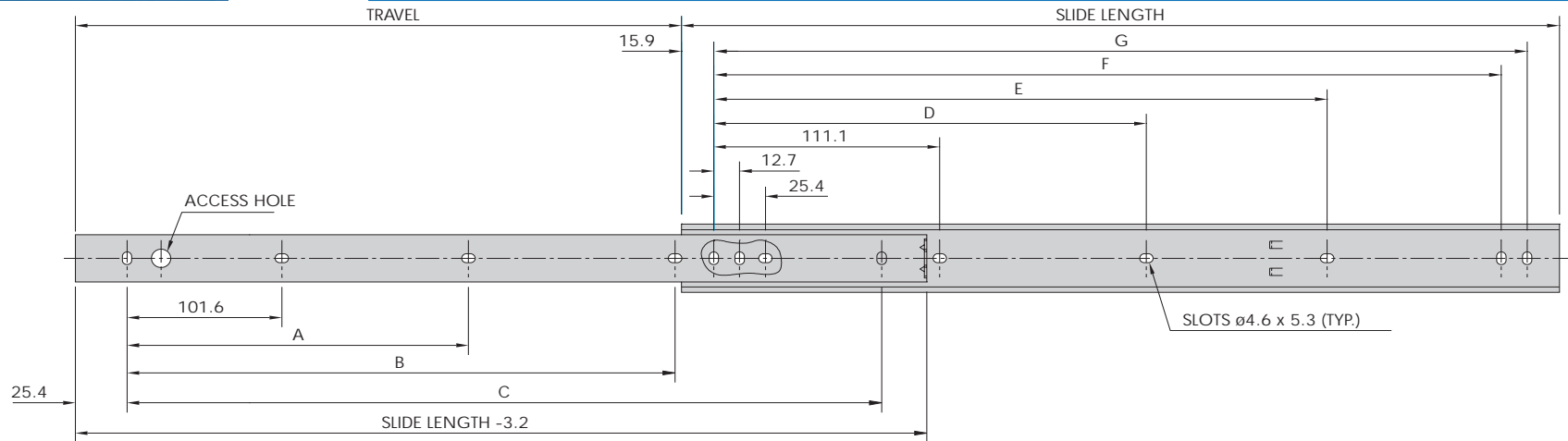
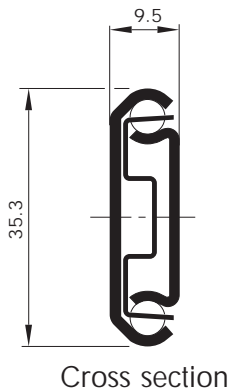

See page 6 - 'How to Order' - to select your desired finish and packaging.

FEATURES

- 75% extension
- Slide assembly is unhandred
- See pages 31-34 for rack mounting bracket options
- See page 7 for optional features
- Quick Ship finish available is Bright Zinc. For other finishes available see page 6

ORDER CODE	DIMENSIONS									KILOGRAMS PER PAIR	
	SLIDE LENGTH	TRAVEL ±3.2	A	B	C	D	E	F	G	SLIDE WEIGHT	LOAD RATING
--0201-0012	304.8	226.5	-	152.4	254.0	-	149.2	260.3	273.0	0.57	49
--0201-0014	355.6	277	-	203.2	304.8	-	200.0	311.2	323.9	0.66	47
--0201-0016	406.4	302.5	-	254.0	355.6	-	250.8	361.9	374.6	0.77	43
--0201-0018	457.2	328	203.2	304.8	406.4	212.7	301.6	412.7	425.4	0.87	41
--0201-0020	508.0	379	228.6	355.6	457.2	238.1	352.4	463.5	476.2	0.96	37
--0201-0022	558.8	404	254.0	406.4	508.0	263.5	403.2	514.3	527.0	1.06	34
--0201-0024	609.6	429.5	279.4	457.2	558.8	288.9	454.0	565.1	577.8	1.17	30
--0201-0026	660.4	480.5	304.8	508.0	609.6	314.3	504.8	615.9	628.6	1.25	27
--0201-0028	711.2	505.5	330.2	558.8	660.4	339.7	555.6	666.7	679.4	1.34	25

Order codes with this tint indicate Quick Ship lengths currently held in stock

NOTES

- Dimensions in millimetres.
- All fixing positions must be used to achieve maximum load rating
- It may be possible to manufacture alternative lengths to order. Contact your local Accuride representative for details.

Accuride®

75% extension slide with front disconnect & lock-out

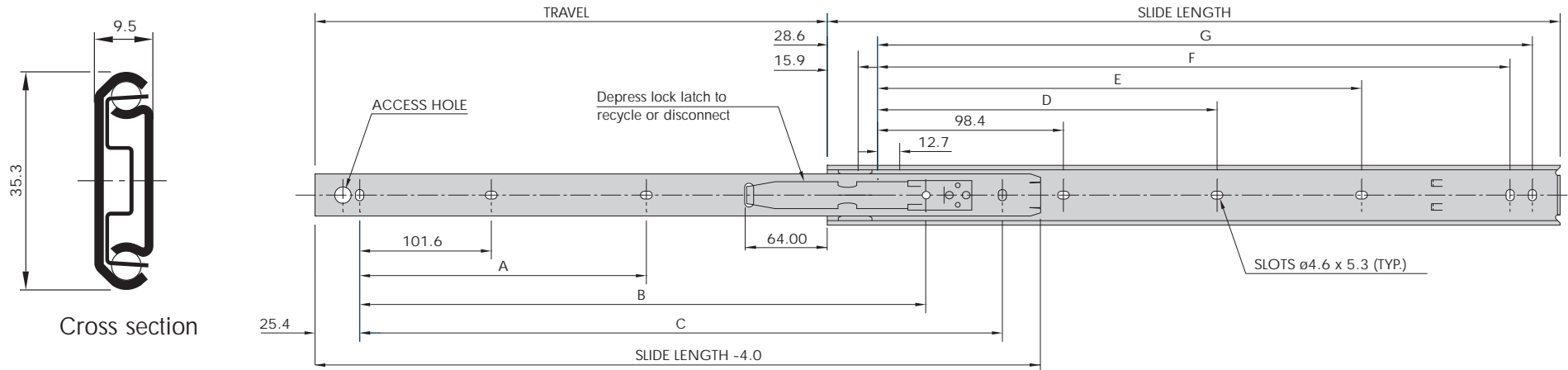

See page 6 - 'How to Order' - to select your desired finish and packaging.

FEATURES

- 75% extension
- Slide has lock out
- Chassis member disconnects
- Slide assembly is unhandred
- See pages 31-34 for rack mounting bracket options
- See page 7 for optional features
- Quick Ship finish available is Bright Zinc. For other finishes available see page 6

ORDER CODE	DIMENSIONS									KILOGRAMS PER PAIR	
	SLIDE LENGTH	TRAVEL ±3.2	A	B	C	D	E	F	G	SLIDE WEIGHT	LOAD RATING
--0204-0012	304.8	201.5	-	215.9	254.0	-	136.5	247.7	260.4	0.63	64
--0204-0014	355.6	252.5	-	266.7	304.8	-	187.3	298.5	311.2	0.73	59
--0204-0016	406.4	303.0	-	317.5	355.6	-	238.1	349.2	361.9	0.84	55
--0204-0018	457.2	329.0	203.2	342.9	406.4	200.0	288.9	400.0	412.7	0.94	50
--0204-0020	508.0	379.5	228.6	393.7	457.2	225.4	339.7	450.8	463.5	1.05	42
--0204-0022	558.8	405.0	254.0	419.1	508.0	250.8	390.5	501.6	514.3	1.15	39
--0204-0024	609.6	430.5	279.4	444.5	558.8	276.2	441.3	552.4	565.1	1.27	35
--0204-0026	660.4	481.5	304.8	495.3	609.6	301.6	492.1	603.3	616.0	1.37	32
--0204-0028	711.2	506.5	330.2	520.7	660.4	327.0	542.9	654.1	666.8	1.47	27

Order codes with this tint indicate Quick Ship lengths currently held in stock

NOTES

- Dimensions in millimetres.
- All fixing positions must be used to achieve maximum load rating.
- It may be possible to manufacture alternative lengths to order. Contact your local Accuride representative for details.

Accuride®
reserve the right to
alter specifications
without notice.

Accuride®
QUICKSHIP
PROGRAMME

0204

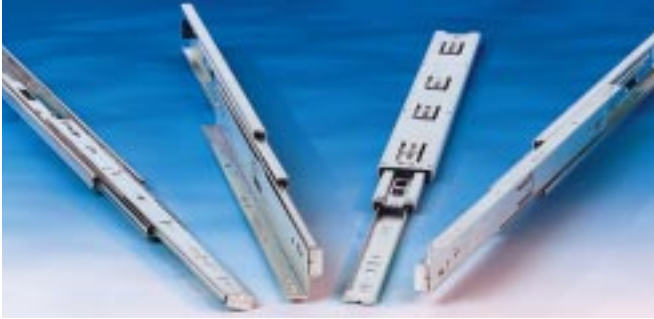

Accuride®

100%+ extension slide with optional clip-on platform and bottom mount bracket

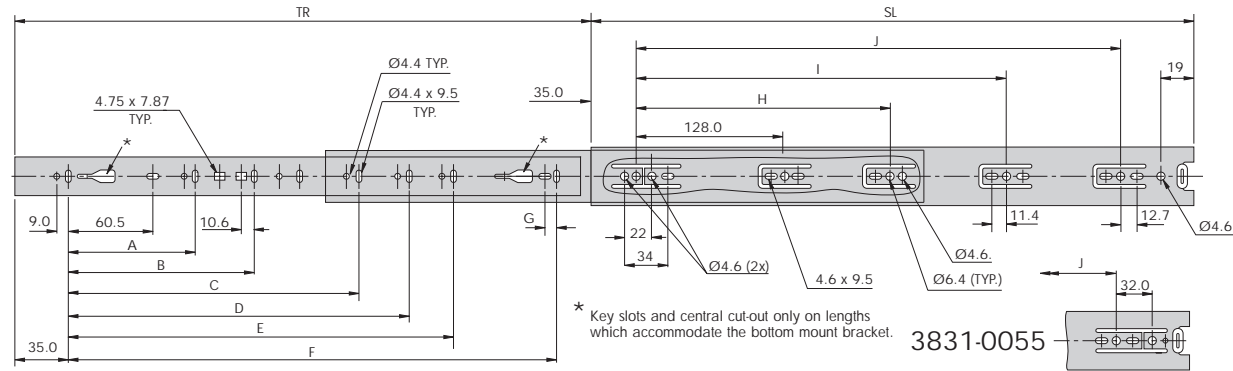
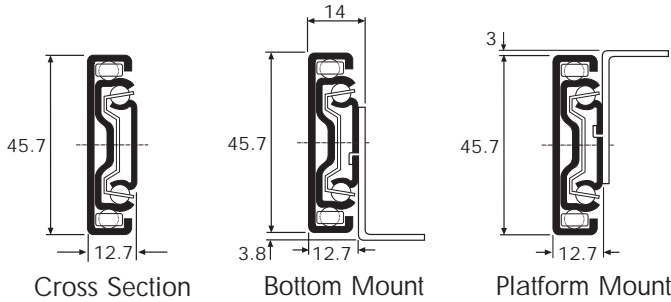

FEATURES

- 100%+ extension
- Optional clip-on bottom mount bracket for lengths 350mm - 550mm
- Platform mounting option
- Drawer member disconnects by rotating lever
- Stay closed feature
- Tolerance absorption tabs
- Quick Ship finishes available are Bright Zinc and Black Passivate. For other finishes available see page 6

See page 6 - 'How to Order' - to select your desired finish and packaging.

ORDER CODE	DIMENSIONS												KILOGRAMS PER PAIR	
	SL	TR	A	B	C	D	E	F	G	H	I	J	SLIDE WEIGHT	LOAD RATING
--3831-0025	250	243	96.0	-	-	-	-	192	-	-	-	-	0.79	23
--3831-0030	300	305	96.0	-	-	-	-	242	11	224	-	-	0.95	27
--3831-0035	350	356	128	-	-	-	-	292	11	224	-	-	1.10	34
--3831-0040	400	406	128	-	-	-	-	342	11	224	320	-	1.27	45
--3831-0045	450	457	128	-	-	320	-	392	11	224	352	-	1.42	45
--3831-0050	500	508	128	-	-	320	-	442	11	224	416	-	1.58	45
--3831-0055	550	559	128	-	-	320	416	492	11	224	352	448	1.75	45
--3831-0060	600	610	128	224	-	416	-	542	11	224	352	480	1.91	39
--3831-0065	650	660	128	224	-	416	544	592	11	224	352	544	2.06	32
--3831-0070	700	711	128	224	288	416	544	642	11	224	352	544	2.22	27

Order codes with this tint indicate Quick Ship lengths currently held in stock

NOTES

- Dimensions in millimetres.
- All fixing positions must be used to achieve maximum load rating
- It may be possible to manufacture alternative lengths to order. Contact your local Accuride representative for details.

BOTTOM/PLATFORM MOUNT BRACKET

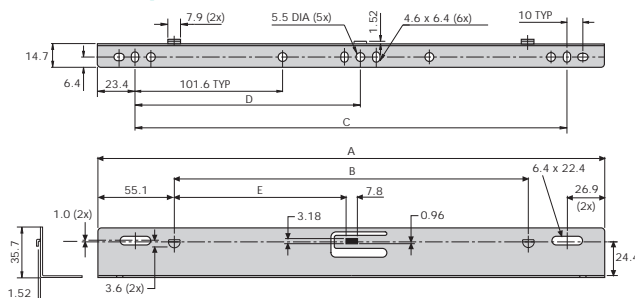

BOTTOM/PLATFORM MOUNT BRACKETS

ORDER CODE	FOR SLIDE LENGTH	DIMENSIONS				
		A	B	C	D	E
--63335	350	346.7	236.5	300.0	150.0	114.4
--63340	400	396.7	286.6	350.0	175.0	139.4
--63345	450	446.8	336.6	400.0	200.0	164.4
--63350	500	496.8	386.6	450.0	225.0	189.4
--63355	550	546.8	436.6	500.0	250.0	214.4

Accuride® reserve the right to alter specifications without notice.

3831

NEW TO THE
Accuride®
QUICKSHIP
PROGRAMME



Accuride®

100%+ extension medium duty with disconnect and lock-out
(minimal side-space required)

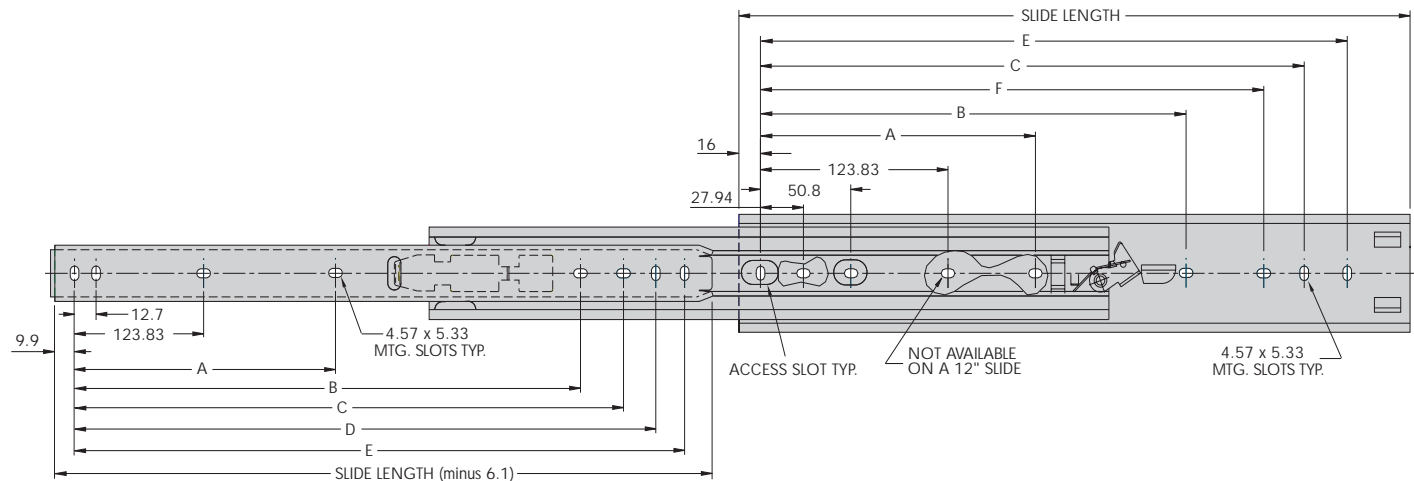
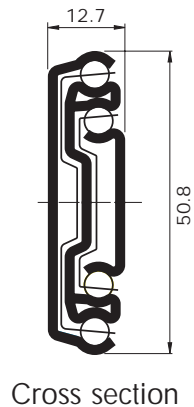

FEATURES

- Load rating up to 68 kg
- Side space 12.7 mm
- 100%+ extension
- Slide has lock-out
- Chassis member disconnects
- Slide assembly is unhandred
- Hardware included for hard mounting
- Installation leaflet included
- See pages 31-34 for rack mounting bracket options
- Quick Ship finish available is Bright Zinc. For other finishes available see page 6

See page 6 - 'How to Order' - to select your desired finish and packaging.

ORDER CODE	DIMENSIONS								KILOGRAMS PER PAIR	
	SLIDE LENGTH	TRAVEL ±3.2	A	B	C	D	E	F	SLIDE WEIGHT	LOAD RATING
--3307-0012kt	305	330	-	-	234.9	247.6	260.4	209.5	1.20	68
--3307-0014kt	356	381	-	-	285.7	298.4	311.2	260.4	1.41	67
--3307-0016kt	406	432	-	-	336.5	349.2	362.0	311.2	1.59	67
--3307-0018kt	457	483	177.8	314.3	387.3	400.1	412.8	362.0	1.82	66
--3307-0020kt	508	533	203.2	365.1	438.1	450.8	463.6	412.8	2.00	66
--3307-0022kt	559	584	228.6	415.9	488.9	501.6	514.4	463.6	2.23	64
--3307-0024kt	610	635	254.0	466.7	539.7	552.4	565.2	514.4	2.41	61
--3307-0026kt	660	686	279.4	517.5	590.5	603.3	616.0	565.2	2.64	58
--3307-0028kt	711	737	304.8	568.3	641.3	654.1	666.8	616.0	2.81	55

Order codes with this tint indicate Quick Ship lengths currently held in stock

NOTES

- Dimensions in millimetres.
- All fixing positions must be used to achieve maximum load rating.
- It may be possible to manufacture alternative lengths to order. Contact your local Accuride representative for details.

Accuride
reserve the right to
alter specifications
without notice.

NEW TO THE
Accuride®
QUICKSHIP
PROGRAMME

3307



Accuride®

100%+ extension slide

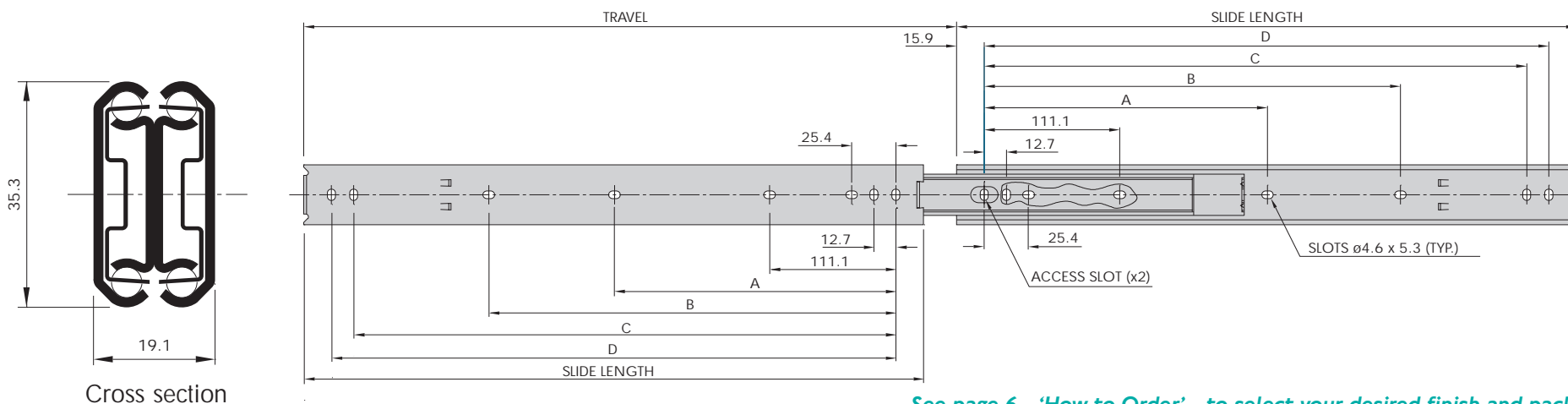

See page 6 - 'How to Order' - to select your desired finish and packaging.

FEATURES

- 100%+ extension
- Slide assembly is unhandled
- See pages 31-34 for rack mounting bracket options
- See page 7 for optional features
- Quick Ship finish available is Bright Zinc. For other finishes available see page 6

ORDER CODE	DIMENSIONS						KILOGRAMS PER PAIR	
	SLIDE LENGTH	TRAVEL ±3.2	A	B	C	D	SLIDE WEIGHT	LOAD RATING
--0301-0012	304.8	326.0	-	149.2	260.3	273.0	1.31	80
--0301-0014	355.6	377.0	-	200.0	311.2	323.9	1.57	77
--0301-0016	406.4	428.0	-	250.8	361.9	374.6	1.80	73
--0301-0018	457.2	479.0	212.7	301.6	412.7	425.4	2.02	68
--0301-0020	508.0	530.0	238.1	352.4	463.5	476.2	2.27	65
--0301-0022	558.8	580.0	263.5	403.2	514.3	527.0	2.51	59
--0301-0024	609.6	631.0	288.9	454.0	565.1	577.8	2.73	52
--0301-0026	660.4	682.0	314.3	504.8	615.9	628.6	2.93	48
--0301-0028	711.2	733.0	339.7	555.6	666.7	679.4	3.13	41

Order codes with this tint indicate Quick Ship lengths currently held in stock

NOTES

- Dimensions in millimetres.
- All fixing positions must be used to achieve maximum load rating.
- It may be possible to manufacture alternative lengths to order. Contact your local Accuride representative for details.

Accuride®
reserve the right to
alter specifications
without notice.

Accuride®
QUICKSHIP
PROGRAMME

0301



Accuride[®]

Cable carrier

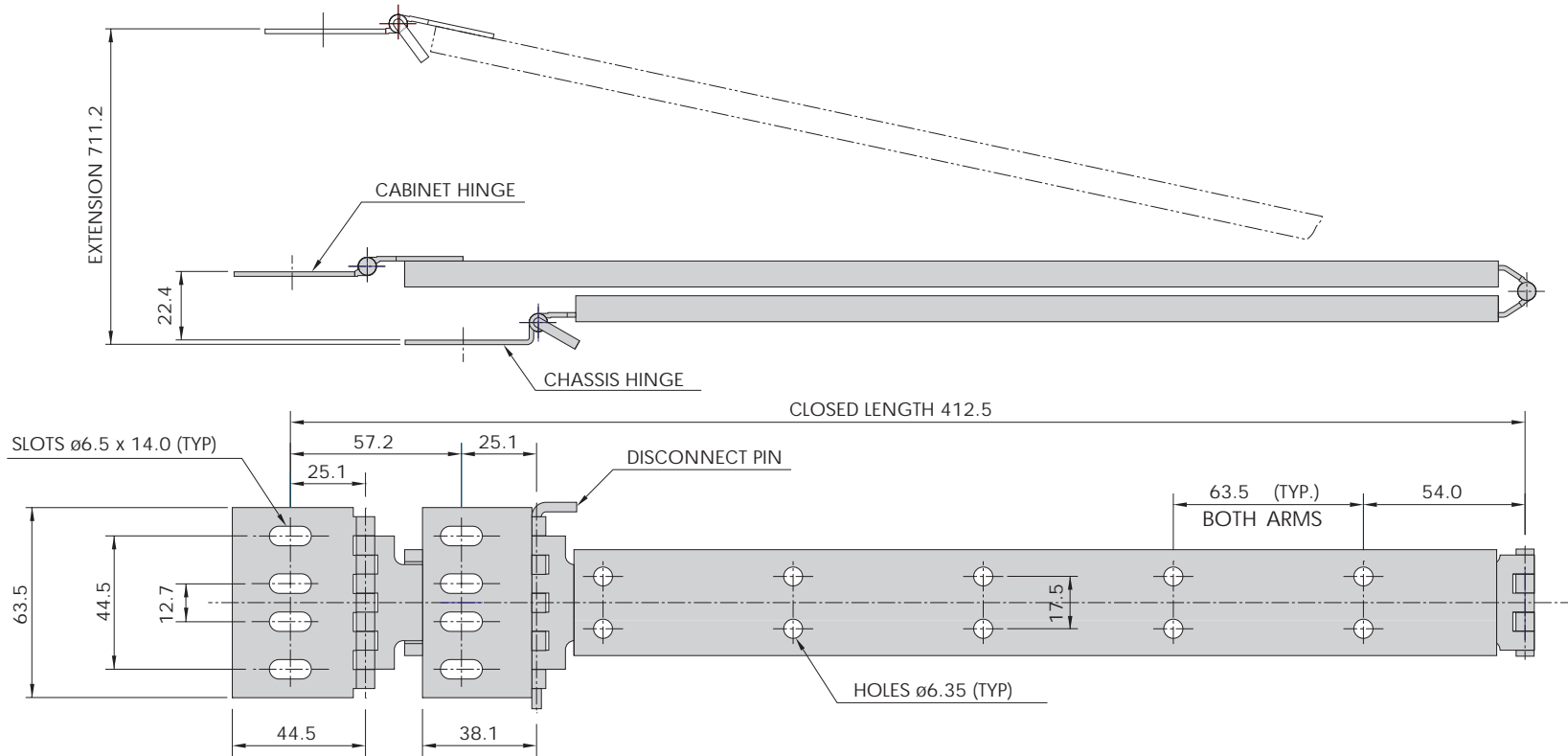

FEATURES

- Disconnects from chassis
- Ample provision for cable clamps
- Easily installed
- Can be rack mounted
- Quick Ship finish available is Bright Zinc. For other finishes available see page 6

ORDER CODE	Weight Per Unit
--CC5AD	0.475

Order codes with this tint indicate Quick Ship lengths currently held in stock

NOTES

- Dimensions in millimetres.
- Not suitable for use with slides over 700mm in length.

ORDERING GUIDELINES

This cable carrier can be manufactured to order in bulk with or without a disconnect pin. To create the appropriate order code, the material and finish prefix has to be determined (refer to page 6) and follow the guidelines below:-

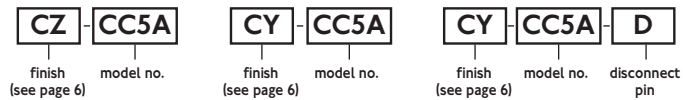

Accuride[®] reserve the right to alter specifications without notice.

CC5AD

Accuride[®]
QUICKSHIP
PROGRAMME

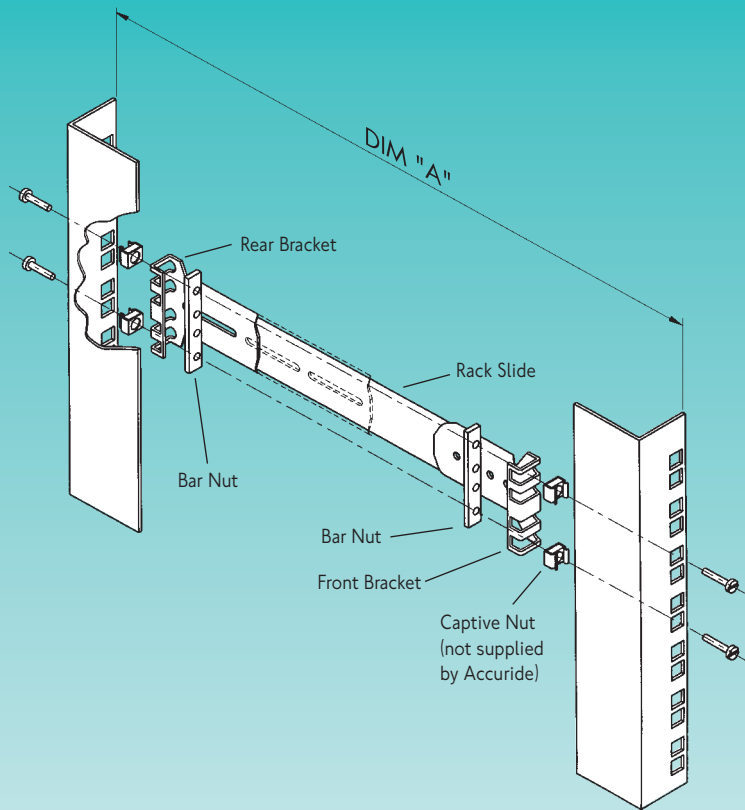

Slide Length Selection for Electronic Cabinets

- Take the distance between the mounting uprights, (DIM "A"), subtract 10 mm and select the slide length nearest to this dimension, **but not greater**.
- Select a bracket from the bracket selection table on page 32 with the amount of adjustability you require.

Rack Mounting Accessories

MOUNTING BRACKETS

- Mounting brackets simplify installation of Accuride slides in racks and enclosures.
- Short brackets are usually used at the front of the chassis and long brackets at the rear for added adjustability.
- Use the Bracket Selection Table on the next page to choose brackets compatible with the slide you have selected.
- All brackets are supplied in kits complete with fixing hardware.
- For each pair of slides order:
 - one pair of front brackets
 - one pair of rear brackets - short or long
 - four bar nuts
 - fillister head screws - if not included
 - you will also require 8 captive nuts (not supplied by Accuride).
- The brackets that are available via the Quick Ship Programme (prefix DZ) are packed as individual kits. If you require the kitted items to be supplied in bulk and packed separately simply change the part number prefix to CZ and drop the suffix KT.

Bracket Selection Table

For Slide Models	Mounting Slots in Brackets	Bar Nuts	Fillister Head Screws	PART NUMBERS				
				SHORT BRACKETS		LONG BRACKETS		
				Front	Rear - Up To 28mm Adjust	Rear - Up To 40mm Adjust	Rear - Up To 220mm Adjust	Rear - Up To 208mm Adjust
0201, 0204, 0301, 0307 & 0305 (unrecessed)	Four (57mm height)	DZ66020 (1 pair)	included	DZ63020 (1 pair)	DZ63030 (1 pair)	not available	DZ63230 (1 pair)	not available
	Three (43.7mm (1U) height)	DZ66010 (1 pair)	included	DZ63060 (1 pair)	DZ63070 (1 pair)	not available	DZ63250 (1 pair)	not available
3307 & 3308	Three (43.7mm (1U) height)	included	DZ66030 (Box of 100)	Universal - DZ63310 (40mm adjust) (2 pairs)			not available	DZ63360
3607, 0531	Four (57mm height)	DZ66020 (1 pair)	included	Universal - DZ65020 (58mm adjust) (2 pairs)				
0305 (recessed)	Four (57mm height)	DZ66020 (1 pair)	included	DZ63160 (2 pairs)	DZ63170 (2 pairs)	not available	DZ63270 (2 pairs)	not available
0501 & 0601	Four (57mm height)	CZ66020 (1 bar nut)	included	CZ65000 (1 bracket)	CZ65010 (1 bracket)	not available	not available	not available
3831, 9301, 0530, 0115, 0522, 262 & 330	No Brackets Available for These Models							

Brackets also available in the



Bracket Selection

RACK MOUNTING BRACKETS

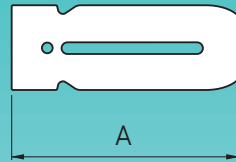
Short Bracket

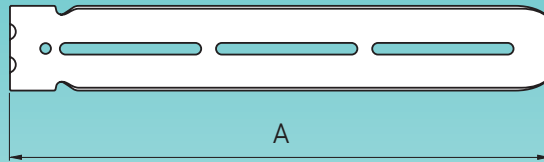

Long Bracket



4 Hole

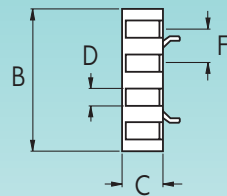

3 Hole

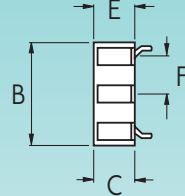

BAR NUTS

4 Hole Bar

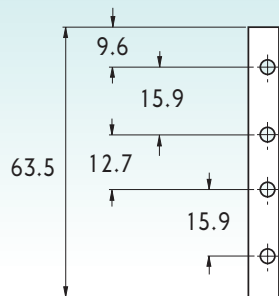

3 Hole Bar

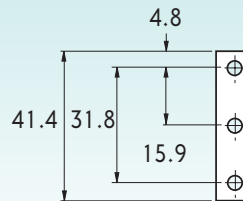

Rack Mounting Brackets and Bar Nuts

RACK MOUNTING BRACKETS

Model Numbers	A Short	A Long	B 4 Hole	B 3 Hole	C	D	E	F
0201, 0204, 0301, 0307 & 0305	69.9	266.7	57.2	44.0	15.0	6.35	9.5	12.7 (4 Slot) 15.9 (3 Slot)
0305 (recessed)	109.5	274.6	63.5	41.9	19.8	7.4	18.3	15.2
3307, 3308	114.6	279.7	63.5	44.5	18.3	7.4	14	15.2
3607, 0531	140.0	-	60.0	-	14.0	5.5	10	15.9
0501, 0601	139.7	-	70.0	-	14.0	5.5	10	15.9

NOTE

■ Dimensions in millimetres.

BAR NUTS

For ease of installation and adjustment of Accuride slides in racks and enclosures.

Easier than handling individual nuts when access to the slide mounting bracket is limited.

The following dimensions apply to all bar nuts:

thickness of bar nut - 3.2 mm

width of bar nut - 9.6 mm

mounting holes - 10/32 UNF

mounting holes / centre to edge - 3.6 mm

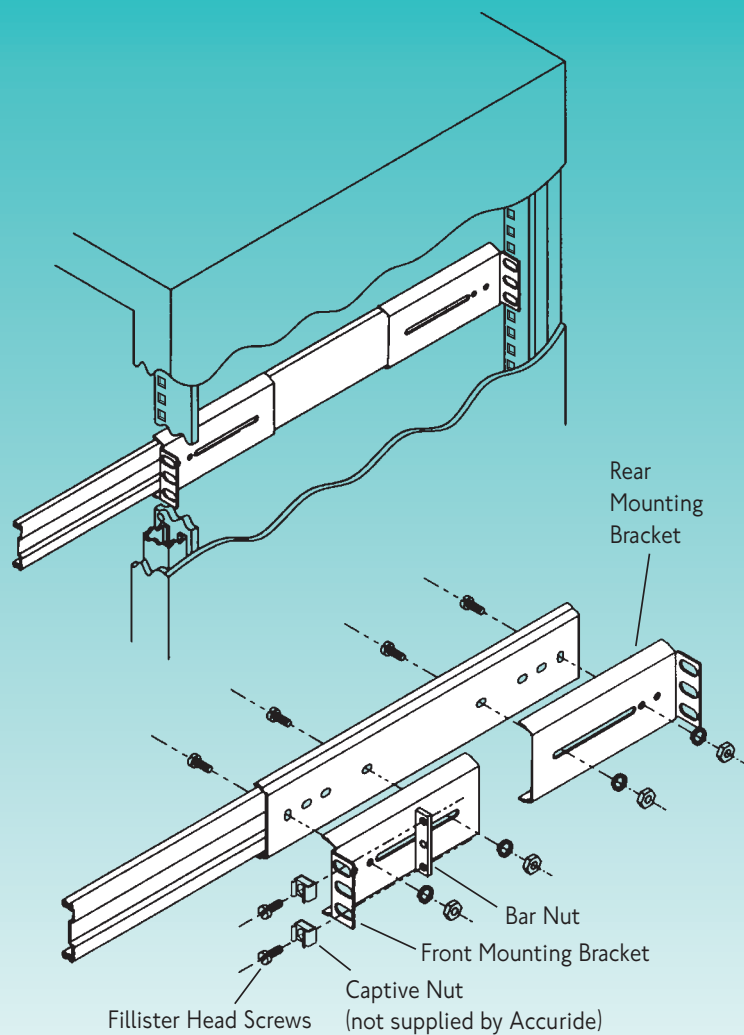

RACK MOUNTING

Mounting Instructions

The mounting brackets shown on the preceding pages are designed specifically for Accuride slides. Slides properly installed with correct mounting brackets will provide lasting, maintenance-free service. Illustrated is the correct orientation of the mounting screws for attaching mounting brackets to Accuride slides. To ensure proper operation of the slide, make certain that all bracket mounting screw heads are inserted so that the screw heads are inside the slides. The front bracket should first be positioned then securely fastened in place. The rear bracket screws should be left sufficiently loose to allow adjustment while fitting to the vertical rack strips.

The brackets are held in position by bar nuts, which in turn are fixed by fillister head screws fitted through appropriately positioned captive nuts in the front and rear rack strips. (Note: the captive nuts are not supplied by Accuride). These screws sink into the captive nuts so that their heads are flush with the rack strip.

During installation in the enclosure/rack, matching the alignment of the left hand and right hand slides is accomplished by installing one slide, then aligning it to the rack strips and securing the mounting screws. Then install the remaining slide, leaving the mounting screws sufficiently loose to permit horizontal adjustment. Moving the chassis in and out a few times prior to tightening the loose mounting screws will ensure proper alignment of the slides to each other and the cabinet. Any sign of binding indicates lateral stress or misalignment.