



**The Timken Company**

4500 Mt Pleasant St. NW

N. Canton, OH 44720

**Phone:** (234) 262-3000

**E-Mail:** [CustomerCAD@timken.com](mailto:CustomerCAD@timken.com) • **Web site:** [www.timken.com](http://www.timken.com)

## Part Number UCF206, UCF 200 Four-Bolt Flanged Housed Units - Set Screw Locking

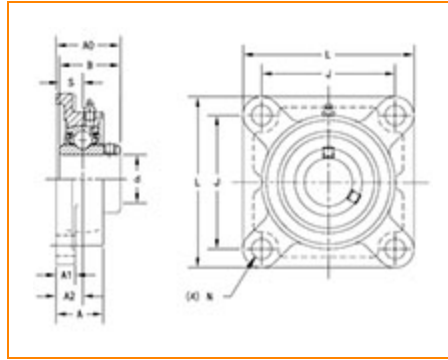

[Specifications](#) | [Dimensions](#) | [Basic Load Ratings](#)

### Specifications

<b>Bearing Number</b>	UC206
<b>Shaft Size d</b>	30 mm
<b>UPC Code</b>	087796073579
<b>Locking Style</b>	Set Screw Locking
<b>Housing Construction</b>	Four-Bolt Square Flange
<b>Weight</b>	1.2 Kg 2.6 lb

### Dimensions

<b>Total Length L</b>	108 mm 4.252 in
<b>Housing Width A</b>	31 mm 1.22 in



	1.22 in
<b>Bolt Hole Spacing J</b>	83 mm 3.268 in
<b>Bolt Hole Size N</b>	12 mm 0.472 in
<b>Flange Thickness A1</b>	13 mm 0.512 in
<b>Center of Bearing from Housing End A2</b>	18 mm 0.709 in
<b>Inner Ring Width B</b>	38.1 mm 1.5 in
<b>Center of Bearing from Bearing End S</b>	15.9 mm 0.626 in
<b>Dimension A0</b>	40.2 mm 1.594 in
<b>Bolt Size</b>	M10
<b>Grease Nipple Size</b>	A-1/4-28UNF

## Basic Load Ratings

<b>Static Load Rating</b>	11300 N 2540 lbf
<b>Dynamic Load Rating</b>	19500 N 4385 lbf

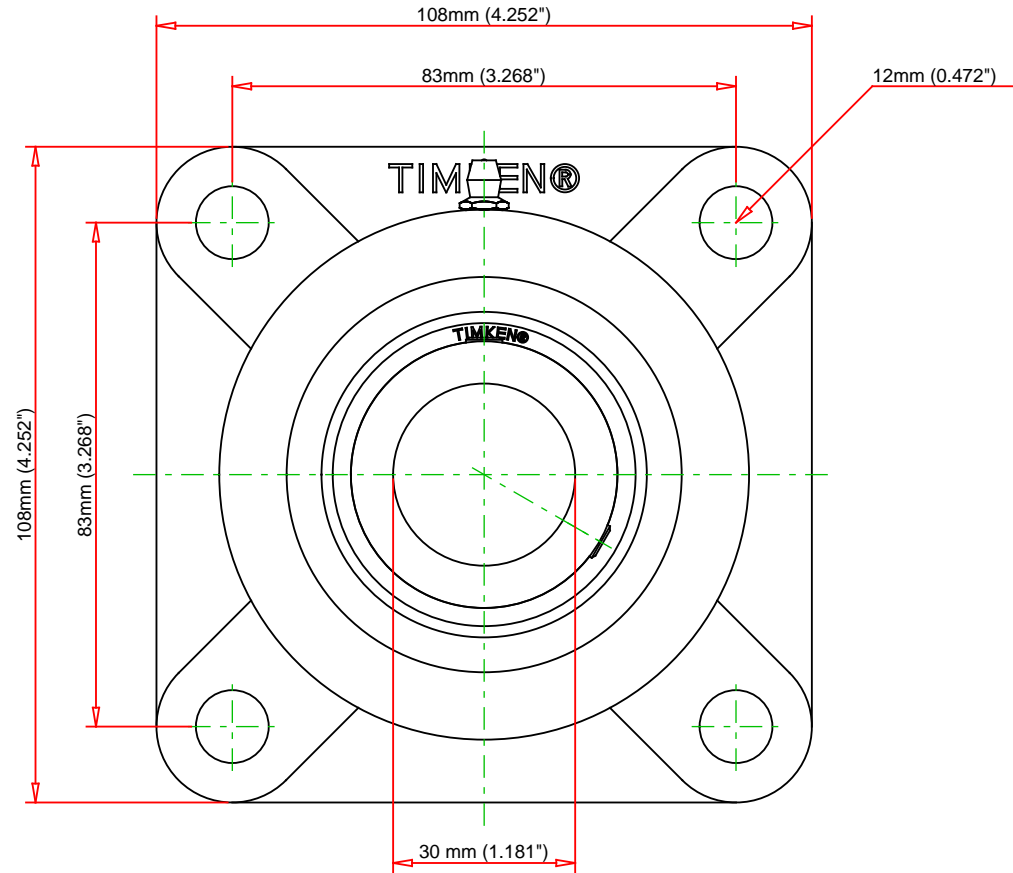
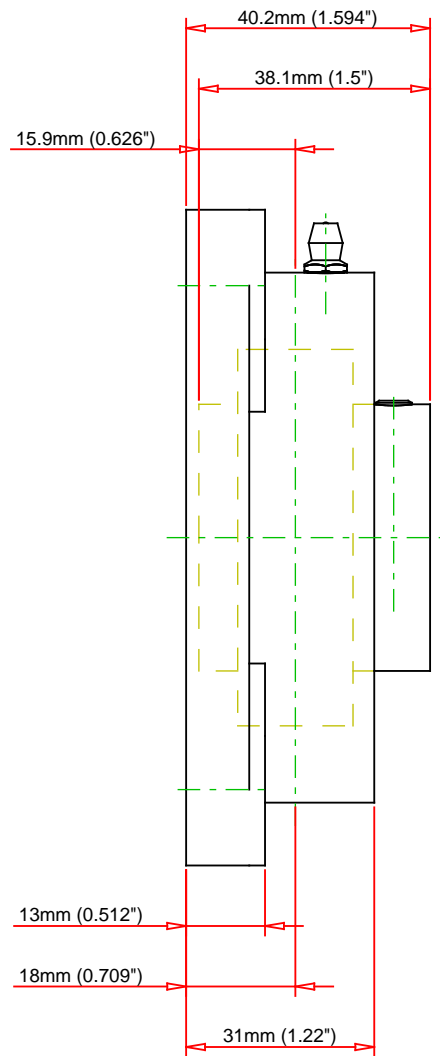

Bearing Number	UC206			
Load Ratings - C <sub>r</sub>	4385	lbf	19500	N
Load Ratings - C <sub>0r</sub>	2540	lbf	11300	N
Weight	2.6	lb	1.2	kg
Bolt Size	M10			

**TIMKEN**

THE TIMKEN COMPANY  
NORTH CANTON, OHIO USA

**UCF206**

UCF 200 Four-Bolt Flanged Housed Units  
- Set Screw Locking

Every reasonable effort has been made to ensure the accuracy of the information contained in this writing, but no liability is accepted for errors, omissions or for any other reason.

**FOR DISCUSSION ONLY**