



Figure similar

TEMPERATURE MONITORING RELAY  
THERMOCOUPLE TYP J, EXCEEDING 2 THRESH.  
VAL., WIDTH 22ND5 MM 0 C - 200 C, 24V AC/DC 1  
NO+1 W, LOAD + CL.-CIRC.CURR. CAGE-CLAMP -  
CONNECTION

General technical data:



<b>Type of voltage</b>		AC/DC
<b>Supply voltage frequency</b>		
<ul style="list-style-type: none"> <li>• 1 for auxiliary and control current circuit</li> <li>— Initial rated value</li> <li>— Final rated value</li> </ul>	Hz	50
	Hz	60
<b>Control supply voltage 1 with AC at 50 Hz</b>		
<ul style="list-style-type: none"> <li>• Rated value</li> </ul>	V	24
<b>Control supply voltage 1 with AC at 60 Hz</b>		
<ul style="list-style-type: none"> <li>• Rated value</li> </ul>	V	24
<b>Control supply voltage 1 for DC</b>		
<ul style="list-style-type: none"> <li>• Rated value</li> </ul>	V	24
<b>Product function</b>		
<ul style="list-style-type: none"> <li>• Fault storage</li> <li>• External reset</li> </ul>		No
		No
<b>Number of measuring circuits</b>		1
<b>Number of NC contacts for auxiliary contacts</b>		0
<b>Number of NO contacts for auxiliary contacts</b>		1
<b>Number of CO contacts for auxiliary contacts</b>		1
<b>Measurable temperature</b>		
<ul style="list-style-type: none"> <li>• initial value</li> <li>• Full-scale value</li> </ul>	°C	0
	°C	200
<b>Equipment marking acc. to DIN EN 61346-2</b>		K
<b>Equipment marking acc. to DIN 40719 extended according to IEC 204-2 acc. to IEC 750</b>		K

Ambient temperature during operation	°C	-25 ... +60
--------------------------------------	----	-------------

#### Mechanical data:

<b>Type of electrical connection</b>		spring-loaded terminals
<ul style="list-style-type: none"> <li>• for auxiliary and control current circuit</li> <li>• Plug-in socket</li> </ul>		Yes
<b>Design of the sensor connectable</b>		type J (thermocouple)
<b>Width</b>	mm	22.5
<b>Height</b>	mm	103
<b>Depth</b>	mm	91

#### Certificates/ approvals:

General Product Approval	Test Certificates	other			
 CCC	 EAC	 UL	<a href="#">Special Test Certificate</a>	<a href="#">Environmental Confirmations</a>	<a href="#">Declaration of Conformity</a>

#### Further information

##### Information- and Downloadcenter (Catalogs, Brochures,...)

<http://www.siemens.com/industrial-controls/catalogs>

##### Industry Mall (Online ordering system)

<http://www.siemens.com/industrymall>

##### Cax online generator

<http://support.automation.siemens.com/WW/CAXorder/default.aspx?lang=en&mlfb=3RS11202DD20>

##### Service&Support (Manuals, Certificates, Characteristics, FAQs,...)

<http://support.automation.siemens.com/WW/view/en/3RS11202DD20/all>

##### Image database (product images, 2D dimension drawings, 3D models, device circuit diagrams, EPLAN macros, ...)

<http://www.automation.siemens.com/bilddb/index.aspx?attID9=3RS11202DD20&lang=en>

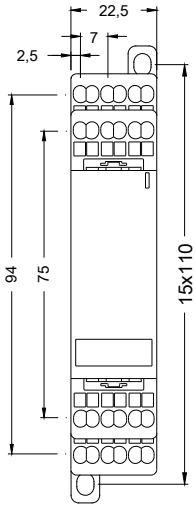

last modified:

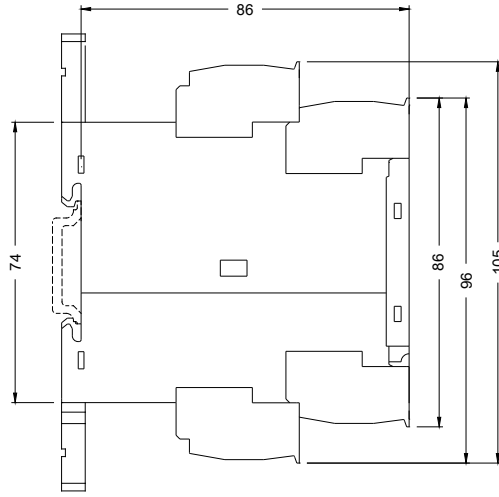

09.03.2015