

Rotary DIP Switch

BCD 4+1



FEATURES:

SPECIFICATION:

Switching type	BCD
Pins	4+1
Pitch	2.54 mm
Actuation	above
Switching capacity	0.5 A@ 24 VDC
Contact resistance	<100 mΩ
Contact material	Gold-plated
Test voltage	300 VAC
Temperature range	-10...+70 °C

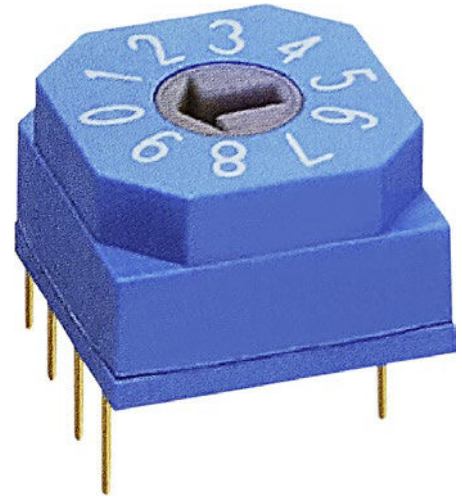

Art. Nr.

RND 210-00110

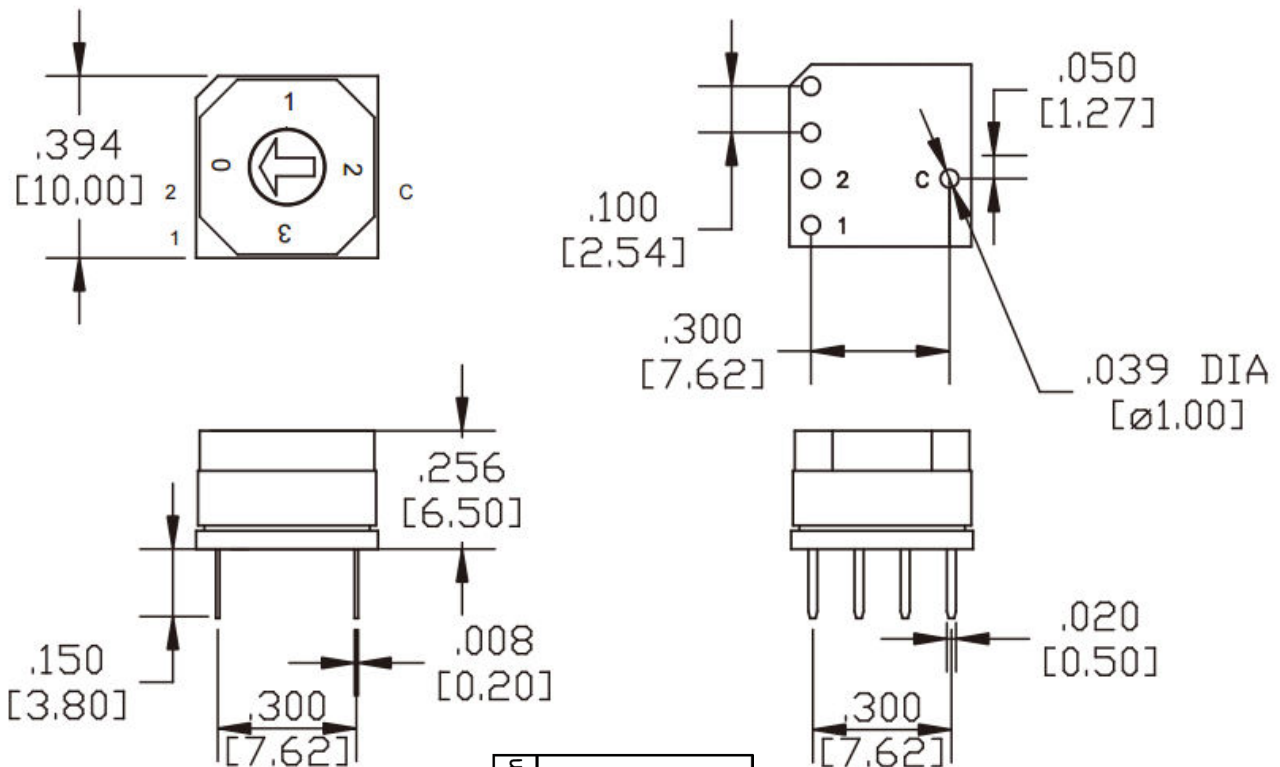

Position	Common C contacted ●				
	1	2	4	8	C
0					●
1	●				●
2		●			●
3	●	●			●
4			●		●
5	●		●		●
6		●	●		●
7	●	●	●		●
8				●	●
9	●			●	●