





Labeling plate for Potentiometer, label black, lettering white, with inscription: 0 to 10



Figure similar

<b>Product brand name</b>	SIRIUS ACT
<b>Product designation</b>	Labeling plate
<b>Design of the product</b>	for potentiometers
<b>Product type designation</b>	3SU1
<b>General technical data</b>	
<b>Protection class IP</b>	IP66, IP67, IP69(IP69K)
<b>Shock resistance</b>	Category 1, Class B
<ul style="list-style-type: none"> <li>• for railway applications acc. to DIN EN 61373</li> </ul>	
<b>Vibration resistance</b>	Category 1, Class B
<ul style="list-style-type: none"> <li>• for railway applications acc. to DIN EN 61373</li> </ul>	
<b>Accessories</b>	
<b>Material of accessory</b>	Plastic
<b>Mounting type of label</b>	without
<b>Marking of the name plate for command devices</b>	SYMBOL: 0 ... 10 (for potentiometer)
<b>Shape of the name plate for command devices</b>	round
<b>Color of the label</b>	black/white (plate/text)
<b>Printed ISO symbols</b>	SYMBOL: 0 ... 10 (for potentiometer)

## Certificates/approvals

General Product Approval		Declaration of Conformity	Test Certificates		
 CSA	 UL		 EG-Konf.	<a href="#">Declaration of the Compliance with the order</a>	<a href="#">Special Test Certificate</a>

## other

[Confirmation](#)

## Further information

### Information- and Downloadcenter (Catalogs, Brochures,...)

<http://www.siemens.com/industrial-controls/catalogs>

### Industry Mall (Online ordering system)

<https://mall.industry.siemens.com/mall/en/en/Catalog/product?mlfb=3SU1900-0BG16-0SA0>

### Cax online generator

<http://support.automation.siemens.com/WW/CAXorder/default.aspx?lang=en&mlfb=3SU1900-0BG16-0SA0>

### Service&Support (Manuals, Certificates, Characteristics, FAQs,...)

<https://support.industry.siemens.com/cs/ww/en/ps/3SU1900-0BG16-0SA0>

### Image database (product images, 2D dimension drawings, 3D models, device circuit diagrams, EPLAN macros, ...)

[http://www.automation.siemens.com/bilddb/cax\\_de.aspx?mlfb=3SU1900-0BG16-0SA0&lang=en](http://www.automation.siemens.com/bilddb/cax_de.aspx?mlfb=3SU1900-0BG16-0SA0&lang=en)

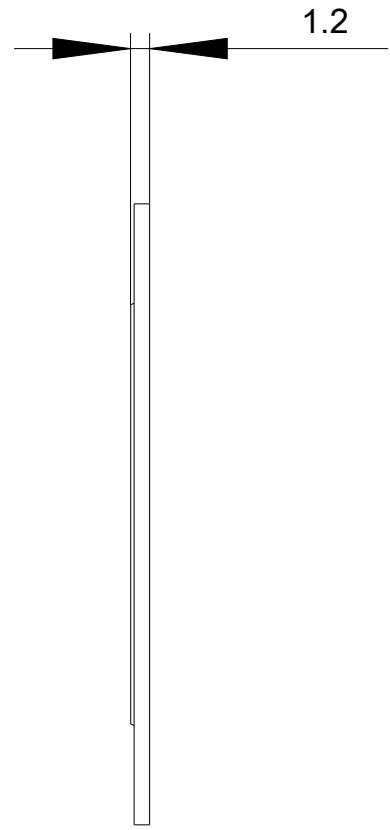
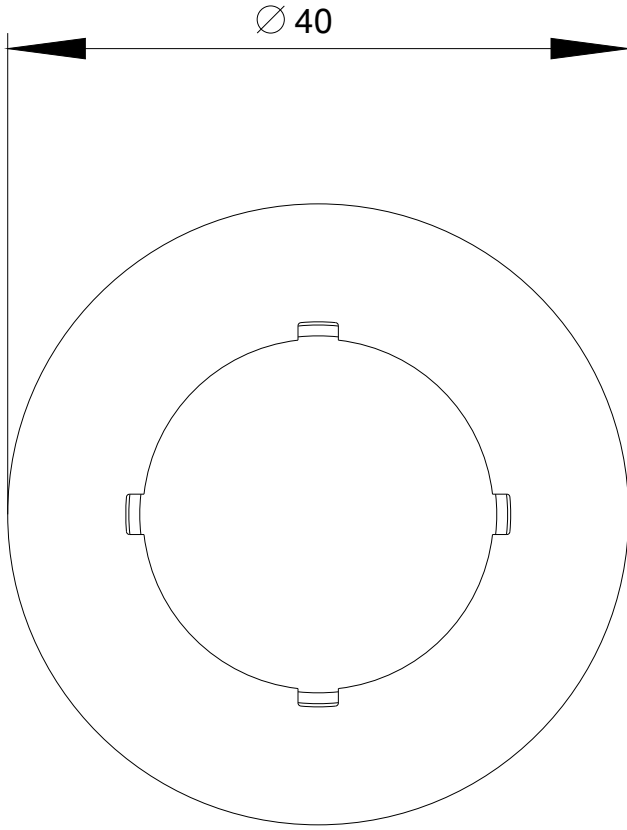

last modified:

09/25/2017