

## GAI-NPT Female connector

Female NPT thread (SAE 476) / EO 24° cone end

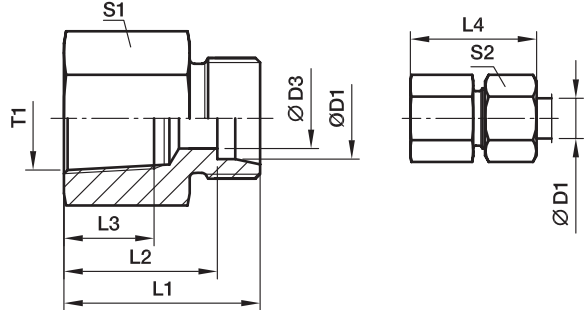

Series	D1	T1	D3	L1	L2	L3	L4	S1	S2	Weight g/1 piece	Order code*	PN (bar) <sup>1)</sup>	
												CF	71
L <sup>3)</sup>	06	1/8-27 NPT	4	26.0	19.0	11.6	34	14	14	19	<b>GAI06L1/8NPT</b>	315	315
	06	1/4-18 NPT	4	30.5	23.5	16.4	38	19	14	38	<b>GAI06L1/4NPT</b>	315	315
	08	1/4-18 NPT	6	30.5	23.5	16.4	38	19	17	39	<b>GAI08L1/4NPT</b>	315	315
	10	1/4-18 NPT	8	31.0	24.0	16.4	39	19	19	40	<b>GAI10L1/4NPT</b>	315	315
	12	3/8-18 NPT	10	34.0	27.0	17.4	42	24	22	69	<b>GAI12L3/8NPT</b>	315	315
	12	1/2-14 NPT	10	39.0	32.0	22.6	47	27	22	91	<b>GAI12L1/2NPT</b>	315	315
	15	1/2-14 NPT	12	40.0	33.0	22.6	48	27	27	96	<b>GAI15L1/2NPT</b>	315	315
	18	1/2-14 NPT	15	40.0	32.5	22.6	49	27	32	99	<b>GAI18L1/2NPT</b>	315	315
	22	3/4-14 NPT	19	43.0	35.5	23.1	52	36	36	184	<b>GAI22L3/4NPT</b>	160	160
	28	1-11.5 NPT	24	48.0	40.5	27.8	57	41	41	238	<b>GAI28L1NPT</b>	160	160
	35	1 1/4-11.5 NPT	30	51.0	40.5	28.3	62	55	50	424	<b>GAI35L11/4NPT</b>	160	160
	42	1 1/2-11.5 NPT	36	53.0	42.0	28.3	65	60	60	547	<b>GAI42L11/2NPT</b>	160	160
S <sup>4)</sup>	06	1/8-27 NPT	4	29.0	22.0	11.6	36	14	17	25	<b>GAI06S1/8NPT</b>	400	400
	06	1/4-18 NPT	4	33.0	26.0	16.4	41	19	17	41	<b>GAI06S1/4NPT</b>	400	400
	08	1/4-18 NPT	5	33.0	26.0	16.4	41	19	19	42	<b>GAI08S1/4NPT</b>	400	400
	10	3/8-18 NPT	7	35.0	27.0	17.4	44	24	22	74	<b>GAI10S3/8NPT</b>	400	400
	12	1/4-18 NPT	8	32.5	25.0	16.4	41	22	24	81	<b>GAI12S1/4NPT</b>	400	400
	12	3/8-18 NPT	8	35.0	27.5	17.4	44	24	24	76	<b>GAI12S3/8NPT</b>	400	400
	12	1/2-14 NPT	8	41.0	33.5	22.6	50	27	24	101	<b>GAI12S1/2NPT</b>	400	400
	14	1/2-14 NPT	10	43.0	35.0	22.6	53	27	27	108	<b>GAI14S1/2NPT</b>	400	400
	16	1/2-14 NPT	12	43.0	34.5	22.6	50	27	30	111	<b>GAI16S1/2NPT</b>	400	400
	20	1/2-14 NPT	16	44.0	33.5	22.6	55	32	36	129	<b>GAI20S1/2NPT</b>	315	315
	20	3/4-14 NPT	16	46.0	35.5	23.1	57	36	36	214	<b>GAI20S3/4NPT</b>	315	315
	25	1-11.5 NPT	20	53.0	41.0	27.8	65	41	46	288	<b>GAI25S1NPT</b>	315	315
	30	1 1/4-11.5 NPT	25	57.0	43.5	28.3	70	55	50	559	<b>GAI30S11/4NPT</b>	315	315
	38	1 1/2-11.5 NPT	32	59.0	43.0	28.3	74	60	60	632	<b>GAI38S11/2NPT</b>	250	250

<sup>1)</sup> Pressure shown = item deliverable

<sup>3)</sup> L = light series; <sup>4)</sup> S = heavy series

$\frac{\text{PN (bar)}}{10} = \text{PN (MPa)}$

Delivery without nut and ring. Information on ordering complete fittings see page I7.

\*Please add the **suffixes** below according to the material/surface required.

Order code suffixes		
Material	Suffix surface and material	Example
Steel, zinc plated, Cr(VI)-free	CFX	GAI16S1/2NPTCFX
Stainless Steel	71X	GAI16S1/2NPT71X