

LL grade
Compact low-voltage type
For professional power supplies

Construction

- Charge-discharge proof, polar
- Aluminum case with insulating sleeve
- Poles with screw terminal connections
- Mounting with ring clips, clamps or threaded stud
- The bases of types with threaded stud are not insulated

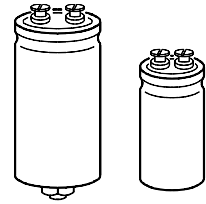

KAL0272-T

B 41 580 B 41 560

Features

- High reliability, extremely good electrical characteristics
- High *CU* product, i. e. extremely compact
- High ripple current capability
- All-welded construction ensures reliable electrical contact
- Type with optimized construction for base cooling upon request
- Type with low inductance design upon request

Applications

- General industrial electronics
- Professional power supplies
- For link circuits in converters

Specifications and characteristics in brief

Rated voltage U_R	25 to 100 V-
Surge voltage U_S	$1,15 \cdot U_R$
Rated capacitance C_R	1 500 to 330 000 μ F
Capacitance tolerance	$\pm 20 \% \triangleq M$
Useful life	
40 °C, U_R	> 250 000 h ($2,2 \cdot I_{R,105}^\sim$)
85 °C, $U_R, I_{R,max}^\sim$	> 6 000 h
105 °C, $U_R, I_{R,105}^\sim$	> 3 000 h
Failure percentage	$\leq 1 \%$ (during useful life)
Failure rate	≤ 40 fit ($\leq 40 \cdot 10^{-9}/h$)
Voltage endurance test	2 000 h, 105 °C (at U_R)
Leakage current I_{lka} (5 min, 20 °C)	$I_{lka} \leq 0,3 \mu A \cdot \left(\frac{C_R}{\mu F} \cdot \frac{U_R}{V} \right)^{0,7} + 4 \mu A$
Self-inductance L_{ESL}	approx. 20 nH
IEC climatic category	in accordance with IEC 68-1 40/105/56 (-40 °C/+105 °C, 56 days damp heat test)

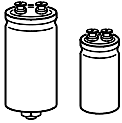
B 41 560
B 41 580

Specifications and characteristics in brief

Detail specification	similar to CECC 30 301-810
Sectional specification	IEC 384-4
Vibration resistance	in accordance with IEC 68-2-6, test Fc: displacement amplitude 0,75 mm, frequency range 10 to 55 Hz, acceleration max. 10 g, duration 3 × 2 h

Due to the current load capability of the contact elements, the following current upper limits must not be exceeded.

Capacitor diameter	≤ 51,6 mm	64,3 mm	76,9 mm
$I_{\sim rms}$	30 A	40 A	50 A

Accessories

The following items are included in the delivery package, but are not fastened to the capacitors:

	Thread	Toothed washers	Screws/Nuts	Maximum torque
For terminals	M 5	A 5,1 DIN 6797	Cylinder-head screw M 5 × 8 DIN 84-4.8	2 Nm
	M 6	A 6,4 DIN 6797	Cylinder-head screw M 6 × 12 DIN 85-4.8	2,5 Nm
For mounting	M 8	J 8,2 DIN 6797	Hex nut BM 8 DIN 439	4 Nm
	M 12	J 12,5 DIN 6797	Hex nut BM 12 DIN 439	10 Nm

The following must be ordered separately:

Ring clips

B 44 030 (cf. page 137)

Clamps for capacitors with $d \geq 64,3$ mm

B 44 030 (cf. page 141)

Insulating parts

B 44 020 (cf. page 134)

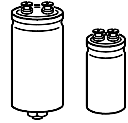
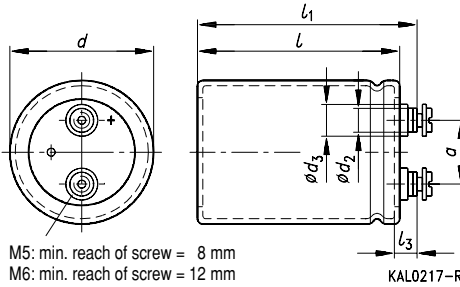
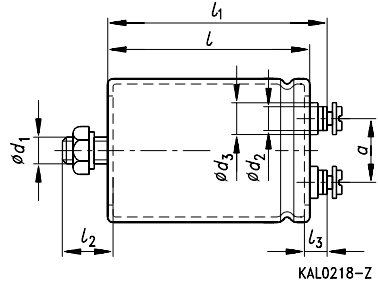
Dimensional drawings
Type B 41 560
 Ring clip/clamp mounting

Type B 41 580
 Threaded stud mounting

Positive pole marking: +

Screw terminals with UNF threads are available upon request.

Ter- minal	Dimensions (mm) with insulating sleeve										Approx. wt. (g)
	<i>d</i>	$l \pm 1$	$l_1 \pm 1$	$l_2 \begin{smallmatrix} +0 \\ -1 \end{smallmatrix}$	l_3	d_1	$d_2 \text{ max}$	$d_3 \text{ max}$	$a \begin{smallmatrix} +0,2 \\ -0,4 \end{smallmatrix}$		
M 5	35,7+ 0/- 0,8	55,7	62,2	13	7,0+ 0,2/- 1	M 8	8,2	13,5	12,7	65	
M 5	35,7+ 0/- 0,8	80,7	87,2	13	7,0+ 0,2/- 1	M 8	8,2	13,5	12,7	105	
M 5	35,7+ 0/- 0,8	105,7	112,2	13	7,0+ 0,2/- 1	M 8	8,2	13,5	12,7	135	
M 5	51,6+ 0/- 0,8	80,7	87,2	17	7,0+ 0,2/- 1	M 12	8,2	13,5	22,2	220	
M 5	51,6+ 0/- 0,8	105,7	112,2	17	7,0+ 0,2/- 1	M 12	8,2	13,5	22,2	280	
M 5	64,3+ 0/- 0,8	105,7	112,2	17	7,0+ 0,2/- 1	M 12	8,2	13,5	28,5	440	
M 6	76,9+ 0/- 0,7	105,7	111,5	17	6,4+ 1,1/- 0,8	M 12	17,7	17,7	31,7	540	
M 6	76,9+ 0/- 0,7	143,2	149,0	17	6,4+ 1,1/- 0,8	M 12	17,7	17,7	31,7	840	

Packing units

Capacitor diameter <i>d</i>	Packing units (pieces)
35,7 mm	72
51,6 mm	36
64,3 mm	20
76,9 mm	16

B 41 560
B 41 580
Overview of available types

U_R (V-)	25	40	63	100
C_R (μ F)	Case dimensions $d \times l$ (mm)			
1500				35,7 × 55,7
2 200				35,7 × 80,7
3 300				35,7 × 80,7
4 700			35,7 × 55,7	35,7 × 105,7
6 800			35,7 × 80,7	51,6 × 80,7
10 000		35,7 × 55,7	35,7 × 105,7	51,6 × 105,7
15 000	35,7 × 55,7	35,7 × 80,7	51,6 × 80,7	64,3 × 105,7
22 000	35,7 × 80,7	35,7 × 105,7	51,6 × 105,7	76,9 × 105,7
33 000	35,7 × 80,7	51,6 × 80,7	64,3 × 105,7	76,9 × 143,2
47 000	35,7 × 105,7	51,6 × 105,7	64,3 × 105,7	
68 000	51,6 × 80,7	51,6 × 105,7	76,9 × 105,7	
100 000	51,6 × 105,7	64,3 × 105,7	76,9 × 143,2	
150 000	64,3 × 105,7	76,9 × 105,7		
220 000	76,9 × 105,7	76,9 × 143,2		
330 000	76,9 × 143,2			

The capacitance and voltage ratings listed above are available in different cases upon request. Other voltage and capacitance ratings are also available upon request.

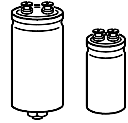
Technical data and ordering codes

U_R	C_R	Case dimensions $d \times l$ mm	$R_{ESR, max}$ 100 Hz 20 °C mΩ	Z_{max} 10 kHz 20 °C mΩ	$I_{~max}$ 100 Hz 40 °C A	$I_{~max}$ 100 Hz 85 °C A	$I_{~R}$ 100 Hz 105 °C A	Ordering code ¹⁾ Short code
V-	μF							
B41560-, B41580-								
25	15 000	35,7 × 55,7	42	31	18	11	5,3	-A5159-M
	22 000	35,7 × 80,7	29	22	25	15	7,4	-A5229-M
	33 000	35,7 × 80,7	20	17	30	18	8,8	-A5339-M
	47 000	35,7 × 105,7	16	13	30	23	11	-A5479-M
	68 000	51,6 × 80,7	12	9,3	30	26	13	-A5689-M
	100 000	51,6 × 105,7	9,4	7,6	30	30	15	-A5100-M
	150 000	64,3 × 105,7	8,0	6,4	40	38	18	-A5150-M
	220 000	76,9 × 105,7	7,0	5,6	50	40	20	-A5220-M
	330 000	76,9 × 143,2	6,4	5,1	50	50	24	-A5330-M
40	10 000	35,7 × 55,7	42	37	18	11	5,3	-A7109-M
	15 000	35,7 × 80,7	29	26	25	15	7,4	-A7159-M
	22 000	35,7 × 105,7	22	20	30	20	9,5	-A7229-M
	33 000	51,6 × 80,7	15	13	30	23	11	-A7339-M
	47 000	51,6 × 105,7	12	10	30	29	14	-A7479-M
	68 000	51,6 × 105,7	10	8,4	30	30	15	-A7689-M
	100 000	64,3 × 105,7	8,2	7,0	40	38	18	-A7100-M
	150 000	76,9 × 105,7	7,2	6,0	50	41	20	-A7150-M
	220 000	76,9 × 143,2	6,4	5,4	50	49	24	-A7220-M
63	4 700	35,7 × 55,7	60	64	15	9,2	4,4	-A8478-M
	6 800	35,7 × 80,7	44	46	20	12	6,0	-A8688-M
	10 000	35,7 × 105,7	30	33	28	17	8,1	-A8109-M
	15 000	51,6 × 80,7	22	21	30	19	9,1	-A8159-M
	22 000	51,6 × 105,7	16	16	30	25	12	-A8229-M
	33 000	64,3 × 105,7	12	12	40	31	15	-A8339-M
	47 000	64,3 × 105,7	10	9,4	40	35	17	-A8479-M
	68 000	76,9 × 105,7	8,0	7,8	50	39	19	-A8689-M
	100 000	76,9 × 143,2	6,6	6,6	50	48	23	-A8100-M

1) To obtain the required ordering code, prefix the type number to the short code. E. g.: B41560-A5159-M
 B41560-... (ring clip/clamp mounting)
 B41580-... (with threaded stud)

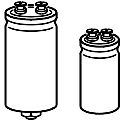

B 41 560
B 41 580
Technical data and ordering codes

U_R	C_R	Case dimensions $d \times l$ mm	$R_{ESR, \max}$ 100 Hz 20 °C mΩ	Z_{\max} 10 kHz 20 °C mΩ	$I_{\sim \max}$ 100 Hz 40 °C A	$I_{\sim \max}$ 100 Hz 85 °C A	I_{-R} 100 Hz 105 °C A	Ordering code ¹⁾ Short code
-------	-------	---------------------------------------	--	-------------------------------------	---	---	-----------------------------------	---

B41560-, B41580-

100	1 500	35,7 × 55,7	104	90	11	7,0	3,4	-A9158-M
	2 200	35,7 × 80,7	70	77	16	9,9	4,7	-A9228-M
	3 300	35,7 × 80,7	48	53	19	12	5,7	-A9338-M
	4 700	35,7 × 105,7	35	39	26	16	7,5	-A9478-M
	6 800	51,6 × 80,7	24	25	30	18	8,7	-A9688-M
	10 000	51,6 × 105,7	17	18	30	24	11	-A9109-M
	15 000	64,3 × 105,7	13	14	40	30	15	-A9159-M
	22 000	76,9 × 105,7	10	11	50	35	17	-A9229-M
	33 000	76,9 × 143,2	8,0	8,4	50	44	21	-A9339-M

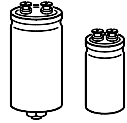
1) To obtain the required ordering code, prefix the type number to the short code. E. g.: B41560-A9158-M
 B41560-... (ring clip/clamp mounting)
 B41580-... (with threaded stud)



Useful life

versus ambient temperature T_A under ripple current operating conditions¹⁾

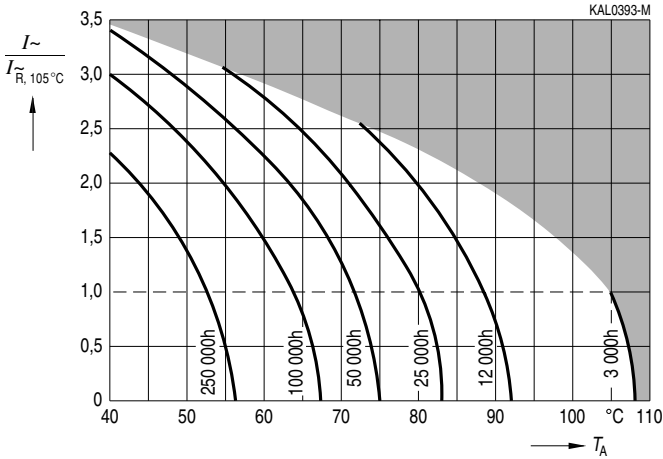

Permissible ripple current I_{\sim} versus frequency f

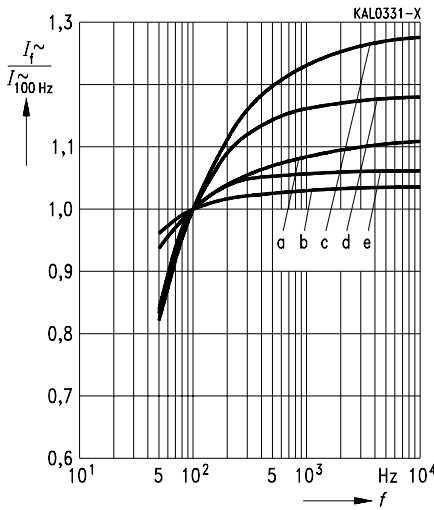

d (mm)	35,7	51,6	64,3	76,9
≤ 63 V-	a	a	a	b
100 V-	c	d	d	e

1) Refer to [page 31](#) for an explanation on how to interpret the useful life graphs.

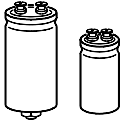

B 41 560

B 41 580

Equivalent series resistance R_{ESR}

versus frequency f

Typical behavior

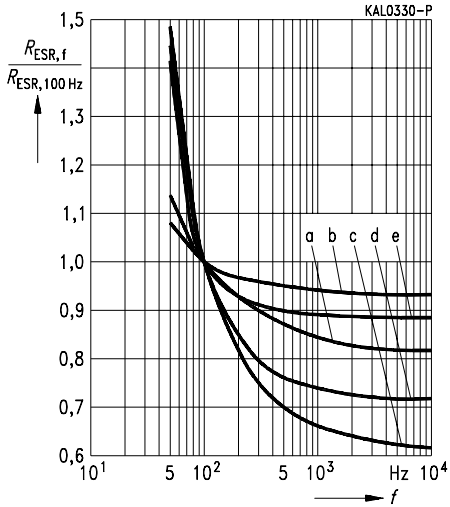

d (mm)	35,7	51,6	64,3	76,9
≤ 63 V-	a	a	a	b
100 V-	c	d	d	e

Impedance Z

versus frequency f

Typical behavior

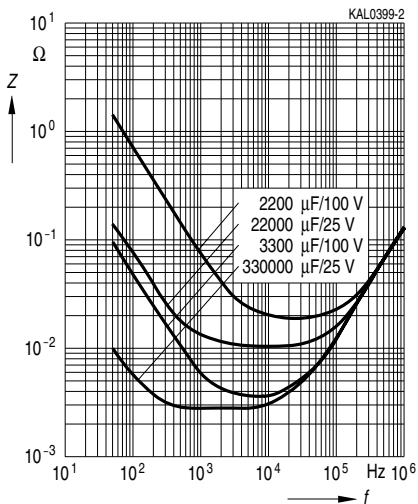

Herausgegeben von EPCOS AG

Marketing Kommunikation, Postfach 80 17 09, 81617 München, DEUTSCHLAND

© EPCOS AG 2000. Alle Rechte vorbehalten. Vervielfältigung, Veröffentlichung, Verbreitung und Verwertung dieser Broschüre und ihres Inhalts ohne ausdrückliche Genehmigung der EPCOS AG nicht gestattet.

Mit den Angaben in dieser Broschüre werden die Bauelemente spezifiziert, keine Eigenschaften zugesichert. Bestellungen unterliegen den vom ZVEI empfohlenen Allgemeinen Lieferbedingungen für Erzeugnisse und Leistungen der Elektroindustrie, soweit nichts anderes vereinbart wird.

Diese Broschüre ersetzt die vorige Ausgabe.

Fragen über Technik, Preise und Liefermöglichkeiten richten Sie bitte an den Ihnen nächstgelegenen Vertrieb der EPCOS AG oder an unsere Vertriebsgesellschaften im Ausland.

Bauelemente können aufgrund technischer Erfordernisse Gefahrstoffe enthalten. Auskünfte darüber bitten wir unter Angabe des betreffenden Typs ebenfalls über die zuständige Vertriebsgesellschaft einzuholen.

Published by EPCOS AG

Marketing Communications, P.O. Box 80 17 09, 81617 Munich, GERMANY

© EPCOS AG 2000. All Rights Reserved. Reproduction, publication and dissemination of this brochure and the information contained therein without EPCOS' prior express consent is prohibited.

The information contained in this brochure describes the type of component and shall not be considered as guaranteed characteristics. Purchase orders are subject to the General Conditions for the Supply of Products and Services of the Electrical and Electronics Industry recommended by the ZVEI (German Electrical and Electronic Manufacturers' Association), unless otherwise agreed.

This brochure replaces the previous edition.

For questions on technology, prices and delivery please contact the Sales Offices of EPCOS AG or the international Representatives.

Due to technical requirements components may contain dangerous substances. For information on the type in question please also contact one of our Sales Offices.