



Figure similar

TEMPERATURE MONITORING RELAY
THERMOELEMENT J, T, E, K, N 2 THRESHOLD
VALUES, DIGITAL -99 DEG. F TO 1830 DEG. F 24-240
V AC/DC 2 X 1 CO + 1 NO, WIDTH 45 MM SPRING-
TYPE TERMINAL

General technical data:



Type of voltage		AC/DC
Supply voltage frequency		
<ul style="list-style-type: none"> • 1 for auxiliary and control current circuit <ul style="list-style-type: none"> — Initial rated value — Final rated value 	Hz	50
	Hz	60
Control supply voltage		
<ul style="list-style-type: none"> • 1 <ul style="list-style-type: none"> — with AC <ul style="list-style-type: none"> — at 50 Hz Initial rated value — at 50 Hz Final rated value — at 60 Hz Initial rated value — at 60 Hz Final rated value — for DC <ul style="list-style-type: none"> — Initial rated value — Final rated value 	V	24
	V	240
	V	24
	V	240
	V	24
	V	240
Number of measuring circuits		1
Number of NC contacts for auxiliary contacts		0
Number of NO contacts for auxiliary contacts		1
Number of CO contacts for auxiliary contacts		2
Product function		
<ul style="list-style-type: none"> • Fault storage • External reset 		Yes
		Yes
Measurable Fahrenheit-temperature		
<ul style="list-style-type: none"> • initial value 	°F	-99

• Full-scale value	°F	1 830
Equipment marking acc. to DIN EN 61346-2		K
Equipment marking acc. to DIN 40719 extended according to IEC 204-2 acc. to IEC 750		K
Ambient temperature during operation	°C	-25 ... +60

Mechanical data:

Type of electrical connection		
• for auxiliary and control current circuit		spring-loaded terminals
• Plug-in socket		Yes
Design of the sensor connectable		type J, K, T, E, N (thermocouple)
Width	mm	45
Height	mm	108
Depth	mm	91

Certificates/ approvals:

General Product Approval	Test Certificates	other	
		Special Test Certificate	Environmental Confirmations
			Declaration of Conformity

Further information

Information- and Downloadcenter (Catalogs, Brochures,...)

<http://www.siemens.com/industrial-controls/catalogs>

Industry Mall (Online ordering system)

<http://www.siemens.com/industrymall>

Cax online generator

<http://support.automation.siemens.com/WW/CAXorder/default.aspx?lang=en&mlfb=3RS21402GW60>

Service&Support (Manuals, Certificates, Characteristics, FAQs,...)

<http://support.automation.siemens.com/WW/view/en/3RS21402GW60/all>

Image database (product images, 2D dimension drawings, 3D models, device circuit diagrams, EPLAN macros, ...)

<http://www.automation.siemens.com/bilddb/index.aspx?attID9=3RS21402GW60&lang=en>

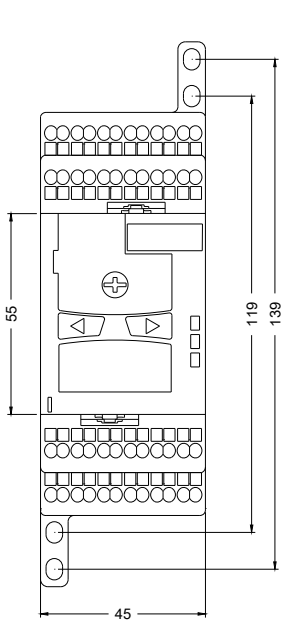

last modified:

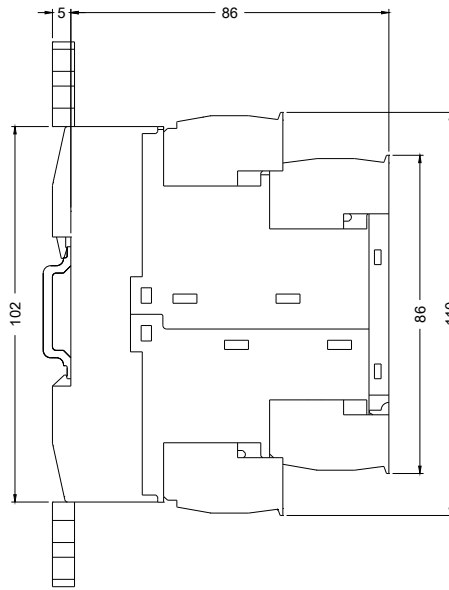

09.03.2015