



DIN7A SERIES

DIN7A-PP-C-GF-ST-CA3

DIN7A-J-P-GF-RA-BH1

DIN7A-J-P-GF-ST-TH1

75Ω DIN 1.0/2.3 COMPONENTS

SPECIFICATIONS

For complete specifications see www.samtec.com?DIN7A-TH, www.samtec.com?DIN7A-BH or www.samtec.com?DIN7A-CA

Shell Material:

Brass

Contact:

Copper Alloy

Insulator Material:

PTFE

Operating Temp Range:

-65°C to +125°C

Impedance:

75Ω

Frequency Range:

Testing Now! *

V.S.W.R.:

Testing Now!

Working Voltage:

250 Vrms

Dielectric Withstanding:

750 Vrms

Contact Resistance:

Center Contact: Testing Now!

Outer Contact: Testing Now!

Insulator Resistance:

Testing Now!

DIN7A — GENDER — TYPE — PLATING — ORIENTATION — TERMINATION

-J
= Jack

-P
= PCB Mount

-GF
= 10μ" (0,25μm) Gold center contact,
3μ" (0,08μm) Gold outer contact,
(100μ" (2,54μm) Nickel body
-RA only)

-ST
= Straight
(-TH1 only)

-RA
= Right Angle
(-BH1 only)

-TH1
= Through-hole
(-ST only)

-BH1
= Bulkhead Through-hole
(-RA only)

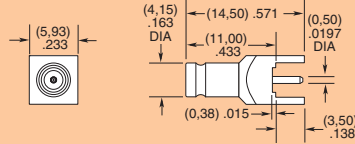

-ST-TH1

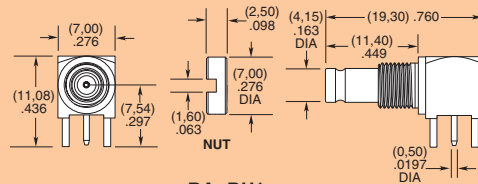

-RA-BH1

DIN7A — PP — TYPE — PLATING — ORIENTATION — TERMINATION

-PP
= Push Pull Plug

-C
= Cable

-GF
= 10μ" (0,25μm) Gold on contact,
Flash Gold on outer contact,
Nickel on shell

-ST
= Straight

-CA3
= RG 179 Cable

-CA6
= RG 6 or Belden 1694A Cable

-CA8
= Belden 1855A Cable

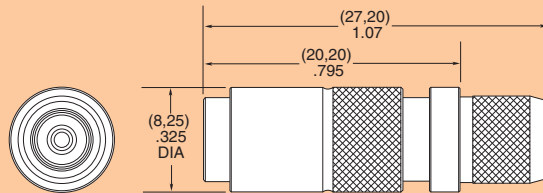

-CA6 SHOWN

* Designed to meet SMPTE 424M 3G SDI specification.

Supplied with pins and ferrules. See website for dimensions.

Due to technical progress, all designs, specifications and components are subject to change without notice.