

## M12 male receptacle A-cod. front mount incl. nut

wires 12x0.14 0,5m

Flange M12 male  
12-pole  
Front mounting  
Mounting nut  
with multi-strand wire

### [Link to Product](#)

#### Illustration

1	brown
2	blue
3	white
4	green
5	pink
6	yellow
7	black
8	gray
9	red
10	violet
11	gray/pink
12	red/blue

Male

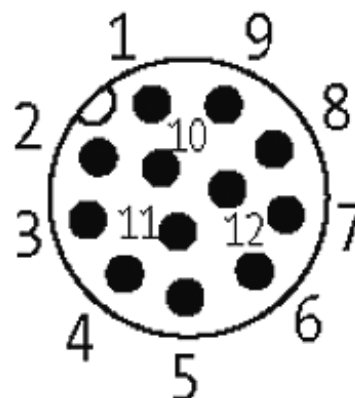

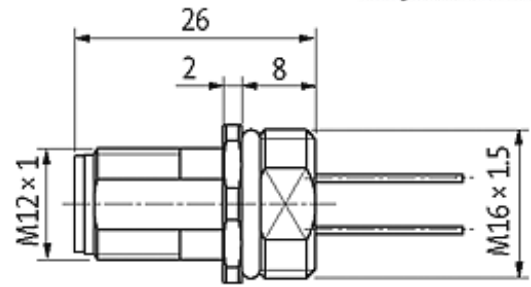
*stay connected*

Product may differ from Image

**Form**

19162

**Technical Data**

Operating voltage	max. 30 V AC/DC
Operating current per contact	max. 1.5 A
Locking of ports	Screw thread M12 × 1 mm (recommended torque 0.6 Nm) self-securing
Protection	IP67 inserted and tightened (EN 60529)

**Cables**

Cable number	979
No./diameter of wires	12 × 0.14 mm <sup>2</sup>
Wire isolation	PP (br, bl, wh, gn, pk, ye, bk, gr, rd, vi, grpk, rdbl)
Shore hardness outer jacket	74 ± 5D
Outer diameter	approx. 1.25 mm
Bend radius (fixed)	5 × outer Ø
Bend radius (moving)	15 × outer Ø
Temperature range (fixed)	-40...+85 °C
Temperature range (mobile)	-25...+85 °C

**Commercial data**

country of origin	DE
customs tariff number	85444290
minimum order quantity	1