



In über 40 Ländern
weltweit vertreten



HARTMANN

A Phoenix Mecano Company

Hartmann Codier GmbH • Industriestraße 3 • 91330 Baiersdorf
Tel: +49 (0)9133/7793-0 • Fax: +49 (0)9133/7793-36
email: info@hartmann-codier.de

WWW.HARTMANN-CODIER.DE

P25

Rotary Code Switch

- ▷ 2.5mm height
- ▷ 7.0mm length
- ▷ Lateral C-contact
- ▷ SMJ, SMT-Pins
- ▷ Contacts with hard gold plating
- ▷ Solid, tinned PCB pins

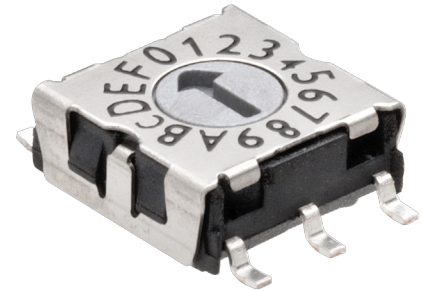

Technical Data

Height	2.5mm
Length	7.0mm
Width	7.0mm
Pin connection	3+3, lateral C-contact
Perm. ambient temperature	-50...+125°C
Perm. storage temperature	-55...+135°C
Torque	min. 0.7Ncm
Positions per rotation	10, 16
Operating voltage	≤42V
Contact load, static	≤0.4A
Contact load, dynamic	≤0.1A
Minimum load	1μA 20mV DC
Test voltage	250V 50Hz/1min
Contact resistance	<80mΩ
Insulation resistance	>100MΩ
Vibration, Shock	DIN EN 60068-2-6 DIN EN 60068-2-27
Humidity	21days at 40°C 93% RH
Reflow soldering max.	10s/260°C

Dimensions

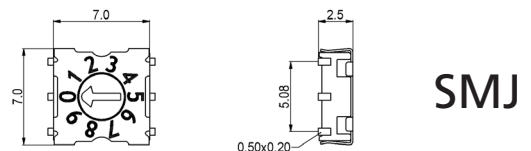

SMJ

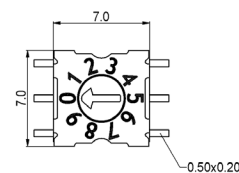
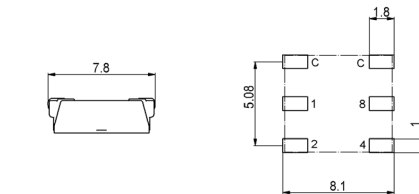

SMT

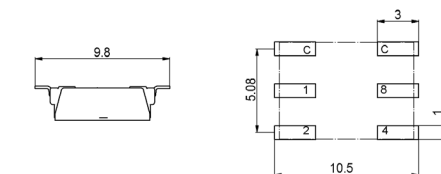

Life size



Represented worldwide in more than 40 countries

Hartmann Codier GmbH • Industriestraße 3 • 91330 Baiersdorf
 Tel: +49 (0)9133/7793-0 • Fax: +49 (0)9133/7793-36
 email: info@hartmann-codier.de



HARTMANN

A Phoenix Mecano Company

WWW.HARTMANN-CODIER.DE

P25 Rotary Code Switch

Features and Order Code

1

CONTACT PINS

SMT

Code: P25 **SMT** 2 3 4

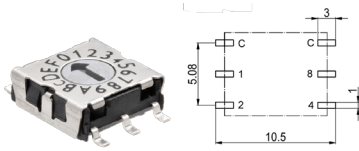

J-Hook

Code: P25 **SMJ** 2 3 4

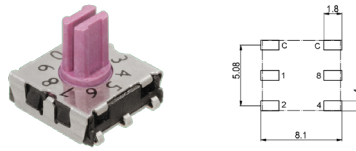

2

ACTUATORS

Arrow shaped slot

Code: P25 1 **1** 3 4

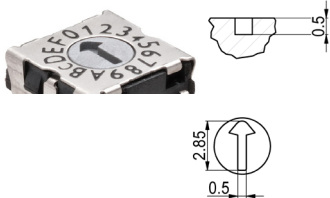

Spindle

Code: P25 1 **3** 3 4

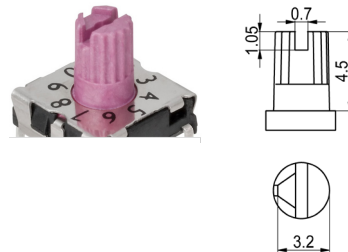

Slotted spindle

Code: P25 1 **8** 3 4

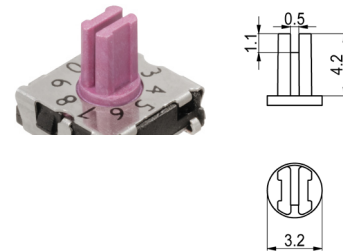

3

CODES

	Positions	Rotor	
BCD	10	red	Code: P25 1 2 01 4
BCD Complement	10	orange	Code: P25 1 2 02 4
Hexadecimal	16	gray	Code: P25 1 2 03 4
Hexadecimal Complement	16	white	Code: P25 1 2 06 4

4

Packing

Tape & Reel Packing

Code: P25 1 2 3 **TR**