



Model Number

NCN8-12GM35-Z5

Features

- 8 mm not embeddable
- 2-wire DC
- Increased operating distance

Connection

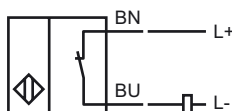

Accessories

BF 12

Mounting flange, 12 mm

Dimensions

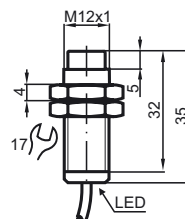

Technical Data

General specifications

Switching element function	DC	NC
Rated operating distance	s_n	8 mm
Installation	not embeddable	
Output polarity	DC	
Assured operating distance	s_a	0 ... 6.48 mm
Reduction factor r_{Al}	0.49	
Reduction factor r_{Cu}	0.49	
Reduction factor r_{303}	0.74	

Nominal ratings

Operating voltage	U_B	3.5 ... 30 V
Switching frequency	f	0 ... 750 Hz
Reverse polarity protected	leading	
Short-circuit protection	pulsing	
Voltage drop	U_d	≤ 3.5 V
Temperature drift	$\pm 15\%$	
Operating current	I_L	2 ... 100 mA
Off-state current	I_r	0.4 ... 0.6 mA typ. 0.5 mA
Indication of the switching state	LED, yellow	

Ambient conditions

Ambient temperature	-25 ... 70 °C (-13 ... 158 °F)
Storage temperature	-40 ... 85 °C (-40 ... 185 °F)

Mechanical specifications

Connection type	cable PVC, 2 m
Core cross-section	0.34 mm ²
Housing material	brass, nickel-plated
Sensing face	PBT
Protection degree	IP67

Compliance with standards and directives

Standard conformity	
Standards	EN 60947-5-2:2007 IEC 60947-5-2:2007

Approvals and certificates

UL approval	cULus Listed, General Purpose
CSA approval	cCSAus Listed, General Purpose
CCC approval	Products with a maximum operating voltage of ≤ 36 V do not bear a CCC marking because they do not require approval.