

## Grub Screws with Palm Grip · DIN 6335 plastic

24730.1209



### Product Description

#### Material

##### Handle

- DIN 7708 - thermosetting plastic (PF 31), black similar to RAL 9005

##### Screw

- Stainless steel A2

#### More information

##### Notes

Special types, e.g. differing lengths or threaded pins from brass / stainless steel on request.

### Drawing

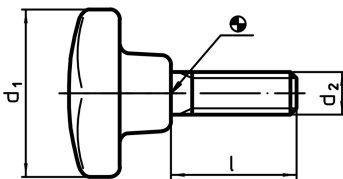

### Order information

Dimensions			max. [°C]	[g]	Art. No.
d <sub>1</sub>	d <sub>2</sub> [mm]	l			
form L, stainless steel					
50	M10	60	110	68	24730.1209

### Compliance

#### RoHS compliant

Compliant according to Directive 2011/65/EU and Directive 2015/863

#### Does not contain SVHC substances

No SVHC substances with more than 0.1% w/w contained - SVHC list [REACH] as of 10.06.2022

#### Does not contain Proposition 65 substances

No Proposition 65 substances included  
<https://www.P65Warnings.ca.gov/>

#### Free from Conflict Minerals

This product does not contain any substances designated as "conflict minerals" such as tantalum, tin, gold or tungsten from the Democratic Republic of Congo or adjacent countries.