

GN 162.3 | Connecting clamp bases

Aluminium



- 1
- 2
- 3
- 4
- 5
- 6
- 7
- 8
- 9
- 10
- 11
- 12
- 13
- 14
- 15
- 16
- 17
- 18

MATERIAL

Aluminium, matte finish.
AISI 304 stainless steel screw and nut.

STANDARD EXECUTIONS

- **GN 162.3-BL**: natural aluminium.
- **GN 162.3-SW**: aluminium, epoxy resin coating, RAL 9005 black colour.

FEATURES AND APPLICATIONS

The assembly hole of GN 162.3 connecting clamps allows an excellent match with tubes GN 990 (see page 1778).

The clamping screws d3 may be replaced by clamping kits GN 911 (see page 1782).

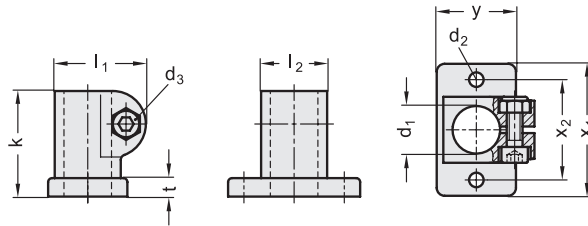
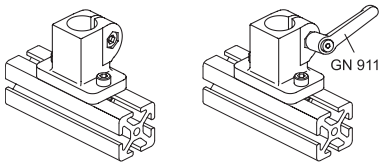

GN 162.3-BL

Code	Description	d1	d2	d3	k	l1	l2	t	x1	x2	y	d3 Clamping kit	⚖️
GN.48305	GN 162.3-B10-2-BL	10	5.5	M6	40	34.5	25	7	50	38	30	GN 911-M6-22	96
GN.48315	GN 162.3-B12-2-BL	12	5.5	M6	40	34.5	25	7	50	38	30	GN 911-M6-22	92
GN.48325	GN 162.3-B14-2-BL	14	5.5	M6	40	34.5	25	7	50	38	50	GN 911-M6-22	88
GN.48335	GN 162.3-B15-2-BL	15	5.5	M6	40	34.5	25	7	50	38	30	GN 911-M6-22	86
GN.48345	GN 162.3-B16-2-BL	16	5.5	M6	40	34.5	25	7	50	38	30	GN 911-M6-22	84
GN.48355	GN 162.3-B18-2-BL	18	5.5	M6	40	34.5	25	7	50	38	50	GN 911-M6-22	79

GN 162.3-SW

Code	Description	d1	d2	d3	k	l1	l2	t	x1	x2	y	d3 Clamping kit	⚖️
GN.48307	GN 162.3-B10-2-SW	10	5.5	M6	40	34.5	25	7	50	38	30	GN 911-M6-22	96
GN.48317	GN 162.3-B12-2-SW	12	5.5	M6	40	34.5	25	7	50	38	30	GN 911-M6-22	92
GN.48327	GN 162.3-B14-2-SW	14	5.5	M6	40	34.5	25	7	50	38	50	GN 911-M6-22	88
GN.48337	GN 162.3-B15-2-SW	15	5.5	M6	40	34.5	25	7	50	38	30	GN 911-M6-22	86
GN.48347	GN 162.3-B16-2-SW	16	5.5	M6	40	34.5	25	7	50	38	30	GN 911-M6-22	84
GN.48357	GN 162.3-B18-2-SW	18	5.5	M6	40	34.5	25	7	50	38	50	GN 911-M6-22	79

Connecting clamps