

# EAO – Your Expert Partner for Human Machine Interfaces

## 84-1201.0 - Illuminated pushbutton standard

### 84-1201.0 - Illuminated pushbutton standard



*Attention: The preview is based on a sample product. This can differ from your current configuration.*

#### Mounting

Mounting cut-out Ø 22,3 mm  
Design flush

#### Front

Front dimension Ø 25 mm  
Front shape round  
Front bezel colour black anodized  
Front bezel material Aluminium

#### Other Attributes

Weight 0,008 kg

#### Operating-/Indication part

Lens illumination illuminative

#### IP-Rating

Front protection IP67

#### Actuator

Switching action Momentary  
Housing colour black anodized  
Housing material Aluminium

#### Switching element

Switching system Short-travel element

#### Function

Illuminated pushbutton

# EAO – Your Expert Partner for Human Machine Interfaces

## 84-1201.0 - Illuminated pushbutton standard

### Dimensions

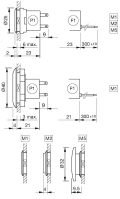

F1 = Flat ribbon cable

### Mounting cut-outs

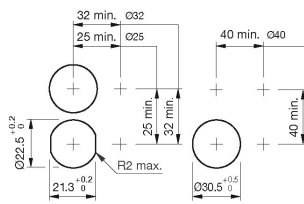

### Wiring diagram

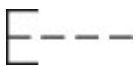

### Additional information

Illuminated lens, non-illuminated bezel

The colour of anodized aluminium parts can vary due to technical production reasons

### Legend

Switching action: B = Momentary