

# COMPRESSED AIR TANKS - STAINLESS STEEL AISI 304

Tanks without brackets in stainless steel AISI 304 for compressed air are supplied with Certificate of Conformity according to the directive about pressure equipment 2014/68/UE (PED) or tested in house, on the base of features of the tank.

**Keep the use and maintenance manual supplied together with each tank.**

On request it's possible to supply special tanks .



### Technical data

Capacity	1 - 100 lt
Thread	UNI - ISO 228/1
Fluid	compressed air / nitrogen / water
Max working pressure	see table below
Number of connections	2 or 4
Test / certificate	tested in house / 2014/68/UE (PED)
Material	Stainless steel AISI 304 20 Micron
External treatments	Crude

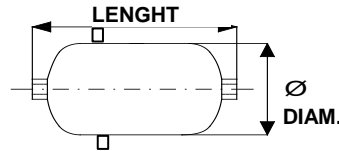

### TANKS AISI 304 - without brackets - TESTED IN HOUSE

CAPACITY MAX PRESSURE 11 BAR	CONNECTIONS		DIAMETER (mm)	LENGHT (mm)	BOTTOM THREAD	SHELL THREAD
1,3 litres	2 4	10 BAR	152	126	1/4"	- nr. 2 da 1/4"
3 litres	2 4	10 BAR	152	222	3/8"	- nr. 2 da 3/8"
5 litres	2 4	8 BAR	213	203	3/8"	- nr. 2 da 3/8"
8 litres	2 4	6 BAR	213	288	3/8"	- nr. 2 da 3/8"

### TANKS AISI 304 - without brackets - ACCORDING TO 2014/68/UE (PED)

CAPACITY	CONN.	PRESS.	DIAMETER (mm)	LENGHT (mm)	BOTTOM THREAD	SHELL THREAD
1,3 litres	2 4	11 BAR	152	126	1/4"	- nr. 2 da 1/4"
3 litres	2 4	11 BAR	152	222	3/8"	- nr. 2 da 3/8"
5 litres	2 4	11 BAR	213	203	3/8"	- nr. 2 da 3/8"
8 litres	2 4	11 BAR	213	288	3/8"	- nr. 2 da 3/8"

**BRACKET FOR TANKS**  
stainless steel

*(as fitting please use standard st. steel fitting 3/8")*

Technical sheets are available for every item/ Dimensions are indicative

# COMPRESSED AIR TANKS - STAINLESS STEEL AISI 304 / 316L

## HORIZONTAL TANKS

### Technical data

<b>Capacity</b>	10 - 1000 lt
<b>Thread</b>	UNI - ISO 228/1
<b>Fluid</b>	Compressed air / nitrogen / air and water
<b>Max working pressure</b>	11 BAR
<b>Test / certificate</b>	2014/68/UE (PED)
<b>Material</b>	st. steel AISI 304 -AISI 316L
<b>External treatments</b>	crude with internal/external treatment of pickling and passivation



## TANKS AISI 304 / AISI 316L ACCORDING TO 2014/68/UE - PED

CAPACITY MAX PRESSURE 11/12 BAR	VERSION	DIAMETER (mm)	LENGHT (mm)	BOTTOM THREAD	SHELL THREAD
10 liters	HORIZONTAL	169	506	1/2"	nr. 2 da 1/2"
15 liters	HORIZONTAL	196	624	1/2"	nr. 2 da 1/2"
24 liters	HORIZONTAL	240	634	1/2"	nr. 2 da 1/2"
50 liters	HORIZONTAL	305	784	1/2"	nr.2 da 3/8"
					nr. 1 da 1/2"
100 liters	HORIZONTAL	370	966	1/2"	nr. 2 da 3/8"
					nr. 1 da 1/2"
200 liters	HORIZONTAL	446	1364	1/2"	nr. 2 da 3/8"
					nr. 2 da 1/2"
270 liters	HORIZONTAL	500	1558	1/2"	nr.2 da 3/8"
					nr. 2 (1/2" + 1")
500 liters	HORIZONTAL	600	1864	1/2"	nr.2 da 3/8"
					nr. 2 (1/2" + 1")
1000 liters	HORIZONTAL	800	2200	2"	nr.1 da 1/2"
					nr.1 da 3/4"

**NOTE**

*Dimensions are indicative*

*Technical sheets are available for every item*

## COMPRESSED AIR TANKS - STAINLESS STEEL AISI 304 /316L

### VERTICAL TANKS

#### Technical data

<b>Capacity</b>	50 - 1000 lt
<b>Thread</b>	UNI - ISO 228/1
<b>Fluid</b>	Compressed air / nitrogen /air and water
<b>Max working pressure</b>	11 BAR
<b>Test / certificate</b>	2014/68/UE (PED)
<b>Material</b>	st. steel AISI 304 -AISI 316L
<b>External treatments</b>	crude with internal/external treatment of pickling and passivation



### TANKS AISI 304 / AISI 316L ACCORDING TO 2014/68/UE - PED

CAPACITY MAX PRESSURE 11 BAR	VERSION	DIAMETER (mm)	LENGHT (mm)	BOTTOM THREAD	SHELL THREAD
50 liters	VERTICAL	305	913	1/2"	nr. 2 da 1/2"
100 liters	VERTICAL	370	1106	1/2"	nr. 2 da 3/4" nr. 2 da 3/8"
200 liters	VERTICAL	446	1554	1/2"	nr. 2 da 1" nr. 2 da 3/8"
270 liters	VERTICAL	500	1748	1/2"	nr. 3 da 1" nr. 2 da 3/8"
500 liters	VERTICAL	600	2055	1/2"	nr. 4 da 1" nr. 1 da 3/8"
1000 liters	VERTICAL	800	2353	2"	nr. 4 da 2" nr. 2 da 3/8"

**NOTE**

*Dimensions are indicative*

*Technical sheets are available for every item*