

Linear Bearings KB-3-ST ISO Series 3, Closed Design

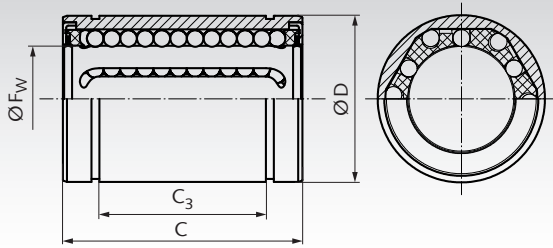

Material: With Steel jacket. Ball cage from plastic.
These linear bearings can be fitted inside a customer's housing or as spare parts for our closed units ISO Series 3.

The bearings are greased at the factory. In order to prevent the ingress of dirt and the leakage of lubricant, the linear ball bearings are sealed on both sides.

Recommended shaft tolerance h6, housing tolerance H7.

Ordering Details: e.g.: Product No. 64600506, Linear Bearing KB-3-ST, Internal-Ø 5 mm

Product No.	F _w mm	D mm	C mm	C ₃ mm	Load rating		Gewicht g	Product No. Retaining Ring DIN 471 Page 726	Weight g
					dyn. C N	stat. C ₀ N			
646 005 06	5	12	22	12,3 ^{-0,2}	270	270	10	617 412 00	0,5
646 007 06*	6	12*	19*	11,3 ^{-0,2*}	200	260	10	617 412 00	0,5
646 008 06	8	16	25	14,3 ^{-0,2}	350	410	20	617 416 00	0,7
646 010 06*	10	19	29	19,4 ^{-0,2*}	370	540	30	617 419 00	1,0
646 012 06	12	22	32	20,3 ^{-0,2}	555	800	40	617 422 00	1,5
646 016 06	16	26	36	22,3 ^{-0,2}	1045	910	60	617 426 00	2,0
646 020 06	20	32	45	28,3 ^{-0,2}	1170	1400	90	617 432 00	3,5
646 025 06	25	40	58	40,4 ^{-0,3}	1330	1600	210	617 440 00	6,0
646 030 06	30	47	68	48,4 ^{-0,3}	2120	2800	320	617 447 00	7,5
646 040 06	40	62	80	56,3 ^{-0,3}	2920	4100	700	617 462 00	14,3
646 050 06	50	75	100	72,3 ^{-0,3}	5195	8100	1130	617 475 00	24,6
646 060 06**	60	90	125	95,4 ^{-0,4**}	6390	10200	2050	-	-

* ISO series 5. ** C₃ is 0.4 mm larger than stated in DIN ISO 10285.

Shaft steel page 539. Shaft blocks page 549.
Precision housings page 556.

Linear Bearings KB-3-ST-O ISO Series 3, Open Design

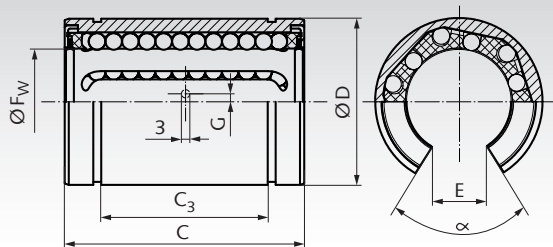

Material: With Steel jacket. Ball cage from plastic.
These linear bearings can be fitted inside a customer's housing or as spare parts for our opened units ISO Series 3.

The bearings are greased at the factory. In order to prevent the ingress of dirt and the leakage of lubricant, the linear ball bearings are sealed on both sides.

Recommended shaft tolerance h6, housing tolerance H7.

Ordering Details: e.g.: Product No. 64601207, Linear Bearing KB-3-ST-O, Internal-Ø 12 mm

Product No.	F _w mm	D mm	C mm	C ₃ mm	G mm	E mm	α °	Load rating		Weight g
								dyn. C N	stat. C ₀ N	
646 012 07	12	22	32	20,3 ^{-0,2}	0	7,5	78	555	800	40
646 016 07	16	26	36	22,3 ^{-0,2}	0	10,0	78	1045	910	60
646 020 07	20	32	45	28,3 ^{-0,2}	0	10,0	60	1170	1400	90
646 025 07	25	40	58	40,4 ^{-0,3}	1,5 ¹⁾	12,5	60	1330	1600	210
646 030 07	30	47	68	48,4 ^{-0,3}	2,0	12,5	50	2120	2800	320
646 040 07	40	62	80	56,3 ^{-0,3}	1,5	16,8	50	2920	4100	700
646 050 07	50	75	100	72,3 ^{-0,3}	2,5	21,0	50	5195	8100	1130

¹⁾ At size 25 the fixing hole Ø 3 mm is located below the middle.

Shaft steel with shaft support page 540.
Precision housings page 556.