

Schnellsteckverbinder komplett aus Messing.

Die Teile mit zylindrischem Gewinde sind mit einem FKM-O-Ring ausgestattet. Die konischen Gewinde sind mit der Dispersion preCOTE 5 beschichtet, so dass alle Verbinder dieser Serie auch bei hohen Temperaturen eingesetzt werden können (Medium Druckluft).

Arbeitsdruck:	-0,98 bar bis 16 bar
Betriebstemperatur:	-20 °C bis 150 °C
Material:	Messing vernickelt
Lösering:	Messing vernickelt
Spannring:	Edelstahl
O-Ring:	FKM
Empfohlener Schlauch:	PA und PU

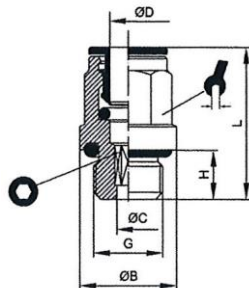

845.014-6

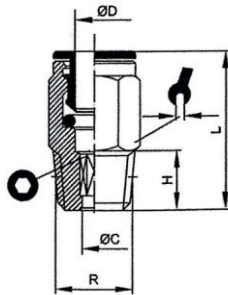

**Gerade Steckverschraubung**, Außengewinde zylindrisch mit O-Ring und Außensechskant  
(M-Gewinde ohne Außensechskant)

Typen Nr.	Artikel Nr.	Ø D mm	Gewinde	Ø B mm	Ø C mm	H mm	L mm	mm	mm
845.005-4	108854	4	M5	9,0	2,6	4,0	20,5	Ø9	2,5
845.005-6	108855	6	M5	10,5	2,6	4,0	22,5	Ø10,5	2,5
845.018-4	108856	4	G 1/8	13,5	2,6	6,0	20,0	9	2,5
845.018-6	108857	6	G 1/8	13,5	4,2	6,0	24,0	11	4
845.018-8	108858	8	G 1/8	12,8	5,2	6,0	26,5	13	5
845.018-10	108859	10	G 1/8	13,5	5,2	6,0	29,0	16	5
845.014-4	108860	4	G 1/4	17,0	2,6	8,0	21,0	9	2,5
845.014-6	108861	6	G 1/4	17,0	4,2	8,0	24,0	11	4
845.014-8	108862	8	G 1/4	17,0	6,2	8,0	25,0	13	6
845.014-10	108863	10	G 1/4	16,0	7,3	8,0	29,0	16	7
845.014-12	108864	12	G 1/4	16,0	7,3	6,5	30,0	18	7
845.038-8	108865	8	G 3/8	20,0	6,2	9,0	25,0	13	6
845.038-10	108866	10	G 3/8	21,0	8,3	9,0	29,5	16	8
845.038-12	108867	12	G 3/8	21,0	10,3	9,0	31,0	18	10
845.038-14	108868	14	G 3/8	21,0	10,3	9,0	34,0	21	10
845.038-16	136773	16	G 3/8	21,0	10,3	9,0	36,0	24	10
845.012-10	108869	10	G 1/2	24,0	8,3	11,0	31,0	16	8
845.012-12	108870	12	G 1/2	24,0	10,3	11,0	31,5	18	10
845.012-14	108871	14	G 1/2	25,0	12,3	11,0	34,5	21	12
845.012-16	136774	16	G 1/2	24,0	12,3	11,0	37,5	24	12



844.018-6

**Gerade Steckverschraubung**, Außengewinde konisch mit Gewindebeschichtung und Außensechskant

Typen Nr.	Artikel Nr.	Ø D mm	Gewinde	Ø C mm	H mm	L mm	 mm	 mm
844.018-4	108882	4	R 1/8	2,6	7,0	22,5	10	2,5
844.018-6	108883	6	R 1/8	4,2	7,0	24,5	11	4
844.018-8	108884	8	R 1/8	5,2	7,0	27,5	13	5
844.014-4	108885	4	R 1/4	2,6	11,0	22,5	14	2,5
844.014-6	108886	6	R 1/4	4,2	11,0	24,5	14	4
844.014-8	108887	8	R 1/4	5,2	11,0	27,5	13	5
844.014-10	108888	10	R 1/4	7,3	11,0	32,5	16	7
844.014-12	108889	12	R 1/4	7,3	11,0	32,5	17	
844.038-8	108890	8	R 3/8	5,2	11,5	28,0	17	5
844.038-10	108891	10	R 3/8	8,3	11,5	32,5	17	8
844.038-12	108892	12	R 3/8	8,3	11,5	30,5	17	8
844.012-12	108893	12	R 1/2	10,3	14,0	33,0	22	10

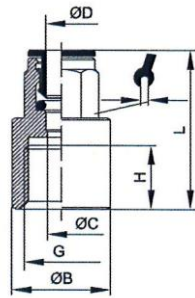

846.014-6

## Gerade Steckverschraubung, Innengewinde zylindrisch mit Außensechskant

Typen Nr.	Artikel Nr.	Ø D mm	Gewinde	Ø B mm	Ø C mm	H mm	L mm	 mm
846.018-4	108872	4	G 1/8	12,0	3,0	6,5	26,5	9
846.018-6	108873	6	G 1/8	12,0	5,0	6,5	27,0	11
846.018-8	108874	8	G 1/8	12,0	7,0	6,5	28,0	13
846.014-4	108875	4	G 1/4	17,0	3,0	10,0	29,5	9
846.014-6	108876	6	G 1/4	17,0	5,0	10,0	31,0	11
846.014-8	108877	8	G 1/4	17,0	7,0	10,0	32,0	13
846.014-10	108878	10	G 1/4	16,0	9,0	10,0	32,0	16
846.014-12	108879	12	G 1/4	20,0	11,0	15,0	40,0	20
846.038-10	108880	10	G 3/8	20,0	9,0	13,0	37,5	20
846.038-12	108881	12	G 3/8	20,0	11,0	15,0	39,5	20
846.012-16	136775	16	G 1/2	24,0	14,5	15,0	41,0	24

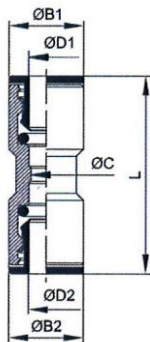

847.006

## Gerade Steckverbindung

Typen Nr.	Artikel Nr.	Ø D1 mm	Ø D2 mm	Ø B1 mm	Ø B2 mm	Ø C mm	L mm
847.004	108966	4	4	9,0	9,0	3,0	31,0
847.006	108967	6	6	11,0	11,0	5,0	33,0
847.008	108968	8	8	13,0	13,0	7,0	37,0
847.010	108969	10	10	15,0	15,0	9,0	39,0
847.012	108970	12	12	17,0	17,0	11,0	43,0
847.014	108971	14	14	20,0	20,0	12,0	48,0
847.016	136779	16	16	24,0	24,0	14,0	50,0

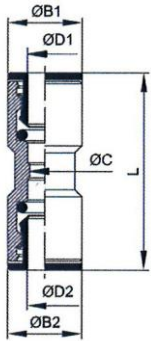

847.1008

**Gerade Steckverbindung, reduzierend**

Typen Nr.	Artikel Nr.	Ø D1 mm	Ø D2 mm	Ø B1 mm	Ø B2 mm	Ø C mm	L mm
847.0604	108972	6	4	11,0	9,0	3,0	33,0
847.0806	108973	8	6	13,0	11,0	5,0	39,0
847.1008	108974	10	8	16,0	13,0	7,0	39,0
847.1210	108975	12	10	20,0	15,0	9,0	42,5

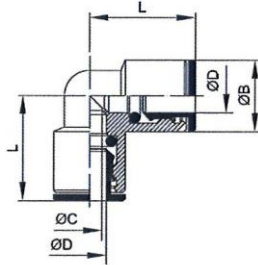

848.006

## L-Steckverbinding

Typen Nr.	Artikel Nr.	Ø D mm	Ø B mm	Ø C mm	L mm
848.004	108982	4	9,0	3,0	17,5
848.006	108983	6	11,0	5,0	20,0
848.008	108984	8	13,0	7,0	23,0
848.010	108985	10	15,0	8,0	25,0
848.012	108986	12	17,0	10,0	27,5
848.014	108987	14	20,0	12,0	31,0
848.016	136781	16	23,0	14,0	33,0

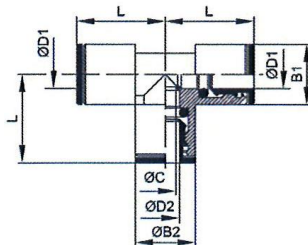

849.006

## T-Steckverbinding

Typen Nr.	Artikel Nr.	Ø D1 mm	Ø D2 mm	Ø B1 mm	Ø B2 mm	Ø C mm	L1 mm	L2 mm
849.004	108988	4	4	9,0	9,0	3,0	34,0	17,0
849.006	108989	6	6	11,0	11,0	5,0	39,0	19,5
849.008	108990	8	8	13,0	13,0	7,0	46,0	23,0
849.010	108991	10	10	15,0	15,0	8,0	50,0	25,0
849.012	108992	12	12	17,0	17,0	10,0	54,0	27,0
849.014	108993	14	14	20,0	20,0	12,0	62,0	31,0
849.016	136782	16	16	23,0	23,0	14,5	72,0	36,0

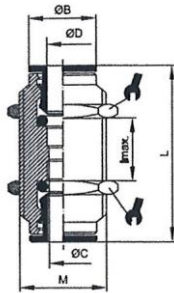

851.016-8

## Gerade Schott-Steckverbindung

Typen Nr.	Artikel Nr.	Ø D mm	Ø C mm	Gewinde	Ø B mm	l <sub>max</sub>	L mm	 mm
851.010-4	108976	4	3,0	M10x1,0	8,0	15,0	31,5	13
851.014-6	108977	6	5,0	M14x1,0	11,0	11,0	33,5	17
851.016-8	108978	8	7,0	M16x1,0	13,0	16,0	37,0	18
851.017-10	108979	10	9,0	M17x1,0	15,0	19,0	39,5	20
851.020-12	108980	12	11,0	M20x1,0	17,0	17,0	42,0	24
851.022-14	108981	14	13,0	M22x1,0	20,0	21,0	46,0	25
851.028-16	136780	16	14,5	M28x1,5	24,0	22,0	50,0	36

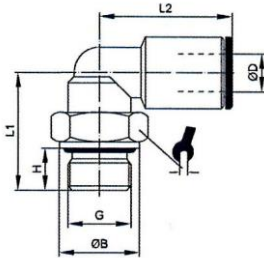

854.014-6

**L-Steckverschraubung**, drehbar, Außengewinde zylindrisch mit O-Ring

Typen Nr.	Artikel Nr.	Ø D mm	Gewinde	Ø B mm	H mm	L1 mm	L2 mm	 mm
854.005-4	108894	4	M5	8,0	4,0	14,5	18,0	9
854.005-6	108895	6	M5	8,0	4,0	14,5	21,0	9
854.018-4	108896	4	G 1/8	13,0	6,0	20,0	20,0	13
854.018-6	108897	6	G 1/8	13,0	6,0	20,0	21,0	13
854.018-8	108898	8	G 1/8	13,0	6,0	20,0	24,0	13
854.018-10	136776	10	G 1/8	13,0	5,5	23,5	26,5	13
854.014-4	108899	4	G 1/4	16,0	8,0	24,0	20,0	13
854.014-6	108900	6	G 1/4	16,0	8,0	24,0	21,0	13
854.014-8	108901	8	G 1/4	16,0	8,0	24,0	24,0	13
854.014-10	108902	10	G 1/4	16,0	8,0	24,0	27,0	16
854.014-12	108903	12	G 1/4	16,0	6,5	29,0	30,5	16
854.038-8	108904	8	G 3/8	20,0	9,0	25,5	24,0	13
854.038-10	108905	10	G 3/8	20,0	9,0	28,0	27,0	16
854.038-12	108906	12	G 3/8	20,0	9,0	29,0	29,0	20
854.038-14	137008	14	G 3/8	19,8	9,0	28,5	32,0	20
854.038-16	136777	16	G 3/8	19,8	9,0	33,0	33,5	20
854.012-10	108907	10	G 1/2	25,0	11,0	30,0	27,0	16
854.012-12	108908	12	G 1/2	25,0	11,0	35,0	29,0	20
854.012-14	137009	14	G 1/2	25,0	11,0	35,0	32,0	20
854.012-16	136778	16	G 1/2	25,0	11,0	38,0	33,5	20

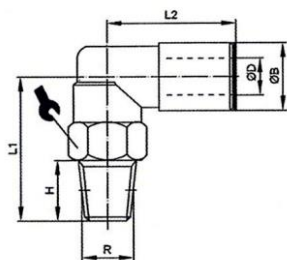

8854.014-6

**L-Steckverschraubung**, drehbar, Außengewinde konisch mit Gewindebeschichtung

Typen Nr.	Artikel Nr.	Ø D mm	Gewinde	H mm	L1 mm	L2 mm	 mm
8854.018-4	108909	4	R 1/8	7,0	20,0	20,0	13
8854.018-6	108910	6	R 1/8	7,0	20,0	21,0	13
8854.018-8	108911	8	R 1/8	7,0	20,0	24,0	13
8854.014-4	108912	4	R 1/4	11,0	25,0	20,0	14
8854.014-6	108913	6	R 1/4	11,0	25,0	21,0	14
8854.014-8	108914	8	R 1/4	11,0	25,0	24,0	14
8854.014-10	108915	10	R 1/4	11,0	26,0	27,0	16
8854.038-8	108916	8	R 3/8	11,0	28,0	24,0	18
8854.038-10	108917	10	R 3/8	11,0	30,0	27,0	18
8854.038-12	108918	12	R 3/8	11,0	32,5	28,5	20
8854.038-14	137010	14	R 3/8	14,0	35,5	32,0	22
8854.012-12	108919	12	R 1/2	14,0	35,5	28,5	22
8854.012-14	137011	14	R 1/2	14,0	35,5	32,0	22



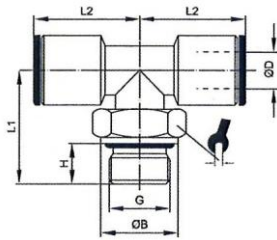

855.014-6

**T-Steckverschraubung**, drehbar, Außengewinde zylindrisch mit O-Ring

Typen Nr.	Artikel Nr.	Ø D mm	Gewinde	Ø B mm	H mm	L1 mm	L2 mm	 mm
855.018-4	108920	4	G 1/8	13,0	6,0	20,0	20,0	13
855.018-6	108921	6	G 1/8	13,0	6,0	20,0	21,5	13
855.018-8	108922	8	G 1/8	13,0	6,0	20,0	23,5	13
855.014-6	108923	6	G 1/4	16,0	8,0	24,0	21,5	13
855.014-8	108924	8	G 1/4	16,0	8,0	24,0	23,5	13
855.014-10	108925	10	G 1/4	16,0	8,0	24,0	26,5	16
855.038-8	108926	8	G 3/8	20,0	9,0	25,5	23,5	13
855.038-10	108927	10	G 3/8	20,0	9,0	28,0	26,5	16
855.038-12	108928	12	G 3/8	19,8	9,0	34,5	29,0	20
855.038-14	137012	14	G 3/8	19,8	9,0	28,5	32,0	20
855.012-12	108929	12	G 1/2	25,0	11,0	34,5	29,0	20
855.012-14	137013	14	G 1/2	25,0	11,0	33,5	32,0	20

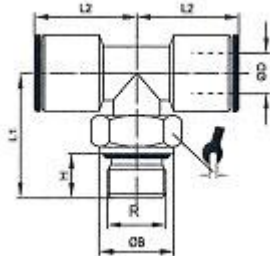

8855.014-6

**T-Steckverschraubung**, drehbar, Außengewinde konisch mit PTFE-Gewindebeschichtung

Typen Nr.	Artikel Nr.	Ø D mm	Gewinde	Ø B mm	H mm	L1 mm	L2 mm	 mm
8855.018-4	108930	4	R 1/8	12,8	7,0	20,0	20,0	13
8855.018-6	108931	6	R 1/8	12,8	7,0	20,0	21,5	13
8855.018-8	108932	8	R 1/8	12,8	7,0	20,0	23,5	13
8855.014-6	108933	6	R 1/4	14,0	11,0	25,0	21,5	14
8855.014-8	108934	8	R 1/4	14,0	11,0	25,0	23,5	14
8855.014-10	108935	10	R 1/4	16,0	11,0	26,0	26,5	16
8855.038-8	108936	8	R 3/8	18,0	11,0	28,0	23,5	18
8855.038-10	108937	10	R 3/8	18,0	11,0	53,0	30,0	18
8855.038-12	108938	12	R 3/8	20,0	11,0	58,0	32,5	20
8855.038-14	137014	14	R 3/8	-	11,0	32,5	32,0	22
8855.012-12	108939	12	R 1/2	22,0	14,0	58,0	35,5	22
8855.012-14	137015	14	R 1/2	-	14,0	35,5	32,0	22

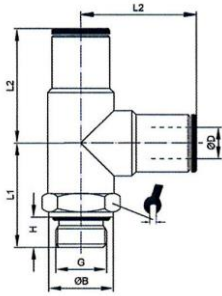

862.014-6

**T-Steckverschraubung**, Steckanschlüsse in L-Form, drehbar, Außengewinde zylindrisch mit O-Ring

Typen Nr.	Artikel Nr.	Ø D mm	Gewinde	Ø B mm	H mm	L1 mm	L2 mm	 mm
862.018-4	108940	4	G 1/8	13,0	6,0	18,0	17,5	13
862.018-6	108941	6	G 1/8	13,0	6,0	20,5	21,0	13
862.018-8	108942	8	G 1/8	13,0	6,0	20,0	23,0	13
862.014-6	108943	6	G 1/4	16,0	8,0	24,5	21,0	13
862.014-8	108944	8	G 1/4	16,0	8,0	24,5	23,0	13
862.014-10	108945	10	G 1/4	16,0	8,0	24,0	27,0	16
862.038-8	108946	8	G 3/8	20,0	9,0	25,7	23,4	13
862.038-10	108947	10	G 3/8	20,0	9,0	27,0	27,0	16
862.038-12	108948	12	G 3/8	20,0	9,0	28,0	29,0	16
862.038-14	137016	14	G 3/8	19,8	9,0	28,5	32,0	20
862.012-12	108949	12	G 1/2	25,0	11,0	30,0	28,5	16
862.012-14	137017	14	G 1/2	25,0	11,0	34,0	33,0	20

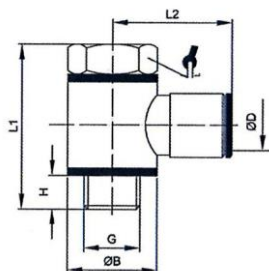

863.018-6

### L-Steckverschraubung mit Außensechskant, Außengewinde zylindrisch mit O-Ring

Typen Nr.	Artikel Nr.	Ø D mm	Gewinde	Ø B mm	H mm	L1 mm	L2 mm	mm
863.005-4	108950	4	M5	SW9	3,0	17,5	18,0	8
863.005-5	108951	5	M5	SW9	3,0	17,5	19,0	8
863.005-6	108952	6	M5	SW9	3,0	19,5	19,5	8
863.018-4	108953	4	G 1/8	14,0	5,5	28,0	20,5	14
863.018-6	108954	6	G 1/8	14,0	5,5	28,0	23,0	14
863.018-8	108955	8	G 1/8	14,0	5,5	28,0	24,5	14
863.014-6	108956	6	G 1/4	18,0	7,0	33,0	24,0	17
863.014-8	108957	8	G 1/4	18,0	7,0	33,0	26,0	17
863.014-10	108958	10	G 1/4	18,0	7,0	33,0	27,0	17
863.038-8	108959	8	G 3/8	21,0	8,5	36,0	27,0	19
863.038-10	108960	10	G 3/8	22,0	7,5	28,0	36,5	19
863.038-12	108961	12	G 3/8	21,0	8,5	36,0	29,0	19
863.012-12	108962	12	G 1/2	27,0	10,0	34,5	42,0	24

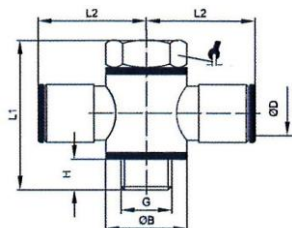

864.018-6

### T-Steckverschraubung mit Außensechskant, drehbar, Außengewinde zylindrisch mit O-Ring

Typen Nr.	Artikel Nr.	Ø D mm	Gewinde	Ø B mm	H mm	L1 mm	L2 mm	mm
864.018-4	108963	4	G 1/8	14,0	5,5	28,0	21,0	14
864.018-6	108964	6	G 1/8	14,0	5,5	28,0	23,0	14
864.014-6	108965	6	G 1/4	18,0	7,0	33,0	24,0	17

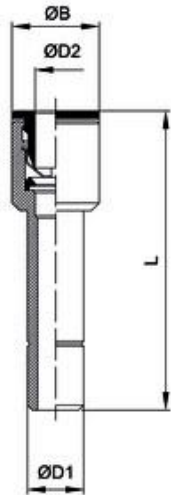

867.0806

## Gerade Steckverbindung mit Stecknippel, reduzierend

Nur für den Einsatz in Kombination mit Schnellsteckverbindungen der Serie »metallica« empfohlen. Die Eignungsprüfung für den Einsatz mit anderen Serien obliegt dem Anwender.

Typen Nr.	Artikel Nr.	Ø D1 mm	Ø D2 mm	Ø B mm	L mm
867.0604	108994	6	4	9,0	29,5
867.0806	108995	8	6	11,0	33,0
867.1008	108996	10	8	13,0	38,5
867.1210	108997	12	10	15,0	41,0
867.1412	137018	14	12,2	17,0	44,0

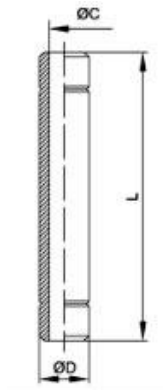

769.006

### Stecknippel

Nur für den Einsatz in Kombination mit Schnellsteckverbindungen der Serie »metallica« empfohlen. Die Eignungsprüfung für den Einsatz mit anderen Serien obliegt dem Anwender.

Betriebstemperatur: -20 °C bis 80 °C

Typen Nr.	Artikel Nr.	Ø D mm	Ø C mm	L mm
8865.004	142787	4	2	35,0
8865.006	142788	6	4	36,5
8865.008	142789	8	6	40,0
8865.010	142790	10	8	45,5
8865.012	142793	12	10	48,0
8865.014	129491	14	12	53,0