

ALL RIGHTS RESERVED. NO PORTION OF THIS PUBLICATION, WHETHER IN WHOLE OR IN PART CAN BE REPRODUCED WITHOUT THE EXPRESS WRITTEN CONSENT OF SPC TECHNOLOGY.

REVISIONS		DOC. NO.	SPC-F005	Effective:	12/21/98	Doc No.	080
DWG #	REV	DESCRIPTION	DRAWN	DATE	CHECKD	DATE	APPRVD
1116	C	Drawing Was CRS-TV-***	JWM	6/11/01	JC	5/26/01	JC
1199	D	Redrawn & Bulk Items added	JWM	4/11/02	JC	4/11/02	JC

SPC Type No.	Package QTY.	Wire Range (AWG)	Stud Size	W	C	L	E	Thickness	"T" Barrel I.D.	"W" Max. Insulator Diameter	Color	
CRS-TV-1006	50	12 ~ 10	6	.28	.29	.98	.84	.040	.135	.250	Yellow	
SPC3763	500		8	.53	.44	1.26						.99
CRS-TV-1008	50		5/16	.54	.22	.80						.67
SPC3764	500	16 ~ 14	6	.33	.29	.90	.74	.030	.090	0.17	Blue	
CRS-TV-1010	50		8	.31	.33	.93	.78					
SPC3765	500		10	.33	.29	.90	.74					
CRS-TV-1025	50	22 ~ 18	1/4	.47	.40	1.08	.85	.030	.070	0.145	Red	
SPC3766	500		2	.25	.23	.80	.68					
CRS-TV-1031	50		4	.25	.22	.80	.67					
SPC3767	500	1000	3/8	.25	.22	.80	.67	.030	.070	0.145	Red	
CRS-TV-1037	50		6	.25	.22	.80	.67					
CRS-TV-1406	1000		6	.31	.33	.93	.78					
SPC3760	1000	1000	6	.33	.29	.90	.74	.030	.090	0.17	Blue	
CRS-TV-1406-S	100		8	.31	.33	.93	.78					
CRS-TV-1408	100		10	.33	.29	.90	.74					
SPC3761	1000	1000	8	.31	.33	.93	.78	.030	.090	0.17	Blue	
CRS-TV-1408-S	100		10	.33	.29	.90	.74					
CRS-TV-1410	1000		1/4	.47	.40	1.08	.85					
CRS-TV-1410-S	100	1000	1/4	.47	.40	1.08	.85	.030	.070	0.145	Red	
CRS-TV-1425	100		2	.25	.23	.80	.68					
SPC3762	1000		4	.25	.22	.80	.67					
CRS-TV-1802	100	1000	2	.25	.22	.80	.67	.030	.070	0.145	Red	
CRS-TV-1804	100		4	.25	.22	.80	.67					
SPC3765	1000		6	.25	.22	.80	.67					
CRS-TV-1806	100	1000	6	.25	.22	.80	.67	.030	.070	0.145	Red	
SPC3766	1000		8	.31	.33	.93	.78					
CRS-TV-1808	100		10	.31	.33	.93	.78					
SPC3767	1000	1000	10	.31	.33	.93	.78	.030	.070	0.145	Red	
CRS-TV-1810	100		1/4	.47	.40	1.08	.85					
SPC3768	1000		2	.25	.23	.80	.68					
CRS-TV-1825	100	1000	2	.25	.22	.80	.67	.030	.070	0.145	Red	
SPC3769	1000		4	.25	.22	.80	.67					
CRS-TV-1825	100		6	.25	.22	.80	.67					

Notes:
 Material: Electro-tin plated Copper
 Insulating Material: Vinyl (PVC) UL94V-0
 Voltage Rating: 600V
 Operating Temp: -40°F to 221°F (-40°C ~ 105°C)

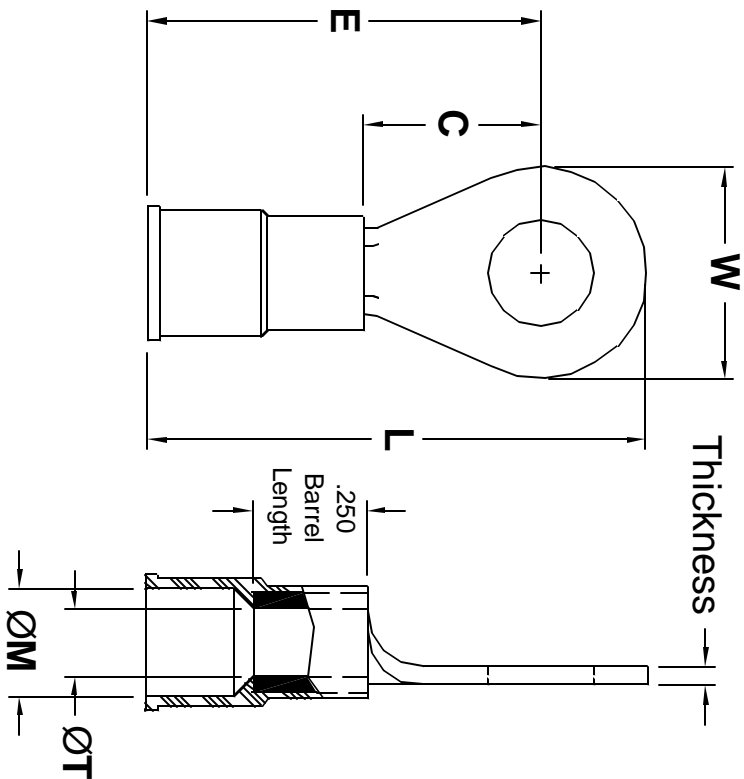

DISCLAIMER
 ALL STATEMENTS AND TECHNICAL INFORMATION CONTAINED HEREIN ARE BASED UPON INFORMATION AND/OR TESTS WE BELIEVE TO BE ACCURATE AND RELIABLE. SINCE CONDITIONS OF USE ARE THE PROPERTY OF OUR CUSTOMER, THE USER SHALL DETERMINE THE SUITABILITY OF THE PRODUCT FOR THE INTENDED USE AND ASSUME ALL RISK AND LIABILITY WHATSOEVER IN CONNECTION THEREWITH.

Tolerances: Unless
 Otherwise Specified:

X = ±.015
 .XX = ±.010
 .XXX = ±.005



E88918



LR22190M/6



SPC TECHNOLOGY

DRAWING TITLE: Vinyl Insulated Butted Seam Ring Tongue Terminals

SIZE DWG. NO. A TA-352

ELECTRONIC FILE TA-352.dwg

REV D

SCALE: NTS U.O.M.: INCHES [mm]

SHEET: 1 OF 1

SPC-F005.DWG