

CONTACTOR SIZE 14, 3-POLE AC-3, 450KW,
400/380V (1000V) AUXILIARY CONTACTS 44
(4NO+4NC) AC OPERATION AC 200 TO 240V
50/60HZ

General technical data:

| | | |
|---|----|------------|
| Size of contactor | | 14 |
| Protection class IP on the front | | IP00 |
| Ambient temperature during operation | °C | 55 ... -25 |
| Equipment marking acc. to DIN 40719 extended according to IEC 204-2 acc. to IEC 750 | | K |
| Equipment marking acc. to DIN EN 61346-2 | | Q |

Main circuit:

| | | |
|--|----|-----|
| Number of poles for main current circuit | | 3 |
| Operating current at AC-1 at 400 V | | |
| • at ambient temperature 40 °C Rated value | A | 910 |
| Number of NC contacts for main contacts | | 0 |
| Number of NO contacts for main contacts | | 3 |
| Operating current at AC-3 at 400 V Rated value | A | 820 |
| Operating power | | |
| • at AC-1 at 400 V Rated value | kW | 558 |
| • at AC-3 at 400 V Rated value | kW | 450 |

Control circuit/ Control:

| | | |
|---|----|--------------|
| Control version of the switch operating mechanism | | conventional |
| Type of voltage of the control supply voltage | | AC |
| Control supply voltage frequency | | |
| • 1 Rated value | Hz | 50 |
| • 2 Rated value | Hz | 60 |
| Control supply voltage | | |

- with AC
 - at 50 Hz
 - Rated value
 - at 60 Hz
 - Rated value

| | |
|---|-------------|
| V | 200 ... 240 |
| V | 200 ... 240 |

Auxiliary circuit:

| | | |
|---|--|---|
| Number of NC contacts for auxiliary contacts | | |
| • lagging switching | | 0 |
| • instantaneous contact | | 4 |
| Number of NO contacts for auxiliary contacts | | |
| • leading contact | | 0 |
| • instantaneous contact | | 4 |

Connections/ Terminals:

| | | |
|--|--|----------------------|
| Type of electrical connection | | |
| • for main current circuit | | screw-type terminals |
| • for auxiliary and control current circuit | | screw-type terminals |
| Identification number and letter for switching elements | | 44 |

Mechanical data:

| | | |
|--|----|--------------|
| Mounting type | | screw fixing |
| Mounting type Side-by-side mounting | | Yes |
| Width | mm | 230 |
| Height | mm | 295 |
| Depth | mm | 237 |

Certificates/ approvals:

| | |
|--------------------------|---------------------------------------|
| General Product Approval | Functional Safety/Safety of Machinery |
|--------------------------|---------------------------------------|



[Type Examination Certificate](#)

[Type Examination](#)

| | | |
|---------------------------|-------------------|-------------------|
| Declaration of Conformity | Test Certificates | Shipping Approval |
|---------------------------|-------------------|-------------------|



[Type Test Certificates/Test Report](#)

[Special Test Certificate](#)



GL

| | |
|-------------------|-------|
| Shipping Approval | other |
|-------------------|-------|



LRS



PRS



RMRS

[Declaration of Conformity](#)

[Environmental Confirmations](#)

[other](#)

| |
|---------------------|
| Further information |
|---------------------|

Information- and Downloadcenter (Catalogs, Brochures,...)

<http://www.siemens.com/industrial-controls/catalogs>

Industry Mall (Online ordering system)

<http://www.siemens.com/industrymall>

Cax online generator

<http://support.automation.siemens.com/WW/CAXorder/default.aspx?lang=en&mlfb=3TF69448CM7>

Service&Support (Manuals, Certificates, Characteristics, FAQs,...)

<http://support.automation.siemens.com/WW/view/en/3TF69448CM7/all>

Image database (product images, 2D dimension drawings, 3D models, device circuit diagrams, EPLAN macros, ...)

<http://www.automation.siemens.com/bilddb/index.aspx?attID9=3TF69448CM7&lang=en>

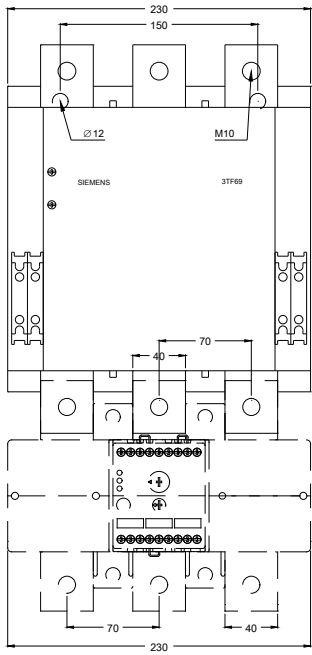

last modified:

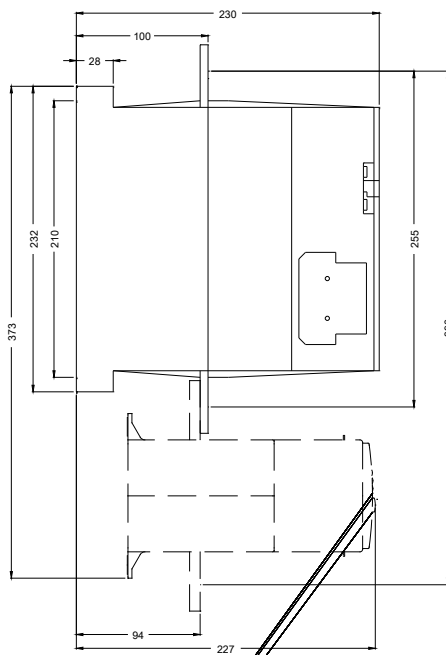

09.03.2015