

DO NOT SCALE DRAWING

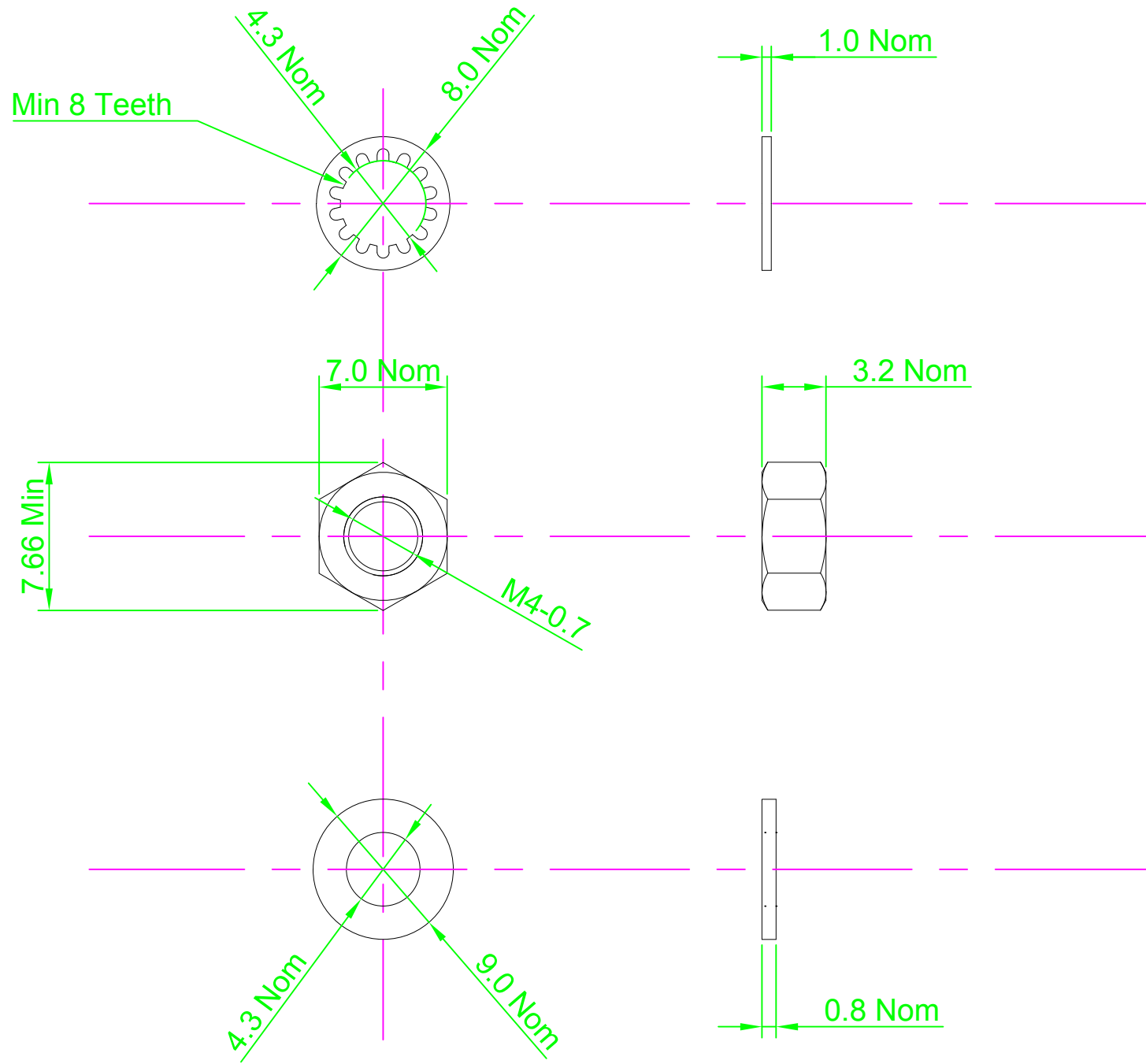
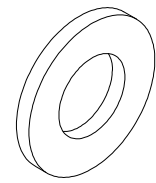
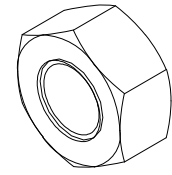
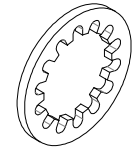

REVISION

A INITIAL DRAWING 13.10.15

Part Number	M4 - AS--KI					
Part	Description	Size	Material	Finish	Qty	Standard
M4 - ITST-	Internal Toothed Washer	M4	Steel	TC1 - Commercial Zinc/Clear Cr3	50	DIN 6797J
M4 - HFBR-	Hex Full Nut	M4	Brass	BN2 - Commercial Nickel	150	DIN 934
M4 - FABRWA	Plain Washer	M4	Brass	BN2 - Commercial Nickel	100	BS 4320

NOTES:



UNLESS OTHERWISE SPECIFIED:  
DIMENSIONS ARE IN MM (MILLIMETERS).  
SURFACE FINISH:  
TOLERANCES: DIN934 / BS4320A / DIN 6797

MATERIAL:  
See Table

TITLE:  
M4 NUT & WASHER KIT

	NAME	DATE
DRAWN	Darryl Wilson	13.10.15
CHK'D		
APPVD		

HEAT TREATMENT:

DESIGN RIGHT. TR FASTENINGS LTD, 2003  
UNDER NO CIRCUMSTANCES MUST THIS  
DRAWING BE COPIED OR DISCLOSED  
WITHOUT FIRST OBTAINING WRITTEN  
AUTHORITY.

CUSTOMER PART NUMBER:  
3067488

FINISH:  
See Table

DRAWING NUMBER:  
TR32M4AS--KI

A4