

Powerpole® connectors provide cost-effective reliability, design flexibility and safety for your products' manufacture, installation and maintenance. Powerpoles are stackable and color-coded for easy customization into multipole blocks.

The housings are modular and genderless. Powerpole® connectors provide 600 Volts continuous, AC or DC operation. Wire sizes range from #2 to #8 AWG (33.6 to 8.4 mm²). Low-detent contacts are also offered for low insertion/withdrawal force applications.

FEATURES

- **Flat wiping contact system**

Minimal contact resistance at high current, wiping action cleans contact surface during connection/disconnection

- **Colored modular housings**

Provides visual identification of proper mating connector

- **Molded-in dovetails**

Secures individual connectors into "keyed" assemblies which prevents misconnection with similar configurations



PRODUCT SPECIFICATIONS

Connector Model	PP120	Connector Model	PP120
UL Current Rating (Amperes)*	120*	Life	
UL Voltage Ratings (Volts)**	600*	a. No load (Contact/Disconnect Cycles)	To 10,000
Contact Barrel Wire Size (AWG) (mm ²)	#2 to #8 33.6 to 8.4	b. Under Load (Hot Plug 250 cycles @ 120V)	60A
Maximum Wire Insulation Diameter (inches) (mm)	0.600 15.24	Avg. Connection/Disconnect (lbs)	8
AVG Contact Resistance* (micro-ohms)	136	Operating Temperature Range °C***	-20° to 105°
Insulation Withstanding Test Voltage (Volts AC/DC)	2200	Flammability Rating of Housing Material	UL94 V-0
Contact Retention Force (lbs)	100		

* UL Rated for 65°C rated wire or cable size
** Both AC & DC Voltage
*** Contact factory for higher temperature rated connectors

ORDERING INFORMATION

Housing & 120 amp Contact

Part Number	Housing Color	Wire	
		AWG	sq. mm
1320	Blue	#2	33.6
1320G	Black	#2	33.6
1320G	White	#2	33.6
1320G	Red	#2	33.6
1320G	Green	#2	33.6

120 amp Contacts

Part Number	Description	Wire	
		AWG	sq. mm
1319	Individual-low detent	#2	33.6
1319G4	Individual-low detent	#4	21.2
1319G6	Individual-low detent	#6	13.3
6811G4*	Individual-low detent	#6	13.3
6811G5*	Individual-low detent	#4	21.2
6811G6*	Individual-low detent	#2	33.6

Housings Only

Part Number	Description
1321	Blue housing
1321G1	Black housing
1321G2	White housing
1321G3	Red housing
1321G4	Green housing

Bushings

Part Number	Description	Wire	
		AWG	sq. mm
5919	Use with 1319	#2 to #4	33.6/21.2
5920	Use with 1319	#2 to #6	33.6/13.3
5921	Use with 1319	#2 to #8	33.6/8.4

Accessories

Part Number	Description
110G18	Retaining Pins - 2 high block of connectors
110G19	Retaining Pins - 1 high block of connectors
110G20	Retaining Pins - 2 high block of connectors

Tooling

Part Number	Description
1368	Hand tool - #2 to #8
1387G1	Pneumatic tool - #2 to #8
1388G4	- die for #2 to #8
1389G4	- locator #2 to #8

* offers lower extraction forces than our 1319 series

DIMENSIONS

Powerpole® Housing

Series	-A- mm in.	-B- mm in.	-C- mm in.	-D- mm in.
PP120	22.2 .88	22.2 .88	69.9 2.75	117.5 4.63

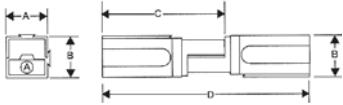

Contacts

Part Number	Contact Detent	-A- mm in.	-B- mm in.	-C- mm in.	-D- mm in.	-E- mm in.
1319	Low	49.27 1.94	21.34 .84	11.18 .44	8.64 .34	10.42 .41
1319G4	Low	49.27 1.94	21.34 .84	11.18 .44	8.64 .34	10.42 .41
1319G6	Low	49.27 1.94	21.34 .84	11.18 .44	8.64 .34	10.42 .41
6811G4*	Low	49.27 1.94	21.34 .84	11.18 .44	8.64 .34	10.42 .41
6811G5*	Low	49.27 1.94	21.34 .84	11.18 .44	8.64 .34	10.42 .41
6811G6*	Low	49.27 1.94	21.34 .84	11.18 .44	8.64 .34	10.42 .41

*Offers lower extraction forces than our 1319 series.

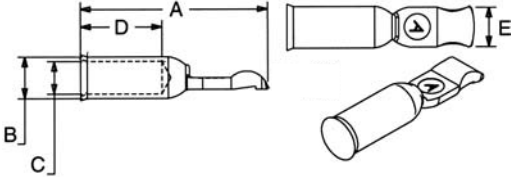

Mounting Clamps

Part Number	Poles	-A- mm in.	-B- mm in.	-C- mm in.	-D- mm in.
1464G1	2	41.15 1.62	34.54 1.36	26.92 1.06	44.45 1.75
1464G1	4	41.15 1.62	50.29 1.98	42.67 1.68	44.45 1.75
1464G2	3	57.15 2.25	34.54 1.36	26.92 1.06	66.55 2.62

Part Number	Poles	-DIA- mm in.
1464G1	2	3.962 0.156
1464G1	4	3.962 0.156
1464G2	3	3.962 0.156

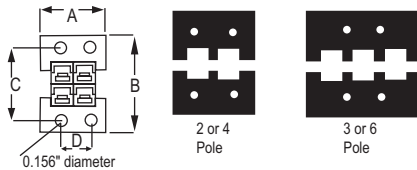

Bushings - (for use with 1319 contacts)

Part Number	Reduces From	-A- mm in.	-B- mm in.	-C- mm in.
5919	#2 to #4 AWG	21.34 .84	8.36 .329	7.24 .285
5920	#2 to #6 AWG	21.34 .84	8.36 .329	5.76 .227
5921	#2 to #8 AWG	21.34 .84	8.36 .329	4.6 .181



TEMPERATURE RISE CHARTS

