

Thread turning inserts, full profile, 60°, HC56 15

for female thread machining, left

ATORN[®]

Application

For creating male threads on CNC machines for the material groups of steel, stainless steel, non-ferrous metal and cast iron at low to medium cutting speeds.

Version

- ground thread turning insert with TiN coating

Advantage

- ground thread turning insert, ensures good finish quality, cutting precision and thread with precise profile replication
- wide range of applications thanks to TiN coating
- high level of productivity and no need to deburr the thread

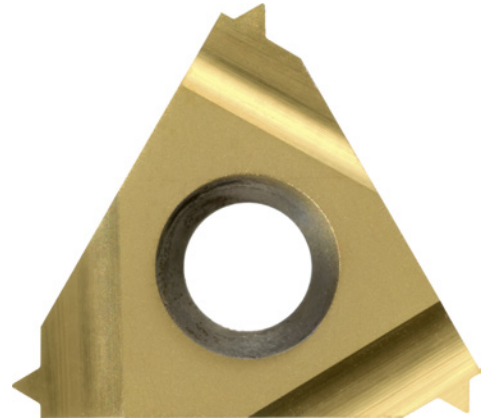

Art. no.	17743 896
ISO name	16 (IR/IL) 3.5 ISO
Pitch	3.5 mm
Machining direction	Left
Carbide type	HC56 15
Material to be processed	Steel, Stainless steel, Non-ferrous metal, Cast metal
Min./max. Vc in steel	75-110 m/min
Min./max. Vc in stainless steel	70-75 m/min
Min./max. Vc in non-ferrous metals	200-600 m/min
Min./max. Vc in cast iron	70-80 m/min

EAN-Code

4050293220452