

RH-S1

Bridge handles

Rectangular cross section, aluminium



STANDARD EXECUTIONS

Threaded blind holes.

- **RHS1-01**: anodised aluminium, natural colour, matte finish.
- **RHS1-04**: anodised aluminium, black colour, matte finish.

FEATURES AND APPLICATIONS

Careful machining of the surface of the handle using special machines eliminates all sharp edges.

RH-S1 series handles adapt well to use on a 19" rack and instruments in general.

HE = height unit of the front panel: 1 HE = 44.45 mm = 1 6/8".

SPECIAL EXECUTIONS ON REQUEST

Different lengths and colours.

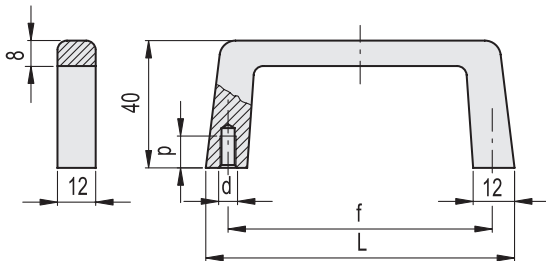

Code	Code	f	L	d	p	G	HE*	△
RHS1-12.025.01	RHS1-12.025.04	25	40	M5	10	44	1	22
RHS1-12.055.01	RHS1-12.055.04	55	69	M5	10	88	2	39
RHS1-12.088.01	RHS1-12.088.04	88	102	M5	10	132.5	3	46
RHS1-12.120.01	RHS1-12.120.04	120	134	M5	10	177	4	55
RHS1-12.180.01	RHS1-12.180.04	180	194	M5	10	221.5	5	69

HE* = height unit of the front panel: 1 HE = 44.45 mm = 1 6/8".

RH-MG

Bridge handles

Rectangular cross section, aluminium



STANDARD EXECUTIONS

Threaded blind holes.

- **RHMG-01**: ground anodised aluminium, natural colour, matte finish.
- **RHMG-04**: ground anodised aluminium, black colour, matte finish.

OTHER STANDARD EXECUTIONS AVAILABLE

Version RH-MG-CLEAN (see page 402).

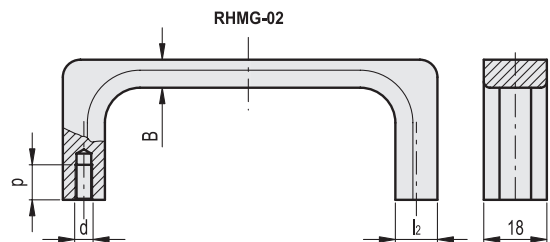
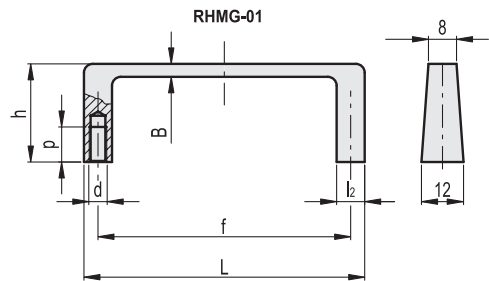

Code	Code	f	L	d	p	B	h	l2	△
RHMG-01.090.01	RHMG-01.090.04	90	98	M5	10	3.7	28	8	18
RHMG-02.120.01	RHMG-02.120.04	120	132	M6	12	8	40	12	82

