



AS-INTERFACE SLIMLINE MODULE, S22.5, DIGITAL, 2I/2O, IP20, 2 X 1 INPUT, 2-WIRE, PNP 2 X 1OUDP., ELECTR., 2A, DC 24V CAGE-CLAMP, MODULE WIDTH 22.5 MM

General technical data:

Design of the product		SlimLine S22.5 - I/O modules for operation in the control cabinet, IP20
Design of the slave type		standard slave
Type		2 inputs / 2 outputs
I/O configuration		3
ID/ID2 code		0/F
Protocol is supported AS-interface protocol		Yes
AS interface total current input max	mA	50
operating voltage according to AS-Interface specification	V	26.5 ... 31.6
Addressing		front addressing socket
Type of electrical connection of the inputs and outputs		spring-loaded terminals
Equipment marking acc. to DIN 40719 extended according to IEC 204-2 acc. to IEC 750		A
Equipment marking acc. to DIN EN 61346-2		K
note		An external additional supply (AUX POWER) of 20 to 30 V DC is required for the supply of the output circuits. The additional supply must comply with VDE 0106 (PELV), protection class III.
Note 1		detachment tool for spring-loaded terminal connection: See Accessories

Sensor supply:

Type of voltage supply for power supply		using AS-Interface
Input voltage	V	20 ... 30

Property of the sensor supply Short-circuit and overload resistant		Yes
Inputs:		
Number of digital inputs		2
Type of connection		2-wire technology
Input circuit		PNP transistor
Type of voltage of the input voltages		DC
Inputs switching level High min	V	10
Input current at digital input		
• for signal <1> minimum	mA	5
• with signal <0> maximum	mA	1.5
Inputs sensor supply using AS-Interface		short-circuit and overload resistant
Outputs:		
Number of digital outputs		2
Type of voltage of output voltages		DC
Output voltage for DC at 24 V	V	22 ... 24
Outputs external power supply 24 V DC		using terminals: Terminal 7= L+, Terminal 10 = M
Outputs		
• aggregate current max	A	4
Ampacity		
• of the semiconductor output at DC-13 at 24 V	A	2
Type of switching output		PNP transistor
Property of the output Short-circuit proof		Yes
output Polarity reversal protection		not installed
Outputs		
• short-circuit protection		built-in
• induction protection		built-in
• watchdog		built-in
Status display		
• display of I/Os		yellow LED
• AS-Interface		green LED
• FAULT		red LED
Assignment of data bits		
• D0		IN1
• D1		IN2
• D2		OUT1
• D3		OUT2
Ambient conditions:		
Ambient temperature		
• during operation	°C	-25 ... +70
• during storage	°C	-40 ... +85

Protection class IP		IP20
---------------------	--	------

Mechanical data:

Width	mm	22.5
Height	mm	103
Depth	mm	86
Mounting type		35 mm standard rail mounting or wall mounting using push-in lugs
Conductor cross-section		<ul style="list-style-type: none"> • solid • finely stranded <ul style="list-style-type: none"> — with end sleeve — without end sleeve • AWG solid or stranded

Certificates/ approvals:

AS-Interface certificate		yes (or requested for in case of new units)
Approvals		UL, CSA, shipbuilding (or requested for in case of new units)

General Product Approval	Test Certificates	Shipping Approval
--------------------------	-------------------	-------------------



[Special Test Certificate](#)



Shipping Approval	other
-------------------	-------



[Declaration of Conformity](#)

other

[Confirmation](#)

[Environmental Confirmations](#)

[other](#)

Further information

Information- and Downloadcenter (Catalogs, Brochures,...)

<http://www.siemens.com/industrial-controls/catalogs>

Industry Mall (Online ordering system)

<http://www.siemens.com/industrymall>

Cax online generator

<http://support.automation.siemens.com/WW/CAXorder/default.aspx?lang=en&mlfb=3RK14000BG000AA2>

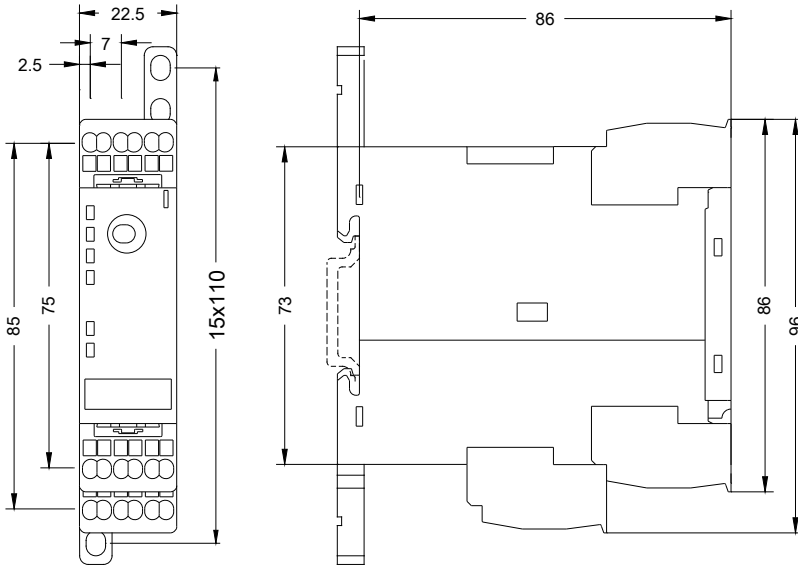

last modified:

09.03.2015