

Basic series

10 mm embeddable

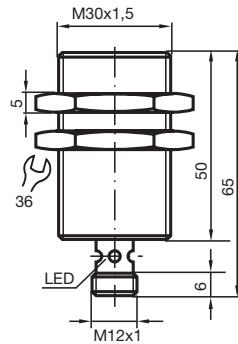

Switching element function	PNP	Make function
Rated operating distance $s_n$	10 mm	
Installation	embeddable	
Assured operating distance $s_a$	0 ... 8,1 mm	
Reduction factor $r_{AI}$	0,3	
Reduction factor $r_{Cu}$	0,3	
Reduction factor $r_{V2A}$	0,8	
Operating voltage $U_B$	10 ... 30 V	
Switching frequency $f$	0 ... 200 Hz	
Reverse polarity protection	yes	
Short circuit protection	pulsing	
Voltage drop $U_d$	$\leq 3$ V	
Operating current $I_L$	0 ... 200 mA	
Off-state current $I_r$	0 ... 0,5 mA typ.	
No-load supply current $I_0$	$\leq 20$ mA	
Indication of the switching state	ring LED, yellow	
Standards	EN 60947-5-2	
Ambient temperature	-25 ... 70 °C (248 ... 343 K)	
Connection type	V1-connector	
Housing material	brass, nickel-plated	
Sensing face	PBT	
Protection degree	IP67	

Connection\_type:

E2

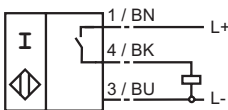

084199\_ENG.xml

2003-03-24