







## 150W AC-DC Desktop Power Supplies

-  FR4 PCB
-  100% ATE Tested
-  High Reliability
-  Built in OVP, OCP & SCP
-  100% smart burn-in test for 4 hours
-  Level VI Efficiency Regulations Compliant
-  Universal Input 90~260V AC 47~63Hz



### DIMENSIONS

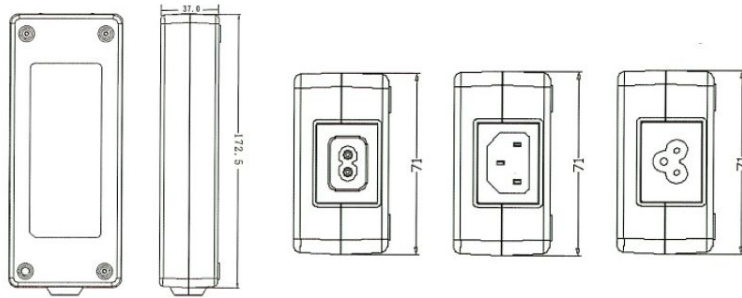

**15DYS6150**

### SPECIFICATIONS

Input	Input Range	100~240VAC (Full Range), 50/60Hz
	Input Current (RMS)	2.5A@90VAC 1.2A@264VAC
Output	Voltage Range	12~50VDC
	Voltage Regulation	+/- 5% At Constant Voltage Mode
	Current Range	0.01~10A
	Max Power	150W
Energy Saving		NRCAN, DOE, ERP, GEMS, Efficiency Level VI
Environmental Protection		RoHS, REACH, PAHS
Environmental	Operating Temperature	0°C ~45°C Ambient
	Storage Temperature	-20°C ~+80°C
	Operating Humidity	10~90% (Non-condensing)
	Relative Humidity	5~95% (Non-condensing)
	MTBF	>25,000 hours at 80% load and 25°C ambient temperature
Approvals		cETLus, TUV-GS, RCM (C-Tick), CB, FCC, CE, RoHS & REACH

VAT No. GB 771 1607 40

Registered in England No. 4063412

Weee Reg. WEE/DD0749YY

 +44 (0) 845 260 3400

 enquiries@ideallpower.co.uk

 idealpower.co.uk

Ideal Power Ltd.  
14 Larks Way  
Tree Beech Enterprise Park  
Gunn, Barnstaple  
Devon, EX32 7NZ  
England, UK