

Bestückungsplan / contact layout

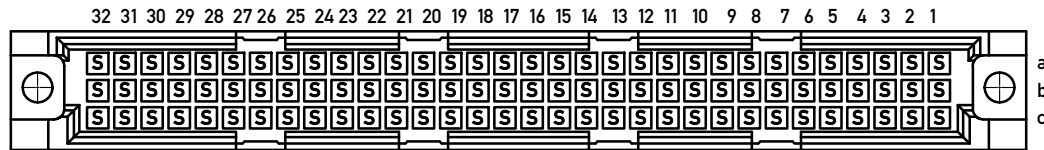

Leiterplatten-Lochbild / PCB drillhole pattern

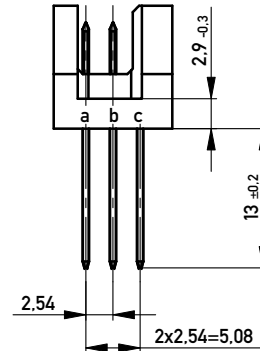
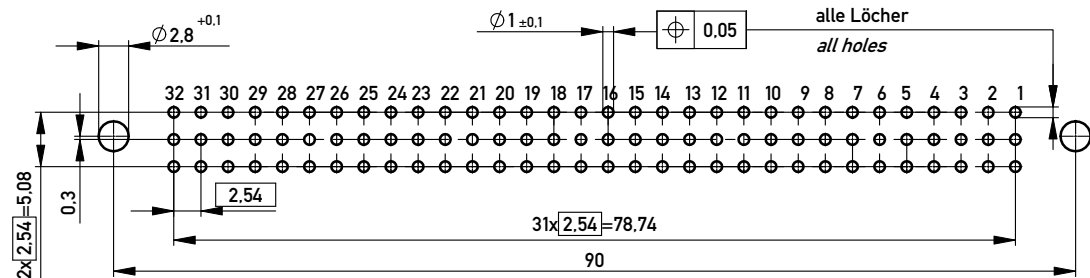

Stecklänge / mating length

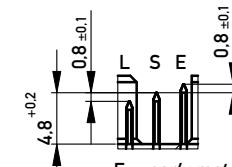

E = early mate, late break / voreilend
S = standard
L = late mate, early break / nacheilend

Lötanschluß 0,6x0,6mm /
Solder Terminal 0,6x0,6mm
Isolierwerkstoff / housing material : PBT GF 30
Bauart 4 / type 4
Anforderungsstufe 2 = 400 Steckzyklen / performance class 2 = 400 mating cycles
Fehlende Maße und Angaben nach IEC 60 603-2 / DIN EN 60 603-2
Missing information and dimensions per IEC 60 603-2 / DIN EN 60 603-2

Bedruckung siehe Zeichnung 294905
Marking see drawing 294905

Copyright by ERNI GmbH.
Proprietary notice pursuant to ISO 16106 to be observed.

| | | | | | |
|--|------------|----------------------|--|---|------|
| Information: | | Tolerances | | Scale | 2:1 |
| All rights reserved. Only for Information. To ensure that this is the latest version of this drawing, please contact one of the ERNI companies before using. | | All Dimensions in mm | | Designation | |
| Subject to modification without prior notice. Drawing will not be updated. | | | | Messerschleife R 96 Löt Male Connector R 96 Solder | |
| B | 15.02.2010 | www.ERNI.com | | 374001 | |
| Index | Date | | | I A3 | |
| | | | | Class | STVR |