



## PRODUCT CHANGE NOTIFICATION

**PRODUCT CHANGE NOTIFICATION NUMBER:** PC000017

**PCN DATE:** August 1, 2022

This notice is to inform you about the following changes to the listed Stewart Connector products. For any further questions about these changes, please contact your Stewart Connector sales contact, or customer service representative.

**PARTS AFFECTED:**

All standard Stewart Connector part numbers produced in Stewart's North American manufacturing sites in Mexico and Pennsylvania

**GENERAL PRODUCT DESCRIPTION:**

Standard Stewart Connector product offering

**REASON FOR CHANGE:**

Updated label specification in-line with ECIA industry guidelines

**DESCRIPTION OF CHANGES:**

See attached file with details. This change will not affect the product in any way. The implementation will be handled as a running change so products labeled under the old specification will be shipped until inventory is depleted.

**ESTIMATED IMPLEMENTATION DATE:**

9/1/2022

**SIGNATURE:**

Derek Imschweiler  
General Manager  
Stewart Connector

11118 Susquehanna Trail South  
Glen Rock, PA  
17327, USA

T 717.235.7512  
[stewartconnector.com](http://stewartconnector.com)

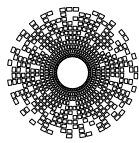

**stewart**  
CONNECTOR  
a bel group

1118 Susquehanna Trail South  
Glen Rock, PA 17327-9199  
(717) 235-7512

http://www.stewartconnector.com

**PRODUCT  
CHANGE  
NOTIFICATION**

DATE	REV
7-27-22	A0

PRODUCT CHANGE NOTIFICATION

OLD DESIGN

PART NUMBER

QUANTITY

COUNTRY OF ORIGIN

<b>Stewart Connector</b>		1118 Susquehanna Trail South Glen Rock, PA 17327-9199	
PN (P)		SS-37000-007	
QTY (Q)		5000	
One or more U.S. patents may apply to this product. For details, please visit: <a href="http://BELFUSE.COM/STEWART/STEWART_PATENTS/">HTTP://BELFUSE.COM/STEWART/STEWART_PATENTS/</a>			
W/O #	1234567890	Matl Lot #	12345
Desc :	UNIBODY PLUG W/CONTACTS	Date Code:	2135
ROI PN		SS-37000-007	
QTY	5000	DEPT	0000
STA	000	EMP	0000
TOOL	0	MOLD	000
MADE IN USA		DATE PACKED 07/27/22	

DATE CODE

NEW DESIGN

PART NUMBER

DATE CODE

LOT CODE

COUNTRY OF ORIGIN

QUANTITY

(1P) Supplier Part Number: SS-37000-007			
(10D) Date Code: 2135		(4L) Country of Origin: CN	
(1T) Lot Code: N/T		(Q) Quantity: 5000	
<b>Stewart Connector</b>		1118 Susquehanna Trail South Glen Rock, PA 17327-9199	
Desc :	UNIBODY PLUG W/CONTACTS	STA	000
PN	SS-37000-007	TOOL	0
SHORT PN	SS-37000-007	DEPT	0000
WO #	1234567890	EMP	0000
DATE PACKED	07/27/22	MOLD	000
One or more U.S. patents may apply to this product. For details, please visit: <a href="http://BELFUSE.COM/STEWART/STEWART_PATENTS/">HTTP://BELFUSE.COM/STEWART/STEWART_PATENTS/</a>			

1. LABEL DESIGNED TO FOLLOW EIGP 114.2018 SPECIFICATION
2. MARKED INFORMATION HAS BEEN MOVED TO THE TOP WITH BARCODES AND TEXT
3. ROI PN WAS RENAMED TO SHORT PN
4. MATL LOT # WAS REMOVED
5. LOT CODE WAS ADDED AND WILL STATE N/T WHEN IT IS NOT TRACKED
6. 2D BARCODE WAS ADDED AND CONTAINS ALL BARCODE INFORMATION ON TOP HALF OF LABEL

SHEET 1 OF 1

THIS DRAWING AND THE SUBJECT MATTER SHOWN THEREON ARE CONFIDENTIAL AND THE PROPRIETARY PROPERTY OF STEWART CONNECTOR AND SHALL NOT BE REPRODUCED, COPIED, OR USED IN ANY MANNER WITHOUT PRIOR WRITTEN CONSENT OF STEWART CONNECTOR. ONE OR MORE U.S. PATENTS MAY APPLY TO THIS PRODUCT. FOR DETAILS, PLEASE VISIT: [HTTP://BELFUSE.COM/STEWART/STEWART\\_PATENTS/](http://BELFUSE.COM/STEWART/STEWART_PATENTS/)

THIRD ANGLE PROJECTION

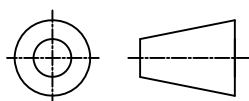

DIMENSIONS SHOWN ARE SUBJECT TO CHANGE WITHOUT NOTICE

DIMENSIONS: INCHES [METRIC]

UNLESS OTHERWISE SPECIFIED TOLERANCES ARE ±.005 [0.13] ANGLES ARE ± 1°

DRN BY: JMM

DATE 7-27-22

APPD BY: GWL

DATE 7-27-22

DWG NO. PC000017

REV. A0