

LOK6 LOCK OFF DEVICE

Instruction Manual



LOK6 is a lock off device for individual **Red Spot style** and other similar style fuse holder bases, after removal of the fuse carrier.

Many Red Spot style fuse holders, still in widespread use today, are made of brittle materials that can be fractured easily by the sharp grub screw found in many conventional MCB / Fuse lock-off devices.

The LOK6 uses an effective clamp system to grip the wall of the Red Spot style fuse holder base without risk of damage.

The clamp system accommodates wall thicknesses from 2mm to 5mm with ease.

The device is clamped adjacent to the terminal at one end of the fuse holder, rendering it safe against accidental finger access.

For added safety, the LOK6 includes an integral sliding cover which can be adjusted to reduce accidental finger access at the far end of the fuse holder base.

The sliding cover can be adjusted to suit Red Spot style fuse holder bases from 20A to 100A.

The LOK6 is quick to install without the need for any tools. The construction is all insulating plastic, without any metal parts, to reduce the risk of use in live working environments.

Material is tough flame-retardant blend of polycarbonate+ABS for high impact strength and long term durability.

The LOK6 can take a wide range of locking padlocks with wire shackles up to 7mm wire diameter.

For added safety, Martindale Electric recommends the insulated padlock PAD20R.

The overall head height is low after installation, making it possible to close most cabinet doors if desired.

Colour is bright yellow for easy identification.

Order code:

MARLOK6

Lock off device for Red Spot style fuse holder base.

Body colour – yellow

Recommended accessory:

MARPAD20R

Insulated body padlock with insulated nylon shackle.

Body colour – red.

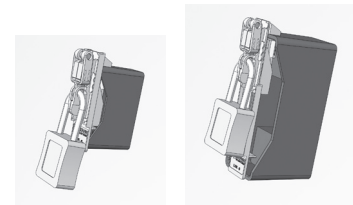

Suits Red Spot style fuse holder bases from 20A to 100A.

LOK6 INSTALLATION GUIDE

BEFORE INSTALLATION, conduct a RISK ASSESSMENT.
Wear appropriate PPE.
Remove the fuse carrier from the fuse holder base.

Open toggle
and unscrew to
open inner jaw.

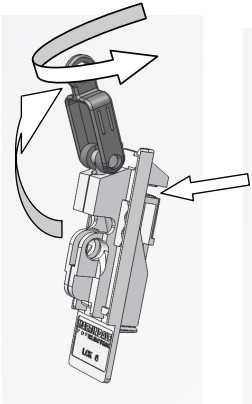

Place jaws centrally
over end wall of
fuse holder base.

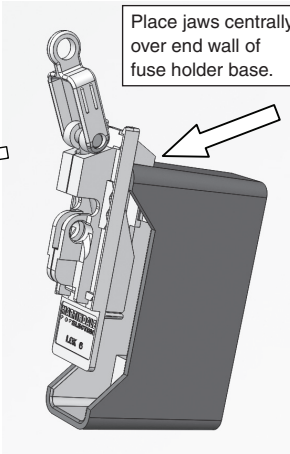

Tighten toggle,
finger-tight ONLY.

DO NOT
OVERTIGHTEN.

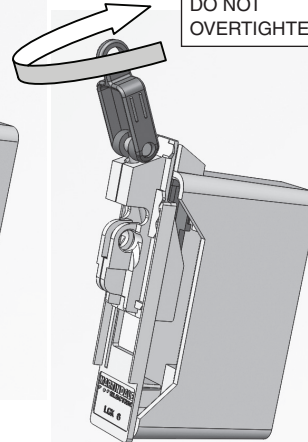

Close toggle.
Check that LOK6 is
secure.

Fit padlock and tag
as desired.

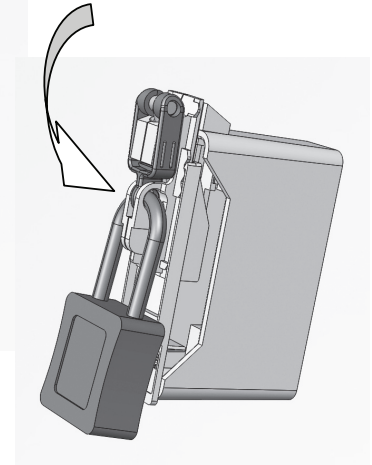

Adjust sliding cover to
suit overall length of
fuse holder base.

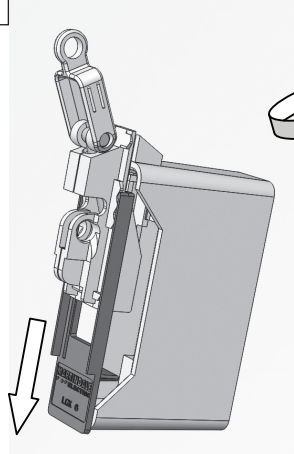

MARTINDALE
●●●ELECTRIC

Martindale Electric Company Limited
Metrohm House, Imperial Park, Imperial Way, Watford, Hertfordshire, WD24 4PP, UK
Tel: +44(0)1923 441717 Fax: +44 (0)1923 446900

E-mail: sales@martindale-electric.co.uk Website: www.martindale-electric.co.uk

© 2014 Martindale Electric Company Ltd. Registered in England No. 3387451. E. & O.E. Document Rev1 LITLOK6