

Crimp
Fittings

Press-
armaturen

Embouts
sertis

Raccordi a
graffare

Racores para
presión

Fittings qualified for GH180 suction hose / Qualifizierte Armaturen für den GH180 Saugschlauch

FL (3000 psi)

Split Flange Code 61
Flansch-Code 61
Bride code 61
Flangia codice 61
Brida-código 61

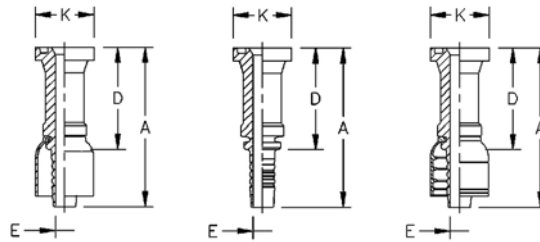

| Part Number | Part Number | Part Number | Thread T | Flange | Tube O.D. | ND | Hose Size | A | D | H | E Ø | HEX [1] | HEX [2] | K Ø |
|-------------|--------------|-------------|----------|--------|-----------|----|-----------|-------|------|----|------|---------|---------|------|
| OTC Fitting | Skive Nipple | TTC Fitting | | | | | | mm | mm | mm | mm | | | mm |
| 1G8FL8 | 1S8FL8 | 1A8FL8 | | 1/2" | | | -8 | 82,0 | 52,3 | | 9,6 | | | 30,2 |
| 1G12FL10 | 1S12FL10 | 1A12FL10 | | 3/4" | | | -10 | 82,7 | 53,3 | | 12,8 | | | 38,1 |
| 1G12FL12 | 1S12FL12 | 1A12FL12 | | 3/4" | | | -12 | 84,0 | 53,8 | | 15,5 | | | 38,1 |
| 1G16FL12 | 1S16FL12 | 1A16FL12 | | 1" | | | -12 | 84,0 | 53,8 | | 15,5 | | | 44,4 |
| 1G12FL16 | 1S12FL16 | 1A12FL16 | | 3/4" | | | -16 | 87,7 | 53,3 | | 20,7 | | | 38,1 |
| 1G16FL16 | 1S16FL16 | 1A16FL16 | | 1" | | | -16 | 88,8 | 54,4 | | 20,7 | | | 44,4 |
| 1G20FL16 | 1S20FL16 | 1A20FL16 | | 1 1/4" | | | -16 | 96,4 | 62,0 | | 20,7 | | | 50,8 |
| 1G20FL20 | 1S20FL20 | 1AP20FL20* | | 1 1/4" | | | -20 | 107,8 | 63,8 | | 26,6 | | | 50,8 |
| | | 1AT20FL20** | | 1 1/4" | | | -20 | 107,8 | 63,8 | | 26,6 | | | 50,8 |
| 1G24FL20 | 1S24FL20 | 1AP24FL20* | | 1 1/2" | | | -20 | 108,5 | 64,5 | | 26,6 | | | 60,3 |
| | | 1AT24FL20** | | 1 1/2" | | | -20 | 108,5 | 64,5 | | 26,6 | | | 60,3 |
| 1G20FL24 | 1S20FL24 | 1A20FL24 | | 1 1/4" | | | -24 | 112,0 | 65,7 | | 32,0 | | | 50,8 |
| 1G24FL24 | 1S24FL24 | 1A24FL24 | | 1 1/2" | | | -24 | 111,8 | 65,5 | | 32,0 | | | 60,3 |
| 1G32FL24 | 1S32FL24 | 1A32FL24 | | 2" | | | -24 | 111,8 | 65,5 | | 32,0 | | | 71,4 |
| 1G32FL32 | 1S32FL32 | 1A32FL32 | | 2" | | | -32 | 117,0 | 66,8 | | 44,4 | | | 71,4 |

Split Flange Code 61 / Flansch-Code 61 / Bride code 61 / Flangia codice 61 / Brida-código 61 acodado

| Part Number | Hose Size | ND | A | D | H | E | K | Split Flange |
|-------------|-----------|-----|-----|----|----|------|-------|--------------|
| | | | mm | mm | mm | mm | mm | |
| GH25092-40 | -40 | 63 | 128 | 38 | | 56,3 | 84,1 | G74446-40 |
| GH25092-48 | -48 | 76 | 150 | 57 | | 69,0 | 101,6 | G74446-48 |
| GH25092-64 | -64 | 102 | 165 | 75 | | 94,0 | 127,0 | G74446-64 |

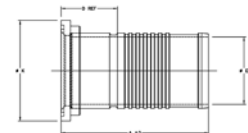

Split Flange Code 61, 45° Elbow / Flansch-Code 61, 45° Krümmer / Bride code 61, coudé 45° / Flangia codice 61 a 45° / Brida-código 61 acodado a 45°

| Part Number | Hose Size | ND | A | D | H | E | K | Split Flange |
|-------------|-----------|-----|-----|-----|----|------|-------|--------------|
| | | | mm | mm | mm | mm | mm | |
| GH25093-40 | -40 | 63 | 181 | 82 | 45 | 56,3 | 84,1 | G74446-40 |
| GH25093-48 | -48 | 76 | 213 | 102 | 53 | 69,0 | 101,6 | G74446-48 |
| GH25093-64 | -64 | 102 | 231 | 143 | 55 | 94,0 | 127,0 | G74446-64 |

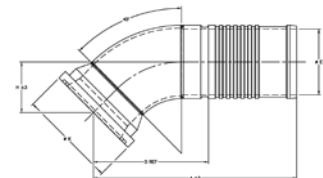

Split Flange Code 61, 90° Elbow / Flansch-Code 61, 90° Krümmer / Bride code 61, coudé 90° / Flangia codice 61 a 90° / Brida-código 61 acodado a 90°

| Part Number | Hose Size | ND | A | D | H | E | K | Split Flange |
|-------------|-----------|-----|-----|-----|-----|------|-------|--------------|
| | | | mm | mm | mm | mm | mm | |
| GH25094-40 | -40 | 63 | 181 | 91 | 110 | 56,3 | 84,1 | G74446-40 |
| GH25094-48 | -48 | 76 | 215 | 125 | 130 | 69,0 | 101,6 | G74446-48 |
| GH25094-64 | -64 | 102 | 253 | 163 | 160 | 94,0 | 127,0 | G74446-64 |

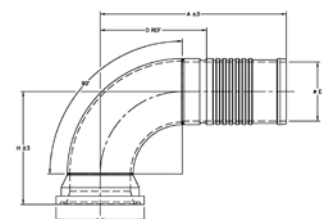

* 1-wire
** 2-wire

* 1-wire
** 2-wire

* 1-wire
** 2-wire

* 1-wire
** 2-wire

* 1-wire
** 2-wire

Specification subject to change without notice