



FUSELESS LOAD FEEDER DIRECT START, 400V AC, SIZE S0, 5.5...8A, 5.5KW, 24 V DC WITH DIODE COMBINATION INSERTED ON FRONT SIDE SCREW TERMINAL FOR MOUNTING ONTO DIN RAIL, TYPE OF COORDINATION 2, IQ = 150KA (ALSO FULFILLS TYPE OF COORDINATION 1) 1OE + 1NO (CONTACTOR)

Figure similar

|  |   |
|--|---|
| product brand name   | SIRIUS  |
| Product designation  | non-fused load feeders 3RA2   |
| <b>Manufacturer article number</b>   |   |
| <ul style="list-style-type: none"> <li>• of the supplied contactor</li> <li>• of the supplied circuit-breakers</li> <li>• of the supplied link module</li> </ul> | <a href="#">3RT2024-1FB40</a><br><a href="#">3RV2021-1HA10</a><br><a href="#">3RA2921-1BA00</a> |

### General technical data:

|  |    |            |
|--|----|------------|
| <b>Insulation voltage</b>  |    |            |
| <ul style="list-style-type: none"> <li>• with degree of pollution 3 Rated value</li> </ul> | V  | 690        |
| <b>Shock resistance</b>  |    |            |
| <ul style="list-style-type: none"> <li>• acc. to IEC 60068-2-27</li> </ul>                 |    | 6g / 11 ms |
| <b>Surge voltage resistance Rated value</b>  | kV | 6          |
| <b>Type of assignment</b>  |    | 2          |
| <b>Protection class IP</b>   |    |            |
| <ul style="list-style-type: none"> <li>• on the front</li> </ul>                           |    | IP20       |

### Main circuit:

|  |    |           |
|--|----|-----------|
| <b>Number of poles for main current circuit</b>  |    | 3         |
| <b>Adjustable response value current of the current-dependent overload release</b>                     | A  | 5.5 ... 8 |
| <b>Operating voltage</b>   |    |           |
| <ul style="list-style-type: none"> <li>• Rated value</li> <li>• at AC-3 Rated value maximum</li> </ul> | V  | 690       |
|  | V  | 690       |
| <b>Operating frequency Rated value</b>   | Hz | 50 ... 60 |
| <b>Operating current</b>   |    |           |
| <ul style="list-style-type: none"> <li>• at AC-3</li> </ul>  |    |           |

|                        |   |       |
|------------------------|---|-------|
| — at 400 V Rated value | A | 6.5   |
| <b>Operating power</b> |   |       |
| • at AC-3              |   |       |
| — at 400 V Rated value | W | 3 000 |
| — at 500 V Rated value | W | 4 000 |
| — at 690 V Rated value | W | 5 500 |

#### Control circuit/ Control:

|  |   |     |
|--|---|-----|
| <b>Control supply voltage for DC</b>           |   |     |
| • Rated value                                  | V | 24  |
| <b>Holding power of the magnet coil for DC</b> | W | 5.9 |

#### Auxiliary circuit:

|   |  |     |
|---|--|-----|
| <b>Product expansion Auxiliary switch</b> |  | Yes |
|---|--|-----|

#### Protective and monitoring functions:

|   |  |                      |
|---|--|----------------------|
| <b>Trip class</b>                             |  | CLASS 10             |
| <b>Design of the overload circuit breaker</b> |  | thermal (bimetallic) |

#### UL/CSA ratings:

|   |              |   |
|---|--------------|---|
| <b>Full-load current (FLA) for three-phase AC motor</b> |              |   |
| • at 480 V Rated value                                  | A            | 8 |
| <b>yielded mechanical performance [hp]</b>              |              |   |
| • for three-phase AC motor at 220/230 V Rated value     | metric<br>hp | 2 |
| • for three-phase AC motor at 460/480 V Rated value     | metric<br>hp | 5 |
| • for three-phase AC motor at 575/600 V Rated value     | metric<br>hp | 5 |

#### Short-circuit:

|  |   |          |
|--|---|----------|
| <b>Product function Short circuit protection</b>         |   | Yes      |
| <b>Design of the short-circuit trip</b>                  |   | magnetic |
| <b>Conditional short-circuit current (I<sub>q</sub>)</b> |   |          |
| • at 690 V acc. to IEC 60947-4-1 Rated value             | A | 4 000    |
| • at 400 V acc. to IEC 60947-4-1 Rated value             | A | 153 000  |
| • at 500 V acc. to IEC 60947-4-1 Rated value             | A | 42 000   |

#### Installation/ mounting/ dimensions:

|                          |    |  |
|--------------------------|----|--|
| <b>mounting position</b> |    | vertical   |
| <b>Mounting type</b>     |    | screw and snap-on mounting onto 35 mm standard mounting rail |
| <b>Height</b>            | mm | 193.1  |
| <b>Width</b>             | mm | 45   |
| <b>Depth</b>             | mm | 107  |
| <b>Required spacing</b>  |    |  |
| • for grounded parts     |    |  |

|                  |    |    |
|------------------|----|----|
| — forwards       | mm | 10 |
| — Backwards      | mm | 0  |
| — upwards        | mm | 30 |
| — at the side    | mm | 9  |
| — downwards      | mm | 10 |
| • for live parts |    |    |
| — forwards       | mm | 10 |
| — Backwards      | mm | 0  |
| — upwards        | mm | 30 |
| — downwards      | mm | 10 |
| — at the side    | mm | 9  |

#### Connections/ Terminals:

##### Type of electrical connection

- for main current circuit
- screw-type terminals

#### Safety related data:

**B10 value with high demand rate acc. to SN 31920** 1 000 000

##### Proportion of dangerous failures

- with high demand rate acc. to SN 31920
- % 73

**Protection against electrical shock** finger-safe

#### Mechanical data:

**Size of the circuit-breaker** S0

**Size of load feeder** S0

#### Ambient conditions:

##### Ambient temperature

- during operation °C -20 ... +60
- during storage °C -50 ... +80
- during transport °C -50 ... +80

#### Certificates/ approvals:

|                          |                                |                           |                   |
|--------------------------|--------------------------------|---------------------------|-------------------|
| General Product Approval | For use in hazardous locations | Declaration of Conformity | Shipping Approval |
|--------------------------|--------------------------------|---------------------------|-------------------|



|                   |       |  |  |
|-------------------|-------|--|--|
| Shipping Approval | other |  |  |
|-------------------|-------|--|--|



[Environmental Confirmations](#)

[Declaration of Conformity](#)

[other](#)

### Further information

**Information- and Downloadcenter (Catalogs, Brochures,...)**

<http://www.siemens.com/industrial-controls/catalogs>

**Industry Mall (Online ordering system)**

<http://www.siemens.com/industrymall>

**Cax online generator**

<http://support.automation.siemens.com/WW/CAXorder/default.aspx?lang=en&mfb=3RA21201HA240FB4>

**Service&Support (Manuals, Certificates, Characteristics, FAQs,...)**

<http://support.automation.siemens.com/WW/view/en/3RA21201HA240FB4/all>

**Image database (product images, 2D dimension drawings, 3D models, device circuit diagrams, EPLAN macros, ...)**

[http://www.automation.siemens.com/bilddb/cax\\_de.aspx?mfb=3RA21201HA240FB4&lang=en](http://www.automation.siemens.com/bilddb/cax_de.aspx?mfb=3RA21201HA240FB4&lang=en)

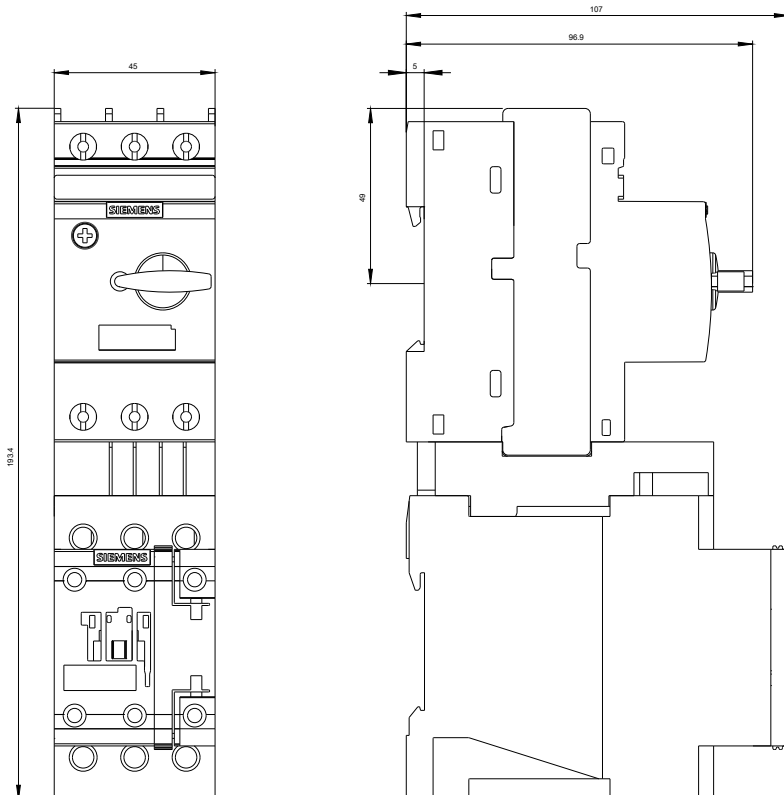

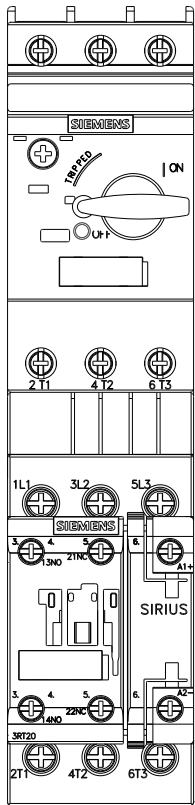

DIREKTANLEHRABZWEIG, SICHERUNGSL.

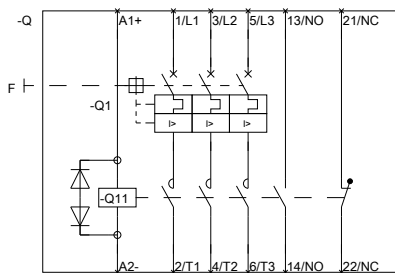

DIREKTANLEHRABZWEIG, SICHERUNGSL.

last modified:

11.03.2015