

268/F

G5

2A-500V

T130
Tm110



CE

IP20 LAMPHOLDER
— Polycarbonate body
— Copper alloy contacts

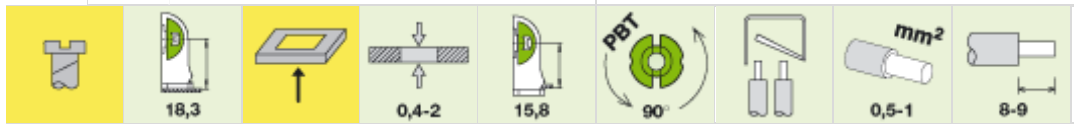
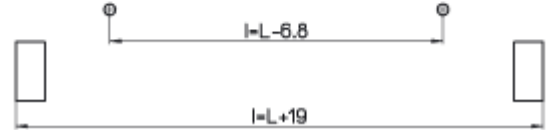
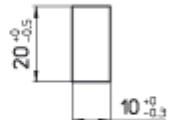
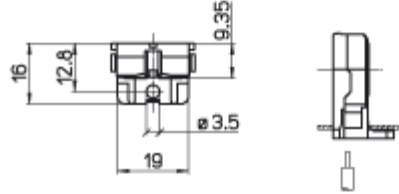
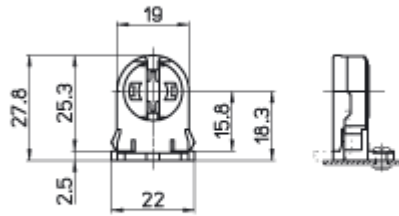

Legend

SCREW FIXING

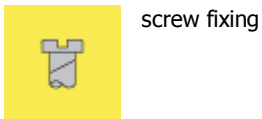

AUTOMATIC FIXING

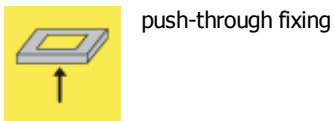

CHARACTERISTICS

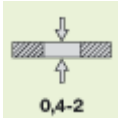

metal plate thickness



lamp centre height (from the bottom of the metal plate)



PBT green rotor with position of...

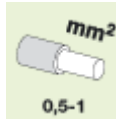

rigid conductor section

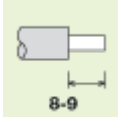

rigid wires stripping

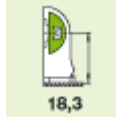

lamp centre height (from the top of the metal plate)

TERMINALS



push-wire terminals with 2 holes