



[HOME](#) | [ABOUT US](#) | [NEWS](#) | [CONTACT US](#)

Search By Part number

Check stock by region

[PRODUCTS](#)

[CUSTOM CAPABILITIES](#)

[PART BUILDER](#)

[GLOBAL DISTRIBUTION](#)

[ORDER ONLINE](#)

"Sturdi-Mount" PCB Screw Terminals

Vertical Type

30 AMP "Snap-In" PCB Mount Style

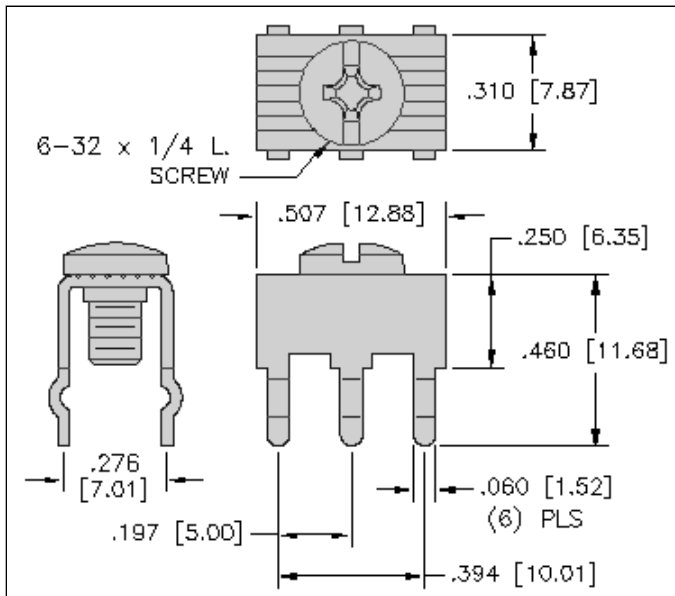

Mounting Detail

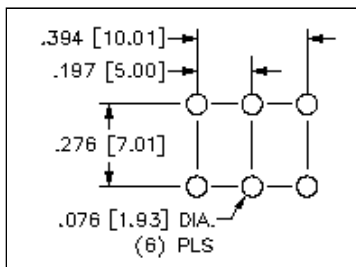

Cat. No.	Screw Supplied	Screw Color
7786	Less Screw	None
8197	Unassembled	None
8197-2	Unassembled	Red
8197-3	Unassembled	Black
8197-4	Unassembled	White
8197-5	Unassembled	Blue
8197-6	Unassembled	Green
8197-7	Unassembled	Yellow
8199	Installed & Captivated	None
8199-2	Installed & Captivated	Red
8199-3	Installed & Captivated	Black
8199-4	Installed & Captivated	White
8199-5	Installed & Captivated	Blue
8199-6	Installed & Captivated	Green
8199-7	Installed & Captivated	Yellow

Specifications

Rated: 30 Amps

Terminal: .032 [0,81mm] Thick
Brass, Tin Plate

Screw: Combination Binding Head - Brass, Nickel Plate Head of screw is painted with color as indicated in chart.

[Click to Request Samples](#)

[VIEW PRODUCT OVERVIEW](#)