

# SM/SMC-10

## 10mm carbon/cermet potentiometer



### Main features

- Available in Carbon (SM-10) and Cermet (SMC-10)
- Based on the PT-10 / PTC-10 series.
- Enclosed in plastic housing.
- Excellent low price control potentiometer.

Electrical specifications	SM-10	SMC-10
Range of values*	100Ω ≤ Rn ≤ 5 M (Decad. 1.0 - 2.0 - 2.2 - 2.5 - 4.7 - 5.0)	
Tolerance*	100Ω ≤ Rn ≤ 1M Ω ----- ± 20% 1MΩ < Rn ≤ 5M Ω ----- ± 30%	
Max. Voltage	200 VDC (lin) 100 VDC (no lin)	
Nominal Power	50°C (122°F) 0.15 W (lin) 0.07 W (no lin)	70°C (158°F) 0.33 W (lin) 0.17 W (no lin)
Taper*	Lin, Log, Alog (Log & Alog only Rn≥1k)	
Residual resistance*	≤0.5% Rn (5Ω min.)	
Equivalent noise resistance	≤ 3% Rn (3 Ω min.)	
Operating temperature	-25°C + 70°C** (-13°F + 158°F)	-40°C + 90°C (-40°F + 194°F)

(\*) Others upon request. No linear tapers; values higher than 1KΩ

(\*\*) Up to 85°C depending on application

### Mechanical specifications

Mechanical rotation angle	235° ± 5°
Electrical rotation angle	220° ± 20°
Torque	0.5 to 2.5 Ncm. (0.7 to 3.4 in-oz)
Stop torque	> 25 Ncm. (>35.5 in-oz)
Nut torque	> 80 Ncm. (>113.6 in-oz)
Mechanical life*	≥10K cycles

(\*) For Ohmic values ≥ 1 K Ω. Lower values upon request

## Common dimensions

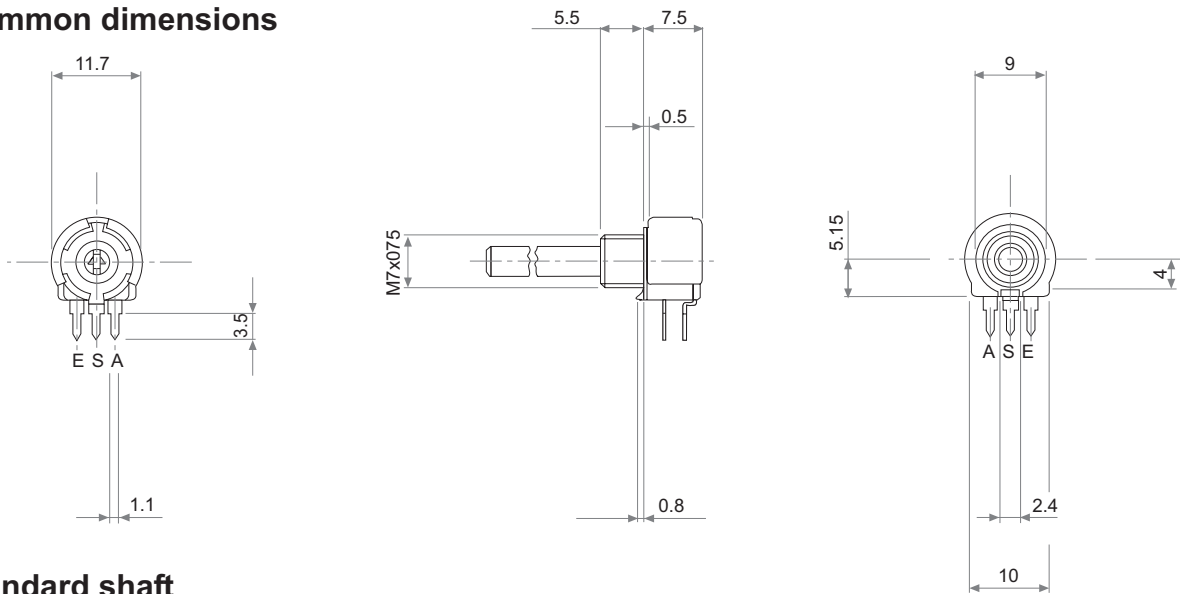

## Standard shaft

The standard option is E4 L30 black colour.

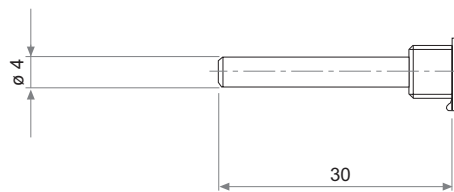

## Terminals

### NOT CRIMPED

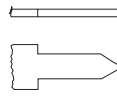
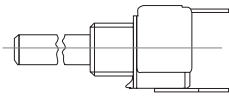

### CRIMPED

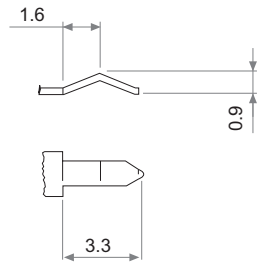
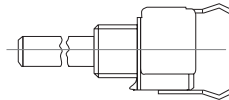

## Mounting method

### h 2.5

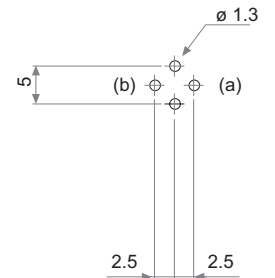
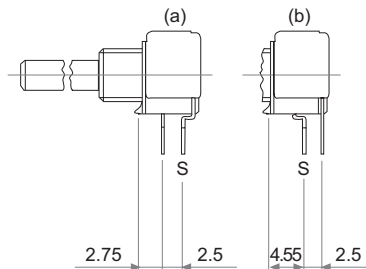
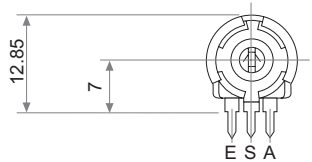

### h 5

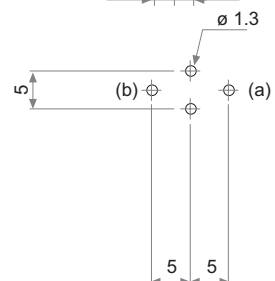
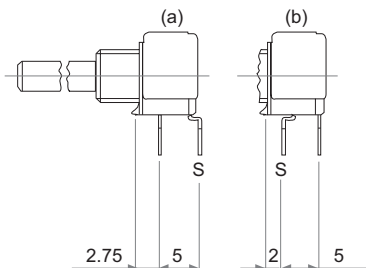
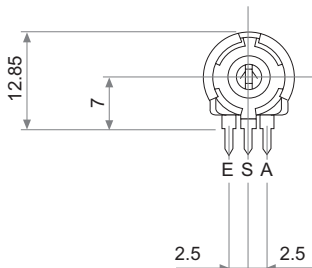

### v 10

