

GN 822.7 | Mini indexing plungers

With or without rest in retracted position, stainless steel



1 **THREADED BODY**
AISI 303 stainless steel.



2 **PLUNGER**
AISI 303 stainless steel.



3 **SPRING**
AISI 301 stainless steel.



4 **STANDARD EXECUTIONS**
Polyamide based (PA) technopolymer knob, black colour, matte finish:
- **GN 822.7-B**: without rest position.
- **GN 822.7-C**: rest position by pulling and turning the knob to 30 °.
AISI 305 stainless steel knob, matte finish:
- **GN 822.7-BN**: without rest position.
- **GN 822.7-CN**: rest position by pulling and turning the knob to 30 °.



7 **FEATURES AND APPLICATIONS**
GN 822.7 mini indexing plungers are particularly suitable for assembly on thin sheets.



By lifting the knob, the flat faces of the hexagon come out making it possible to screw the threaded body with a hexagonal spanner.



8 **ACCESSORIES ON REQUEST**
AISI 303 stainless steel distance bushings GN 609.5 (see page 906) for the assembly of the indexing plunger on thin sheets.

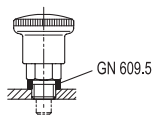

GN 822.7-B
GN 822.7-BN

GN 822.7-C
GN 822.7-CN

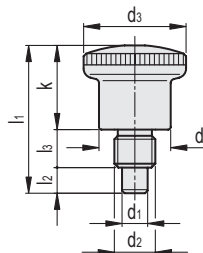
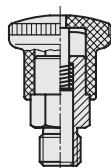
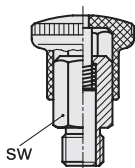
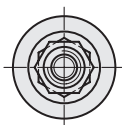
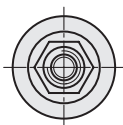



GN 822.7-B

INOX STAINLESS STEEL

Code	Description	d1 Plunger h9 Hole +0.08 +0.03	d2	d3	d4	k	l1	l2	l3	sw	Spring preload [N]	Spring max load [N]	⚖️
GN.36501	GN 822.7-4-M8x1-B	4	M8x1	21	15	16.5	27.5	5	6	10	4	12	14
GN.36506	GN 822.7-5-M10x1-B	5	M10x1	25	18	20	34	6	8	12	6	16	25
GN.36511	GN 822.7-6-M10x1-B	6	M10x1	25	18	20	34	6	8	12	6	16	25
GN.36515	GN 822.7-6-M12x1.5-B	6	M12x1.5	28	20	23.5	40.5	7	10	14	10	23	30
GN.36521	GN 822.7-7-M12x1.5-B	7	M12x1.5	28	20	23.5	40.5	7	10	14	10	23	30
GN.36526	GN 822.7-8-M16x1.5-B	8	M16x1.5	33	23	25.5	47.5	10	12	17	11	35	67
GN.36531	GN 822.7-10-M16x1.5-B	10	M16x1.5	33	23	25.5	47.5	10	12	17	11	35	70

GN 822.7-C

INOX STAINLESS STEEL

Code	Description	d1 Plunger h9 Hole +0.08 +0.03	d2	d3	d4	k	l1	l2	l3	sw	Spring preload [N]	Spring max load [N]	⚖️
GN.36503	GN 822.7-4-M8x1-C	4	M8x1	21	15	16.5	27.5	5	6	10	4	12	14
GN.36507	GN 822.7-5-M10x1-C	5	M10x1	25	18	20	34	6	8	12	6	16	24
GN.36513	GN 822.7-6-M10x1-C	6	M10x1	25	18	20	34	6	8	12	6	16	24
GN.36517	GN 822.7-6-M12x1.5-C	6	M12x1.5	28	20	23.5	40.5	7	10	14	10	23	29
GN.36522	GN 822.7-7-M12x1.5-C	7	M12x1.5	28	20	23.5	40.5	7	10	14	10	23	29
GN.36527	GN 822.7-8-M16x1.5-C	8	M16x1.5	33	23	25.5	47.5	10	12	17	11	35	65
GN.36532	GN 822.7-10-M16x1.5-C	10	M16x1.5	33	23	25.5	47.5	10	12	17	11	35	67

GN 822.7-BN

INOX STAINLESS STEEL

Code	Description	d1 Plunger h9 Hole +0.08 +0.03	d2	d3	d4	k	l1	l2	l3	sw	Spring preload [N]	Spring max load [N]	⚖️
GN.36502	GN 822.7-4-M8X1-BN	4	M8x1	21	15	16.5	27.5	5	6	10	4	12	28
GN.36508	GN 822.7-5-M10X1-BN	5	M10x1	25	18	20	34	6	8	12	6	16	49
GN.36512	GN 822.7-6-M10X1-BN	6	M10x1	25	18	20	34	6	8	12	6	16	50
GN.36516	GN 822.7-6-M12X1,5-BN	6	M12x1.5	28	20	23.5	40.5	7	10	14	10	23	74
GN.36523	GN 822.7-7-M12X1,5-BN	7	M12x1.5	28	20	23.5	40.5	7	10	14	10	23	75
GN.36528	GN 822.7-8-M16X1,5-BN	8	M16x1.5	33	23	25.5	47.5	10	12	17	11	35	113
GN.36533	GN 822.7-10-M16X1,5-BN	10	M16x1.5	33	23	25.5	47.5	10	12	17	11	35	115

GN 822.7-CN

INOX STAINLESS STEEL

Code	Description	d1 Plunger h9 Hole +0.08 +0.03	d2	d3	d4	k	l1	l2	l3	sw	Spring preload [N]	Spring max load [N]	⚖️
GN.36504	GN 822.7-4-M8X1-CN	4	M8x1	21	15	16.5	27.5	5	6	10	4	12	27
GN.36509	GN 822.7-5-M10X1-CN	5	M10x1	25	18	20	34	6	8	12	6	16	48
GN.36514	GN 822.7-6-M10X1-CN	6	M10x1	25	18	20	34	6	8	12	6	16	49
GN.36518	GN 822.7-6-M12X1,5-CN	6	M12x1.5	28	20	23.5	40.5	7	10	14	10	23	73
GN.36524	GN 822.7-7-M12X1,5-CN	7	M12x1.5	28	20	23.5	40.5	7	10	14	10	23	74
GN.36529	GN 822.7-8-M16X1,5-CN	8	M16x1.5	33	23	25.5	47.5	10	12	17	11	35	111
GN.36534	GN 822.7-10-M16X1,5-CN	10	M16x1.5	33	23	25.5	47.5	10	12	17	11	35	113