

GN 609.5 | Distance bushings

Stainless steel



- 1
- 2
- 3
- 4
- 5
- 6
- 7
- 8
- 9
- 10
- 11
- 12
- 13
- 14
- 15
- 16
- 17
- 18

MATERIAL

AISI 303 stainless steel.

FEATURES AND APPLICATIONS

GN 609.5 distance bushings are generally used to compensate for the length of the thread of the body on the indexing plungers, allowing mounting on sheets of variable thickness.

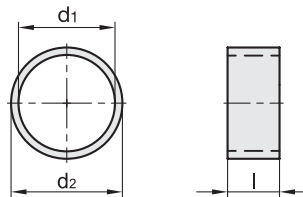
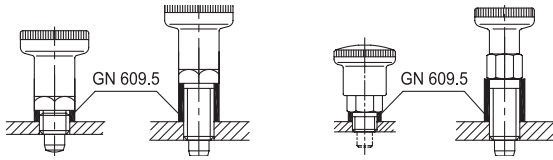

Code	Description	d1	H12	d2	l±0.1	Thread of indexing plungers	GN 414	GN 514	GN 607 GN 607.1	GN 617 GN 617.1 GN 617.2	GN 717	GN 817 GN 817.2	GN 816 GN 816.1	GN 822	GN 7336.8	△	
GN.70201	GN 609.5-6-7-2	6	7	2		M6	-	-	-	-	•	-	-	-	-	-	1
GN.70202	GN 609.5-6-7-4	6	7	4		M6	-	-	-	-	•	-	-	-	-	-	1
GN.70203	GN 609.5-6-7-6	6	7	6		M6	-	-	-	-	•	-	-	-	-	-	1
GN.70204	GN 609.5-6-7-8	6	7	8		M6	-	-	-	-	•	-	-	-	-	-	1
GN.70211	GN 609.5-8-10-2	8	10	2		M8	-	-	-	-	•	•	-	•	-	-	1
GN.70212	GN 609.5-8-10-3	8	10	3		M8	-	-	-	-	•	•	-	•	-	-	1
GN.70213	GN 609.5-8-10-4	8	10	4		M8	-	-	-	-	•	•	-	•	-	-	1
GN.70214	GN 609.5-8-10-6	8	10	6		M8	-	-	-	-	•	•	-	•	-	-	1
GN.70215	GN 609.5-8-10-8	8	10	8		M8	-	-	-	-	•	•	-	•	-	-	2
GN.70216	GN 609.5-8-10-10	8	10	10		M8	-	-	-	-	•	•	-	•	-	-	2
GN.70221	GN 609.5-10-12-2	10	12	2		M10	-	-	-	•	•	•	-	•	-	-	1
GN.70222	GN 609.5-10-12-4	10	12	4		M10	-	-	-	•	•	•	-	•	-	-	1
GN.70223	GN 609.5-10-12-6	10	12	6		M10	-	-	-	•	•	•	-	•	-	-	2
GN.70224	GN 609.5-10-12-8	10	12	8		M10	-	-	-	•	•	•	-	•	-	-	2
GN.70225	GN 609.5-10-12-10	10	12	10		M10	-	-	-	•	•	•	-	•	-	-	3
GN.70226	GN 609.5-10-12-12	10	12	12		M10	-	-	-	•	•	•	-	•	-	-	3

Machine elements

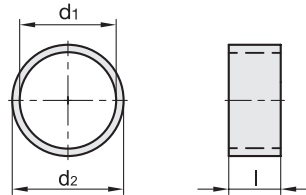

INOX STAINLESS STEEL

Code	Description	d1	H12	d2	l±0.1	Thread of indexing plungers	GN 617										⚖
							GN 414	GN 514	GN 607 GN 607.1	GN 617.1 GN 617.2	GN 717	GN 817 GN 817.2	GN 816 GN 816.1	GN 822	GN 7336.8		
GN.70231	GN 609.5-12-14-2	12	14	2	M12	-	-	-	•	•	•	•	-	-	1		
GN.70232	GN 609.5-12-14-4	12	14	4	M12	-	-	-	•	•	•	•	-	-	1		
GN.70233	GN 609.5-12-14-6	12	14	6	M12	-	-	-	•	•	•	•	-	-	2		
GN.70234	GN 609.5-12-14-8	12	14	8	M12	-	-	-	•	•	•	•	-	-	2		
GN.70235	GN 609.5-12-14-10	12	14	10	M12	-	-	-	•	•	•	•	-	-	3		
GN.70236	GN 609.5-12-14-12	12	14	12	M12	-	-	-	•	•	•	•	-	-	3		
GN.70237	GN 609.5-12-14-14	12	14	14	M12	-	-	-	•	•	•	•	-	-	4		
GN.70238	GN 609.5-12-17-2	12	17	2	M12	•	-	•	-	-	-	-	-	-	2		
GN.70239	GN 609.5-12-17-4	12	17	4	M12	•	-	•	-	-	-	-	-	-	3		
GN.70240	GN 609.5-12-17-5	12	17	5	M12	•	-	•	-	-	-	-	-	-	3		
GN.70241	GN 609.5-12-17-6	12	17	6	M12	•	-	•	-	-	-	-	-	-	4		
GN.70242	GN 609.5-12-17-8	12	17	8	M12	•	-	•	-	-	-	-	-	-	5		
GN.70243	GN 609.5-12-17-10	12	17	10	M12	•	-	•	-	-	-	-	-	-	6		
GN.70244	GN 609.5-12-17-12	12	17	12	M12	•	-	•	-	-	-	-	-	-	7		
GN.70251	GN 609.5-16-17-2	16	17	2	M16	-	•	-	-	•	•	-	-	-	1		
GN.70252	GN 609.5-16-17-4	16	17	4	M16	-	•	-	-	•	•	-	-	-	1		
GN.70253	GN 609.5-16-17-6	16	17	6	M16	-	•	-	-	•	•	-	-	-	1		
GN.70254	GN 609.5-16-17-8	16	17	8	M16	-	•	-	-	•	•	-	-	-	1		
GN.70255	GN 609.5-16-17-10	16	17	10	M16	-	•	-	-	•	•	-	-	-	2		
GN.70256	GN 609.5-16-17-12	16	17	12	M16	-	•	-	-	•	•	-	-	-	2		
GN.70257	GN 609.5-16-19-2	16	19	2	M16	•	-	-	•	-	-	-	-	•	1		
GN.70258	GN 609.5-16-19-4	16	19	4	M16	•	-	-	•	-	-	-	-	•	2		
GN.70259	GN 609.5-16-19-6	16	19	6	M16	•	-	-	•	-	-	-	-	•	4		
GN.70260	GN 609.5-16-19-8	16	19	8	M16	•	-	-	•	-	-	-	-	•	5		
GN.70261	GN 609.5-16-19-10	16	19	10	M16	•	-	-	•	-	-	-	-	•	6		
GN.70262	GN 609.5-16-19-12	16	19	12	M16	•	-	-	•	-	-	-	-	•	7		
GN.70271	GN 609.5-20-22-6	20	22	6	M20	-	-	-	•	-	•	-	-	-	5		
GN.70272	GN 609.5-20-22-8	20	22	8	M20	-	-	-	•	-	•	-	-	-	5		
GN.70273	GN 609.5-20-22-10	20	22	10	M20	-	-	-	•	-	•	-	-	-	6		
GN.70274	GN 609.5-20-22-12	20	22	12	M20	-	-	-	•	-	•	-	-	-	6		
GN.70275	GN 609.5-20-22-14	20	22	14	M20	-	-	-	•	-	•	-	-	-	7		
GN.70276	GN 609.5-20-22-16	20	22	16	M20	-	-	-	•	-	•	-	-	-	7		
GN.70277	GN 609.5-20-22-18	20	22	18	M20	-	-	-	•	-	•	-	-	-	8		



Machine elements