



Main Feature

- 1. 2-Pole and 4-Pole version are available with switching current at 5 Amps (2 Poles & 4 Poles).
2. Printed Circuit Board Terminal, Solder Lug Terminal and Flanged Case are designed for direct panel mounting use.
3. Low coil power consumption with high response time.
4. High reliability and long life with better vibration and shock resistance.
5. Touch Button and LED version are available for customer’s selection.

Application :

Vending Machine, Cooking Appliances, Office Machine, Domestic Appliances, Control Equipment, etc.

Contact Rating :

- Nominal Load (Resistive Load Cos φ =1)
Contact Capacity .....2 P: 5A at 250VAC.
5A at 30VDC.
4 P: 5A at 250VAC
5A at 30VDC.
Rated Carrying Current .....5 Amps.
Max. Allowable Current .....5 Amps.
Max. Allowable Voltage .....AC 250V, DC 110V.
Max. Allowable Power Force.600VA, 150W.
Min. Switching Load .....DC 10V, 10mA.
■ Contact Material .....Ag Alloy.
■ Contact Form.....DPDT & FPDT.
DPST & FPST.

- Max. On/Off Switching :
Electrical..... 30 Ops per Minute.
Mechanical..... 240 Ops per Minute.
■ Temperature Range ..... -25~55°C
■ Humidity Range..... 45~85% RH.
■ Coil Temperature Rise..... 60°C Max.
■ Vibration :
Endurance ..... 10 to 55 Hz dual
amplitude width 1.5mm.
Error Operation ..... 10 to 55 Hz dual
amplitude width 1.5mm.
■ Shock :
Endurance ..... 1,000 m/S² Min.
Error Operation ..... 100 m/S² Min.
■ Life Expectancy :
Mechanical ..... 10⁷ Operations at No
Load condition.
Electrical ..... 10⁵ Operations at Rated
Resistive Load.
■ Weight ..... About 35 g.

Performance (at Initial Value)

- Contact Resistance .....100 mΩ Max@1A,6VDC
■ Operate Time .....25 mSec. Max.
■ Release Time .....25 mSec. Max.
■ Dielectric Strength :
Between Coil & Contact .....1,500VAC at 50/60 Hz
for one minute.
Between Contacts .....1,000VAC at 50/60 Hz
for one minute.
■ Surge Resistance .....3,000V (between Coil
& Contact 1.2x50µSec.)
■ Insulation Resistance.....100 MegaΩ Min. at
500VDC.

Safety Standard & Its File Number :

- C-UL..... E141060.

**Coil Specification (at 20°C)**

| Coil Sensitivity           | Coil Voltage Code | Nominal Voltage (VDC) | Nominal Current (mA) |           | Coil Resistance ( $\Omega \pm 10\%$ ) | Power Consumption        | Pull-In Voltage (VDC) | Drop-Out Voltage (VDC) | Max. Allowable Voltage (VDC) |
|----------------------------|-------------------|-----------------------|----------------------|-----------|---------------------------------------|--------------------------|-----------------------|------------------------|------------------------------|
|                            |                   |                       | 50 Hz                | 60 Hz     |                                       |                          |                       |                        |                              |
| RE<br>2-P & 4-P<br>AC Coil | 01                | 6                     | 282.67               | 214.33    | 10                                    | Abt. 1.0 to 1.3VA (60Hz) | 80%<br>Maximum        | 30%<br>Minimum         | 110%                         |
|                            | 02                | 12                    | 106.20               | 94.85     | 40                                    |                          |                       |                        |                              |
|                            | 03                | 24                    | 52.80                | 45.45     | 160                                   |                          |                       |                        |                              |
|                            | 04                | 48                    | 23.65                | 19.95     | 600                                   |                          |                       |                        |                              |
|                            | 05                | 110                   | 12.45                | 10.25     | 3,400                                 |                          |                       |                        |                              |
|                            | 06                | 120                   | 16.75                | 14.33     | 3,400                                 |                          |                       |                        |                              |
|                            | 07/08             | 220/240               | 6.18/7.24            | 5.08/5.85 | 13,600                                |                          |                       |                        |                              |
| RE<br>2-P & 4-P<br>DC Coil | 01                | 6                     | 150                  |           | 40                                    | Abt. 0.9 W               | 80%<br>Maximum        | 10%<br>Minimum         | 110%                         |
|                            | 02                | 12                    | 75                   |           | 160                                   |                          |                       |                        |                              |
|                            | 03                | 24                    | 36.9                 |           | 650                                   |                          |                       |                        |                              |
|                            | 04                | 48                    | 18.5                 |           | 2,600                                 |                          |                       |                        |                              |
|                            | 05                | 110                   | 10                   |           | 11,000                                |                          |                       |                        |                              |
|                            | 06                | 120                   | 10.9                 |           | 11,000                                |                          |                       |                        |                              |

**Ordering Information:**

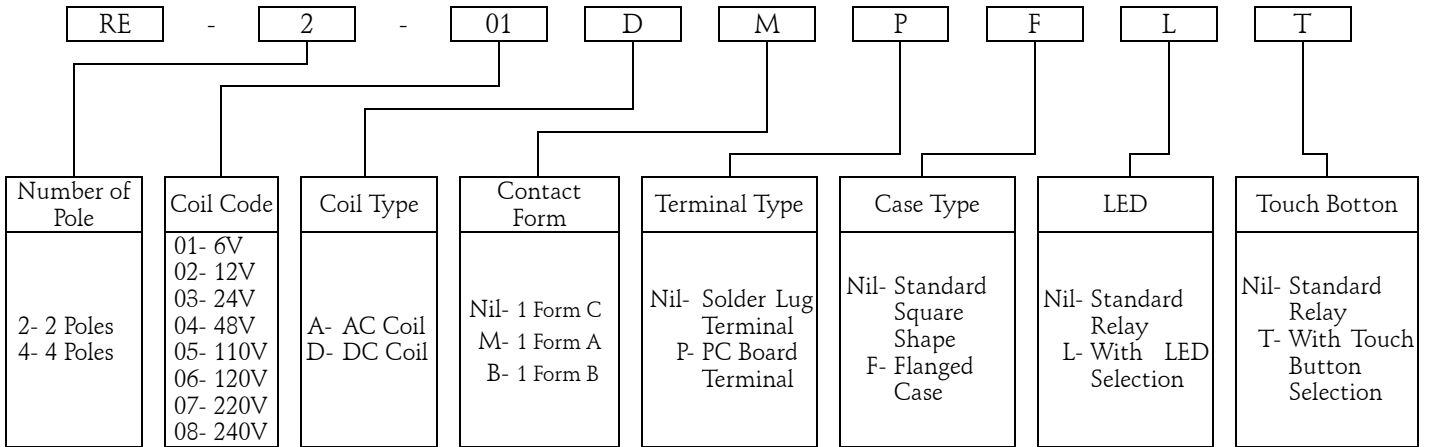

## Dimension:

RE-2-P

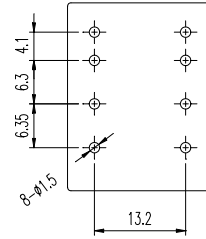
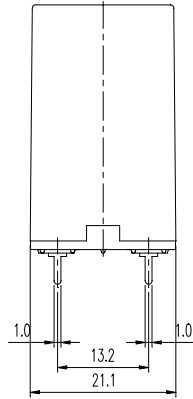
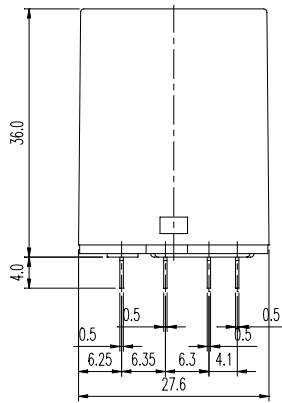

BOTTOM VIEW

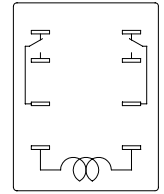

BOTTOM VIEW

RE-2

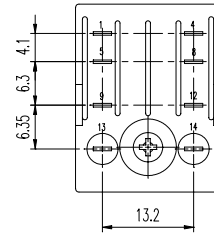
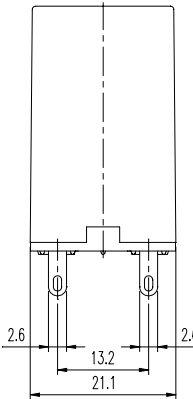
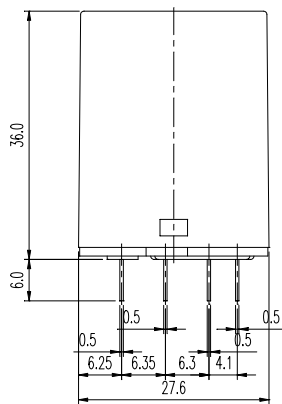

BOTTOM VIEW

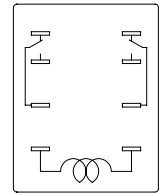

BOTTOM VIEW

RE-4-P

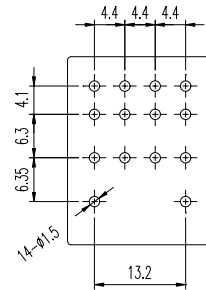
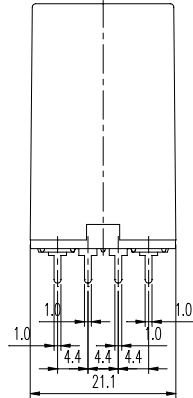
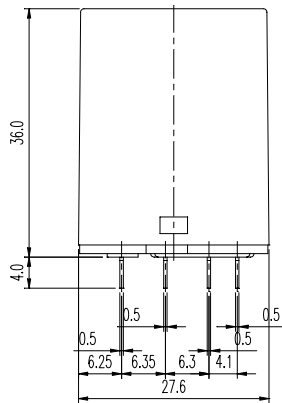

BOTTOM VIEW

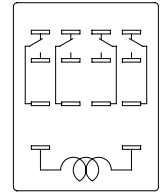

BOTTOM VIEW

RE-4

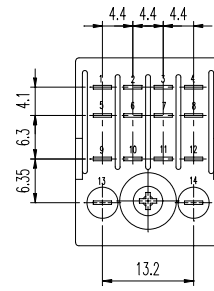
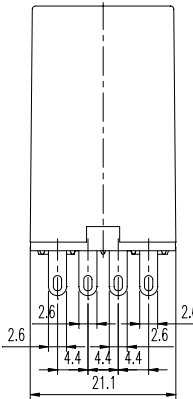
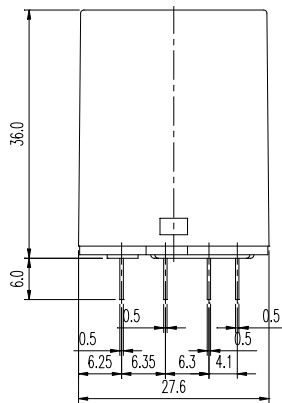

BOTTOM VIEW

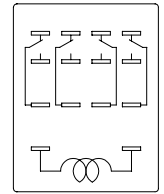

BOTTOM VIEW

RE-2-F

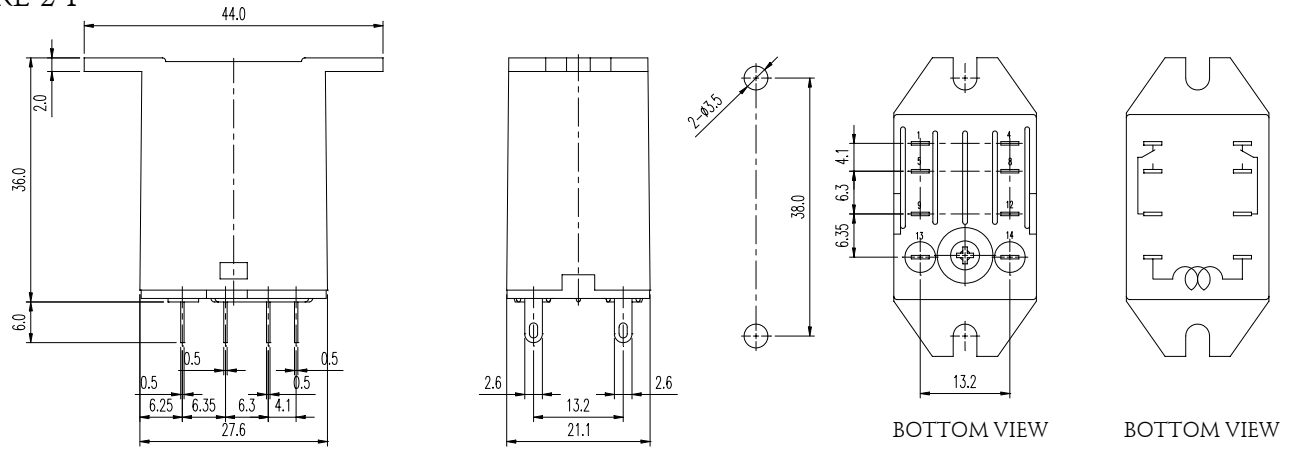

RE-4-F

