

## External Pipe/ Internal Pipe

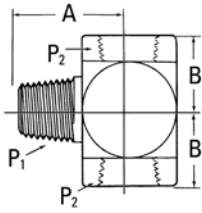

## Internal Pipe/ Internal Pipe

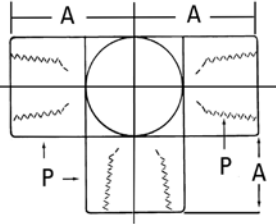

## External Pipe/ Internal Pipe

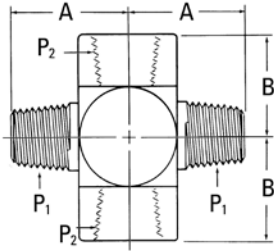

## External Pipe/ Internal Pipe

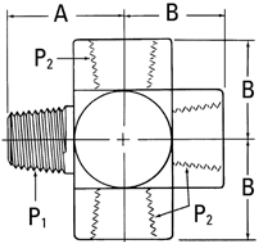

## Internal Pipe/ Internal Pipe

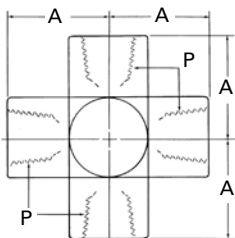

## Part No. 2091-(Dash size) (Ref. SAE 140425)

Dash Size	Thread P1	Thread P2	A		B	
			mm	in	mm	in
2-2S	1/8-27	1/8-27	19,8	0.78	16,8	0.66
4-4S	1/4-18	1/4-18	27,7	1.09	22,3	0.88
6-6S	3/8-18	3/8-18	31,0	1.22	25,9	1.02
8-8S	1/2-14	1/2-14	37,3	1.47	31,2	1.23
12-12S	3/4-14	3/4-14	40,4	1.59	34,5	1.36
16-16S	1-11 1/2	1-11 1/2	50,0	1.97	41,1	1.62

Also available in stainless steel as part no. 259-2091.  
See pg. 278 for more information.

## Part No. 2090-(Dash size) (Ref. SAE 140438)

Dash Size	Thread P	A	
		mm	in
2-2S	1/8-27	16,8	0.66
4-4S	1/4-18	22,3	0.88
6-6S	3/8-18	25,9	1.02
8-8S	1/2-14	31,2	1.23
12-12S	3/4-14	34,5	1.36
16-16S	1-11 1/2	41,1	1.62
20-20S	1 1/4-11 1/2	43,2	1.70
24-24S	1 1/2-11 1/2	52,8	2.08

Also available in stainless steel as part no. 259-2090.  
See pg. 278 for more information.

## Part No. 208006-(Dash size)

Dash Size	Thread P1	Thread P2	A		B	
			mm	in	mm	in
4-4S	1/4-18	1/4-18	29,5	1.16	22,3	0.88
6-6S	3/8-18	3/8-18	33,0	1.30	25,9	1.02
20-20S	1 1/4-11 1/2	1 1/4-11 1/2	67,3	2.65	3,2	1.70

## Part No. 208007-(Dash size)

Dash Size	Thread P1	Thread P2	A		B	
			mm	in	mm	in
4-4S	1/4-18	1/4-18	29,5	1.16	22,3	0.88
6-6S	3/8-18	3/8-18	33,0	1.30	25,9	1.02
8-8S	1/2-14	1/2-14	41,4	1.63	31,2	1.23
12-12S	3/4-14	3/4-14	43,9	1.73	34,5	1.36

## Part No. 2080-(Dash size)

Dash Size	Thread P	A	
		mm	in
2-2S	1/8-27	16,8	0.66
4-4S	1/4-18	22,3	0.88
6-6S	3/8-18	25,9	1.02
8-8S	1/2-14	31,2	1.23
12-12S	3/4-14	34,5	1.36
16-16S	1-11 1/2	41,1	1.62