

E11890

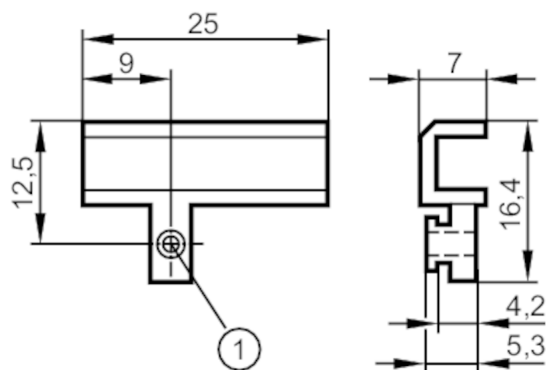

Mounting adapter for SMC pneumatic cylinders

ADAPT FOR CYL SMC ECDQ2



1 Mounting screw SW 1.5

Application

Design T-slot rail, flat, for types, MKT

Mechanical data

Weight [g] 3.7
Type of mounting for series: SMC ECDQ2
Dimensions [mm] 16.4 x 25 x 7
Materials aluminium; screw: stainless steel

Remarks

Pack quantity 1 pcs.