

# TECHNICAL DATA SHEET

**PRO-SIGNAL**

RoHS  
Compliant

## 10mm Diffused LEDs



Part No.	Pack Size	Colour	Wave Length at IF = 20mA			Forward Voltage (VF) at IF =20mA		Luminous Intensity at IF = 20mA	
			Min.	Typ.	Max.	Min.	Max.	Min.	Max.
PSG91888	10	Red	620nm		630nm	1.9V	2.1V	600mcd	800mcd
PSG91889		Green	568nm		570nm	2V	2.2V	80mcd	100mcd
PSG91890		Pure Green	520nm		525nm	3V	3.2V	2000mcd	3000mcd
PSG91891		Yellow	588nm		592nm	1.9V	2.1V	600mcd	800mcd
PSG91892		Blue	455nm		465nm	3V	3.2V	600mcd	800mcd
PSG91893		Warm White	2700k		3000k	3V	3.2V	2000mcd	3000mcd
PSG91894		Cool White	6500k		7000k	3V	3.2V	2000mcd	3000mcd
PSG91895	50	Red	620nm		630nm	1.9V	2.1V	600mcd	800mcd
PSG91896		Green	568nm		570nm	2V	2.2V	80mcd	100mcd
PSG91897		Pure Green	520nm		525nm	3V	3.2V	2000mcd	3000mcd
PSG91898		Yellow	588nm		592nm	1.9V	2.1V	600mcd	800mcd
PSG91899		Blue	455nm		465nm	3V	3.2V	600mcd	800mcd
PSG91900		Warm White	2700k		3000k	3V	3.2V	2000mcd	3000mcd
PSG91901		Cool White	6500k		7000k	3V	3.2V	2000mcd	3000mcd

**Important Notice:** This data sheet and its contents (the "Information") belong to pro-SIGNAL. No licence is granted for the use of it other than for information purposes in connection with the products to which it relates. No licence of any intellectual property rights is granted. The Information is subject to change without notice and replaces all data sheets previously supplied. The Information supplied is believed to be accurate but pro-SIGNAL assumes no responsibility for its accuracy or completeness, any error in or omission from it or for any use made of it. Users of this data sheet should check for themselves the Information and the suitability of the products for their purpose and not make any assumptions based on information included or omitted. Liability for loss or damage resulting from any reliance on the Information or use of it (including liability resulting from negligence or where pro-SIGNAL was aware of the possibility of such loss or damage arising) is excluded. This will not operate to limit or restrict pro-SIGNAL's liability for death or personal injury resulting from its negligence.

**PRO-SIGNAL**

# TECHNICAL DATA SHEET

**PRO-SIGNAL**

RoHS  
Compliant

Cont.

Part No.	Pack Size	Colour	Viewing Angle	Max. Power Dissipation	Max. Forward Current (IFM)	Recommended Operating Forward Current	Reverse Voltage
PSG91888	10	Red	110° - 120°	120mW	30mA	15mA to 18mA	5V
PSG91889		Green	30°				
PSG91890		Pure Green	110° - 120°				
PSG91891		Yellow	110° - 120°				
PSG91892		Blue	110° - 120°				
PSG91893		Warm White	110° - 120°				
PSG91894		Cool White	110° - 120°				
PSG91895	50	Red	110° - 120°				
PSG91896		Green	30°				
PSG91897		Pure Green	110° - 120°				
PSG91898		Yellow	110° - 120°				
PSG91899		Blue	110° - 120°				
PSG91900		Warm White	110° - 120°				
PSG91901		Cool White	110° - 120°				

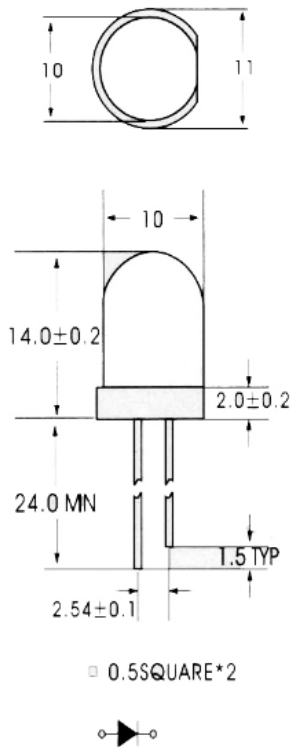

**Important Notice:** This data sheet and its contents (the "Information") belong to pro-SIGNAL. No licence is granted for the use of it other than for information purposes in connection with the products to which it relates. No licence of any intellectual property rights is granted. The Information is subject to change without notice and replaces all data sheets previously supplied. The Information supplied is believed to be accurate but pro-SIGNAL assumes no responsibility for its accuracy or completeness, any error in or omission from it or for any use made of it. Users of this data sheet should check for themselves the Information and the suitability of the products for their purpose and not make any assumptions based on information included or omitted. Liability for loss or damage resulting from any reliance on the Information or use of it (including liability resulting from negligence or where pro-SIGNAL was aware of the possibility of such loss or damage arising) is excluded. This will not operate to limit or restrict pro-SIGNAL's liability for death or personal injury resulting from its negligence.

**PRO-SIGNAL**