

D-Sub

TECHNICAL SPECIFICATIONS

Materials:

Unshielded Hood: UL-recognised plastic material
 Colour: Black

Shielded Hood: UL-recognised plastic material
 Plating: Nickel over Copper

Operating Temperature: -30°C to +110°C

Jackscrews: UNC 4-40 (Standard)

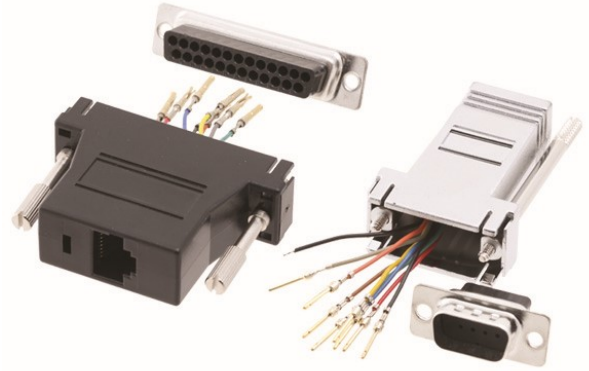

Features:

- Suitable for sizes 9, 15, 25
- Snap-Lock system
- Available in EMI-shielded and unshielded version
- Delivered complete with wires and Sub-D
- Re-openable
- Also available in Unshielded version
- Pre-wired connectors on request
- Also available without wire kit + connector

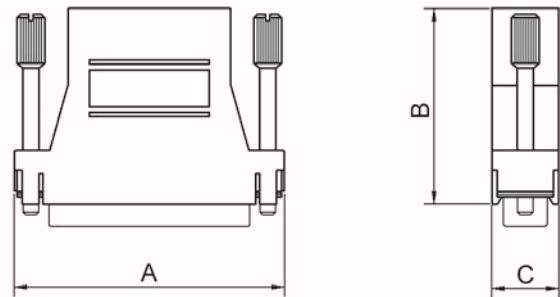

Size DA	Dim A	Dim B	Dim C
9-way	33,0	15,0	49,5
15-way	41,3	15,0	39,0
25-way	55,1	15,0	39,0

Ordering information:

Unshielded Version

Size:	P/N - Kitted:	Product Code:
9-way	2112-0100-01	DA09-SMJ6-K-RC
25-way	2112-0100-03	DA25-SMJ6-K-RC
9-way	2112-0100-11	DA09-PMJ6-K-RC
25-way	2112-0100-13	DA25-PMJ6-K-RC
9-way	2112-0101-01	DA09-SMJ8-K-RC
25-way	2112-0101-03	DA25-SMJ8-K-RC
9-way	2112-0101-11	DA09-PMJ8-K-RC
25-way	2112-0101-13	DA25-PMJ8-K-RC

Ordering information:

Shielded Version

Size:	P/N - Kitted:	Product Code:
9-way	2112-0105-01	DA09-SMJ8-M-K-RC
25-way	2112-0105-03	DA25-SMJ8-M-K-RC
9-way	2112-0105-11	DA09-PMJ8-M-K-RC
25-way	2112-0105-13	DA25-PMJ8-M-K-RC

SMJ6 = Sub-D Female to RJ11

PMJ6 = Sub-D Male to RJ11

SMJ8 = Sub-D Female to RJ45

PMJ8 = Sub-D Male to RJ45

