

FRC5 RELAY

FEATURES

Replacement Relay

Fuse design (Blade fuse)

30A Contact Rating

High temperature design

Ideal for use in control car

Quick connect terminal



SPECIFICATIONS

COIL RATING

RATED VOLTAGE (V DC)	COIL RESISTANCE Ω +/- 10 %	RATED CURRENT (mA)	MUST OPERATE VOLTAGE	MUST DROPOUT VOLTAGE	MAXIMUM VOLTAGE	POWER CONSUMPTION
			% OF RATED VOLTAGE (At +20 °C)			
12	80	150	65 Max.	10 Min.	130 Max.	1.8W (Approx.)

CHARACTERISTICS

Contact Arrangement	SPST (1 FORM A)
Contact Material	Silver Alloy
Contact Resistance	50m Ω Max.
Contact Rating (Resistive Load)	"B" Type : 30A/ 14VDC
Switching Voltage	DC 75V
Operate Time (Initial)	7ms Max. Typical
Release Time (Initial)	5 ms Max. Typical
Insulation Resistance	100M Ω Min. (500V DC)
Dielectric Strength	500Vrms between coil and contact
Shock Resistance	20g Approx.
Vibration Resistance	10 - 40Hz, Double Amplitude 1.5mm
Ambient Temperature	-40°C to +85°C
Humidity	85% R.H. at +40°C
Operation Life	Mechanical : 10^7 Electrical : 10^5 (At rated load)
Weight	30g Approx.

[Specifications are subject to change without notices.]

FRC5 RELAY

ORDERING INFORMATION

FRC5 B A DC 12V

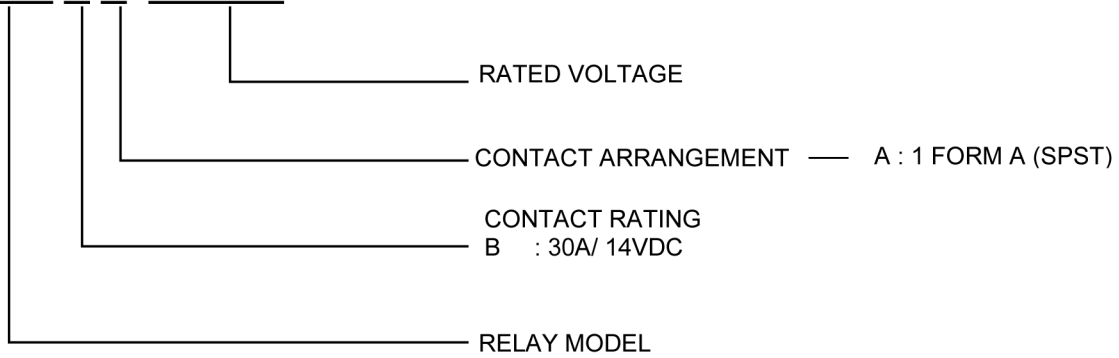

Note : Pb-Free and RoHS compliant relays are available.

DIMENSIONS (UNIT : mm)

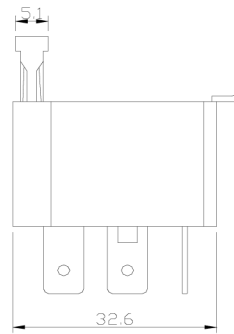
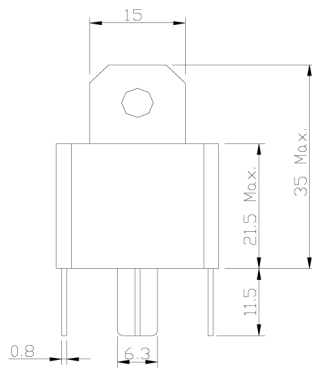

TOP SURFACE VIEW

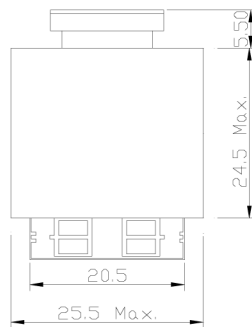

BLADE FUSE

