

1700 & 1750 Lever Switches 16A 250Vac Single and Double Pole



16(4)A 250Vac T85



UL 20A 250Vac Non Ind (Single pole)
 UL 16A 250Vac Non Ind (Double pole)
 UL CSA (2 pos types) 250Vac 1hp, 125Vac 1/2hp
 UL CSA (3 pos types) 250Vac 1/2hp, 125Vac 1/4hp
 CSA 16A 250Vac Non Ind
 UL 85°C, file E45221, CSA file LR10990
 UL and CSA N/A on momentary types

In house test

Inrush 36A to EN61058-1 & 20A 28Vdc

Selective "A, B, C" and "Off, A, A+B" circuits at 5 amp also available
 3mm contact gap except where marked μ
 Technical data on pages 4 & 5

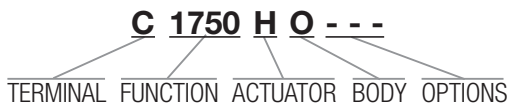

▶	TERMINAL	FUNCTION		▶	ACTUATOR
C	<p>6.3 x 0.8 9.1</p>	Single pole 	Double pole 	H	<p>16.4</p>
		1700 ♦ <p>ON - OFF</p>	1750 		
H	<p>4.8 x 0.8 9.1</p>	1710 μ ♦ <p>ON - ON</p>	1760 μ 		
K	<p>2.0 9.1 1.2 2.8 x 0.8</p>	1720 μ ♦ <p>ON - OFF - ON</p>	1770 μ 	R	<p>13.8</p>
T	<p>0.21 7.0 Solder</p>	1721 μ <p>ON - OFF - ON (momentary 1 side)</p>			
X	<p>4.0 9.1 PCB 0.8 Sq</p>	1722 μ <p>ON - OFF - ON (momentary 2 sides)</p>			The switch is on between centre terminals (2 & 5) and the terminals over which the lever is positioned



C1700RO ---



C1700HO ---



C1760RO ---



C1750HO ---

BODY

0
Single pole

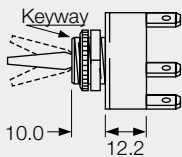

0
Double pole

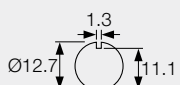
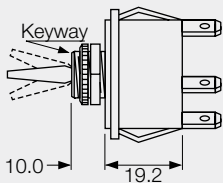

Panel hole (all types)

Panel thickness (Max)
Both nuts - 3.5mm
Less backnut - 6.5mm

OPTIONS

Neck Seal M539
Rubber -57T145
(H & R Actuators)
Actuator visible



Cover M1080
Rubber -57T145
(R Actuator only)



Cover M331
PVC -5T85
(R Actuator only)



Covers have internal nylon nuts

Fixing nuts (Standard is M506 & T92)

T5 Hex brass
M506 Hex nylon

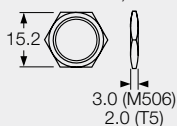

T92 Knurled brass

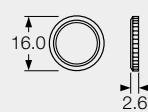

M279 Knurled nylon

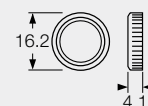

DIMENSIONS (mm)

Single Pole

(C terminals shown)

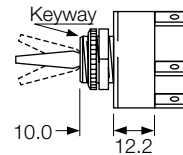
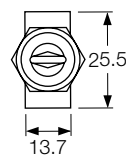

Optional
P232 plate
SP or DP

Double Pole

(C terminals shown)

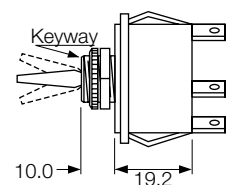
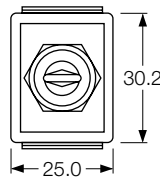

Optional terminal barrier M441 is available

Technical Information - Switches and Fuseholders

Most major technical information is shown on each specific product page, other details are grouped here for easy reference. Details shown here apply to most switches and fuseholders.

Snap-action switches (pages 42, 45 and 48-51), indicators (pages 66-78) and connectors (pages 79-81) have product specific information within the section.

MATERIALS	MOST PRODUCTS	EXCEPTIONS
Body and actuator (opaque)	Nylon 6.6	8300V, 1900V, 0916V & 0911V bezels & actuators are stainless steel 0600 and 3900 actuators are plated brass
Actuator (transparent)	Polycarbonate	
Current carrying parts	Copper Alloy	
Contact points	Silver Alloy	N/A for 0055/56, 0600/2, 0916-0920, 0017, 2000 & 3005/3006. Gold plated for 1100.

PROPERTIES

Electrical

Class II compliant	Confirmed	IEC Sockets
Electrical life (Operations)	>10k, many >50k	See relevant page for details
Contact resistance (switches) new condition	<100m Ω (at 12Vdc, 1A)	For 1100 & 2000 call factory
Contact resistance (fuseholders) new condition5m Ω (average)	
Insulation resistance	>20m Ω	
Dielectric strength:		
across open contacts	>1kV	
between poles	>3kV	
between live parts and accessible metal	>4kV	
Comparative Tracking Index (CTI)	>250	
Temperature rise (terminals) at end of rated life	max 30°K (UL 1054), max 55°K (EN 61058-1)	

PROPERTIES

Physical

Humidity resistance at 91-95% relative humidity (to subsequently comply with requirements of the Dielectric strength test)	48hrs	
Impact resistance	>0.5Nm	
Storage temp. (1 year period)	<125°C	Some discolouration of terminals may occur
Flame retardancy	UL94V2	
Solderability to BS 2011 pt.2.1T - (with an iron)6 secs at 350°C	
Angular movement \pm 4° overall (where applicable)38°	1250, 6000, 8500, 8550, 8600, 8650, 8800 - 26°
Force to operate2.0N - 20.0N	Call factory for specific values
Fixing nut torque (where applicable)1.0Nm (8.91 lb/in) nom.	Call factory for specific values

GENERAL INFORMATION

ALL SWITCHES

Heat and Fire resistance Category D.
Ingress Protection without cover is IP40.
Higher ratings where available will be shown on the relevant catalogue page.

ALL PRODUCTS

Solder terminals should not be fitted with "Push on", "QD" or "Fast on" type cable connectors.

Panel holes must be punched in the direction of insertion.

Items marked ♦ on the following pages are assembled automatically.
This ensures the highest attainable quality at a competitive price.

All products should be applied, installed and maintained by the customer using competent persons in accordance with good electrical practice. Products should be tested by the customer in the application to ensure suitability. Special care should be taken not to expose switches to water, dust, corrosive chemicals, silicone, excessive solder flux, cyanoacrylate adhesives, severe impact, extremes of temperature, electrical supply voltage or load current in excess of the specified limits.

Transparent lenses on indicator lights and lit switches are moulded in polycarbonate, a material which is attacked by organic chemicals and animal or vegetable fats.

Please contact the factory for advice on these products.

For performance in accord with the stated ratings, switch actuators should be fully depressed and fully released during operation.

WEIGHTS OF OUR MOST FREQUENTLY SUPPLIED PRODUCTS, not including packaging.

Product	gms	Product	gms	Product	gms	Product	gms	Product	gms
0055, 0056	5.7/6.8	1048	2.8	1570	12.7	5500	7.1	8353	5.9
0305	32.9	1091FH	12.6	1584-1589	11.1	5503	7.8	8500	3.8
0333	4.5	1091FL	52.8	1700H	8.4	5567	14.3	8550	4.8
0345	8.9	1100	2.0	1750H	13.2	6050	13.58	8553	5.2
0340 sw only	7.12	1250SP	5.9	17500	25.6	6053	14.15	8600	3.5
0340K/P	25.0	1250DP	7.0	2000 2pos C SP	3.8	7000	10.4	8620	4.3
0430	5.5	1300	5.7	2000 2pos C DP	4.5	7050	12.3	8650	6.3
0589	3.5	1350	11.2	2000 5pos A SP	6.3	7053	12.9	8670	8.5
0711-1S	16.6	1500	5.7	2000 5pos A DP	7.3	8250	4.9	8800	2.9
0712-S	27.8	1520	6.6	T2225B	5.0	8300	4.0	9100	20.0
0717-1S	22.4	1550	11.2	2950	5.3	8350	5.0		
0900S/L	2.6/2.9	1553	11.8	3111	11.8	8350RP	34.0		